

VEIRTICO

Available standard colours for the slat CD 77



ALULUX
 ROLLER SHUTTERS •
 ROLLER DOORS • GRILLES



**Available special colours, at extra charge

Due to printing process, the colours shown here might differ from the original colours. Please ask for individual advice.

NOW BRAND-NEW:
VEIRTICO
 Aluminium-Lateral-running door



Your Alulux system specialist:

www.garagedoorsonline.co.uk

01926 832000

VEIRTICO

THE ELEGANT ALUMINIUM-LATERAL-RUNNING DOOR



Vertico doors are made according to the new EU standards.

VERTICO

The Vertico lateral-running door is an exceptional solution to close garage door openings in an intelligent way. Vertico impresses by its elegance, a minimum of space requirement in the driving area and very smooth running.

Your neighbours will be really amazed after the professional installation of this convenient trademarked Vertico garage door.

A real exceptional version for people demanding for individuality and design.



Vertico is made according to the new EU security standards.

The standard equipment of Vertico-doors is: motor drive, radio remote control and electronic hindrance stop. These features meet all convenience and security demands.

Two programmable door openings enable the garage owner to open the door partly or completely.

The Vertico-door is made precisely to the customer's measures and demands, without extra charge, and it is available in 10 standard colours.



A very special advantage is the individually programmable partial opening. Vertico meets demands for small openings and big openings as well.



Standard radio remote control

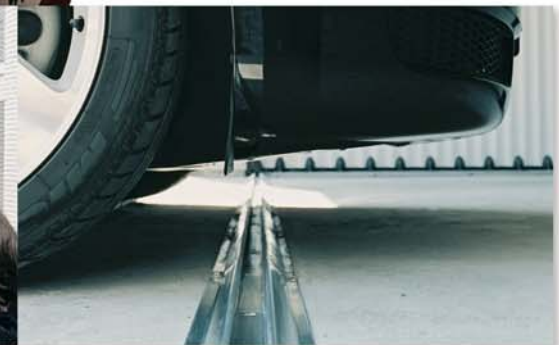

Ground guide rail 25 mm flat



Automatic hindrance detection

The standard equipment of Vertico includes radio remote control and electronic hindrance stop.



Quality and ecology go hand in hand

The CFC-free, insulating foamfilled aluminium design slat CD 77 with a surface area of 78.5 mm.



Standard equipment

- ✓ wide range of use.
Suitable for up to 560 cm clear width
- ✓ needs only 5 cm lintel in the drive area
- ✓ only 13 cm degree of lock.
Thus space saving at the lateral wall area
- ✓ superior surface stability
- ✓ possibility of partial opening
- ✓ made precisely to customer's measures,
without extra charge
- ✓ quiet running door due to fastening
straps on both sides and circulating
roller bearing
- ✓ the motor guide channel is integrated
elegantly in the wall guide channel
- ✓ complete trademarked door system
made of the high-quality material
aluminium
- ✓ no colour abrasion on the slat surface,
due to vertical door running



Vertico is made according to the new EU standards

- ✓ standard equipment with radio remote control, motor drive and electronic hindrance stop
- ✓ the door does not swing out, thus no parking space is lost in front of the garage
- ✓ the door will be professionally installed by the Vertico-specialist within approx. 3 hours
- ✓ made according to EU standards. This means absolute security with operation
- ✓ double locking (at the top and at the bottom) when operating the door without motor drive
- ✓ standard emergency unlocking from inside
- ✓ 10 standard colours available
- Available at extra charge:
 - ✓ Emergency unlocking from outside
 - ✓ Door status indicator with current saving control device
 - ✓ 36 different Renolit-colours



Only 13 cm degree of lock

The ground rail is connected by a precised degree of lock. This technique requires only 13 cm lateral space.



Lateral end rail

When closing the Vertico lateral-running door the first extruded slat dips deeply into the lateral closing guide channel.



Exclusive motor guide channel

The motor guide channel is integrated elegantly in the wall guide channel. The upper rollers guarantee a smooth running.



High-quality electric radio motor drive

Technique up to date, mature reliability. With 868 MHz frequency.



Drive height can be reduced to 5 cm

The well-devised technique of the new Vertico system in the lintel area requires no more than 5 cm space in the driving area.



Good illumination inside the garage

When entering the garage a lamp, integrated in the motor, lights up. Motor with 868 MHz frequency.



Colours for every taste

The door is available in 10 standard colours and in 36 Renolit special colours at extra charge. The option of the colour-design package can meet nearly all demands of the garage owners.



Smoother running, optimum surface stability

The rollers with slide bearing guarantee smoother running and stability against wind pressure. A door with distinguished surface stability.

VERTICO



Vertico is made according to the new EU standards.



The new Vertico model with a well-devised technique in every detail.

- 1 The wall guide channel and the opening guide channel are connected by a precised degree of lock made of aluminium pressure diecasting. Of course high-quality powder coated.
- 2 Optimum use of the garage due to the minimum degree of lock of 13 cm

- 3 The motor guide channel is integrated elegantly in the wall guide channel. The upper rollers guarantee a smooth running.
- 4 The powerful radio motor drive with its convenient programming guarantees a smooth run of the Vertico door.

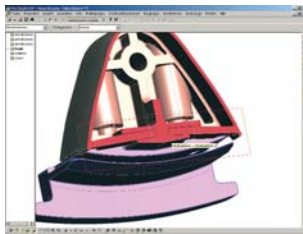
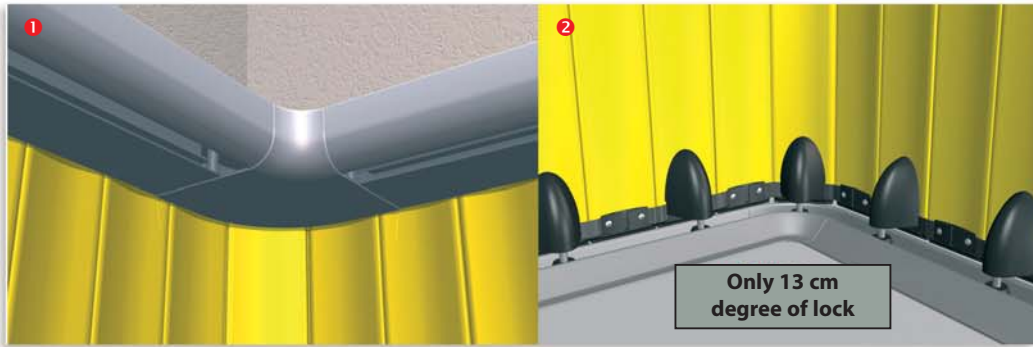

Intelligent Development

The guiding side lockings are prescribing the direction. Every detail well-devised and then developed for practising.

Hard Shell

The guiding side lockings are protected by special hard-PVC caps from damaging.

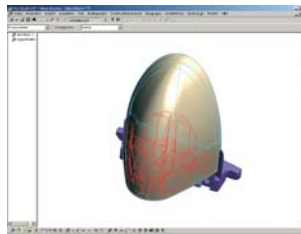

Emergency unlocking from inside

Standard equipment of each door

Perfectly closed

When closing the Vertico-door the first slat dips deeply into the lateral closing guide channel.

