



# Function Doors for Your Home

Multi-purpose door with thermal break MZ Thermo65







## CONTENT

6	Good Reasons to Try Hörmann
10	Security Door KSI Thermo46
12	Security Door KSI 40
14	Multi-Purpose Door MZ Thermo46 / MZ Thermo65
16	Multi-Purpose Door MZ
18	Fire-Rated Door H8-5
20	Multi-Function Door H3D
22	Fire-Rated Security Door WAT 40
24	Internal Door ZK
27	Colours and Decor Surfaces
28	Steel Frames
30	Size Range
32	Dimensional References
35	Wall Connections
36	Timber Internal Doors
38	Programme Overview

The colours and surface finishes shown are subject to the limitations of the printing process and cannot be regarded as binding.

All rights reserved. No part may be reproduced without our prior permission.  
Subject to changes.

\* Up to 49 % better thermal insulation for the MZ Thermo65 compared to a conventional multi-purpose door

Products on title page (from left): fire-rated door H8-5 in Grey white RAL 9002, external security door KSI Thermo46 in Anthracite RAL 7016, internal door ZK in Anthracite RAL 7016.

◀ Multi-function door H3D painted on site in Anthracite RAL 7016

# The right door for every room – your comfort is guaranteed

Whether it is a new construction or modernisation, Hörmann offers the right door for every area of the house: security doors for basement or garage entrances, fire-retarding doors for the boiler room and multi-purpose doors for your hobby room – our high-quality steel doors make sure that you feel safe and at ease in your own home. Discover all the advantages and functions of our steel doors and individual design possibilities on the following pages.

The classification of the individual doors shows you at a glance which functions the respective door fulfils and to what extent – from highly suitable (★★★★★ / 5 stars) to unsuitable (no stars).







“A good reputation must be earned.”

August Hörmann

In keeping with the tradition started by the company's founder, the name Hörmann delivers brand name quality with extensive product expertise. The family business has over 80 years of experience as a construction component specialist and sees itself as your partner from the very beginning of building and renovation projects. It's no surprise that Hörmann is one of Europe's most successful door providers. This makes a Hörmann door a reassuring purchase.



## 1 Quality products from Germany

All doors are developed and manufactured by Hörmann. Our highly qualified employees work intensively on new products, continual further developments and improvements to details. Patents and unique products on the market are the result of this. Endurance tests under real conditions ensure mature series products with Hörmann quality.





## 2 Doors for generations

We are convinced of our products and our uncompromising quality assurance.

**That is why you will enjoy a Hörmann function door in your house for many years.**

## 3 An eye on the future

Hörmann is setting a good example. This is why the company obtains 100 % of its required energy from green sources. At the same time, many tonnes of CO<sub>2</sub> are saved each year thanks to the introduction of an intelligent and certified energy management system. And last but not least, Hörmann offers products for sustainable construction.



## 4 Up to 49 % improved thermal insulation

You are looking for basement and side doors with the same thermal insulation as your entrance door? Then our security door KSI Thermo46 and multi-function doors MZ Thermo46 and MZ Thermo65 are the right choice for you: the MZ Thermo65 provides up to 49 % better thermal insulation than conventional multi-purpose doors.

Further information can be found on pages 10 / 11 or 14 / 15.

## 5 Break-in-resistant RC 2 security equipment

Security doors KSI 40/ KSI Thermo46 and fire-rated security door WAT 40 are available with approved, break-in-resistant RC 2 security equipment as standard. For you, this means: feeling even more secure in your own home. For multi-purpose door H3D, the equipment is optionally available as an additional function.







## 6 Individual designs

**Design your door exactly the way you want it, to your own individual taste.** You can choose between various colours and decors as well as glazings. Discover the design possibilities on pages 26 / 27.

## 7 Steel profile frame VarioFix

For the Hörmann steel profile frame VarioFix, wall tolerances of up to 20 mm are no problem: the adjustable decorative rebate easily compensates for different wall thicknesses during renovations and new construction projects. As easy to fit as a timber frame, the steel frame is additionally distinguished by its long service life and attractive design. **Only VarioFix offers high resistance and an elegant shape without visible foldback coupled with the fitting principle of timber frames.** Additional information about our frame types can be found on pages 28 / 29.

# KSI Thermo46

## High security and the best thermal insulation



The security door KSI Thermo46 offers many advantages: thanks to a door leaf with thermal break, it offers the best thermal insulation and also comes with break-in-resistant RC 2 security equipment. We recommend using this quality door as an external door for basements, outbuildings and garages.





## Product characteristics

### Break-in resistance

★★★★★

### Thermal insulation

★★★★★

### Acoustic insulation

★★

### Fire-retarding

### Stress

★★★★★

### Deformation resistance

★★★★★

### External door for

- Basements
- Heated outbuildings
- Garages with direct access to the house

### Ready-to-fit door set

Door leaf and frame with thermal break, galvanized and painted in Traffic white (similar to RAL 9016).

### Single-leaf

### Break-in-resistant RC 2

acc. to DIN EN 1627 on opposite hinge side

### Thermally insulated

$U_D = 1.1 \text{ W}/(\text{m}^2 \cdot \text{K})$



Colours and decor surfaces

Page 27

Size range

Page 30

### The same thermal insulation as with entrance doors

These days, saving energy is important throughout the entire home. The security door KSI Thermo46 provides excellent thermal insulation thanks to the door leaf filled with PU rigid foam; door leaf, frame and threshold all come with a thermal break. The door also features double seals on all four sides. With all of this, the KSI Thermo46 has a thermal insulation value usually only found in entrance doors.

### Security as standard

Basement and side doors are often weak spots when it comes to security. In this respect, the KSI Thermo46 offers the best equipment as well: 2 conical swing bolts and 2 additional security bolts and 1 lock bolt engage in the frame's lock plate and firmly pull the door shut. 3 further security bolts and 3 guide rollers on the hinge side make it practically impossible to force the door open.



The security door KSI Thermo46 features a 46 mm-thick door leaf and a very good thermal insulation value of up to  $1.1 \text{ W}/(\text{m}^2 \cdot \text{K})$ .



Three-way adjustable guide rollers for easy door function



Lock bolt for standard security



Swing bolt with security bolts



Security bolts on the hinge side

\* Up to 30 % better thermal insulation compared to a conventional security door

## KSI 40

### The proven classic for more security



Basement entrances, outbuildings and garages are often equipped with old doors that can be forced open in seconds. Always remember: if the basement door is open, the whole house is accessible. This is why we recommend the security door KSI 40 with standard security equipment for these areas.



## Product characteristics

### Break-in resistance

★ ★ ★ ★ ★

### Thermal insulation

★ ★ ★

### Acoustic insulation

★ ★

### Fire-retarding

### Stress

★ ★ ★ ★ ★

### Deformation resistance

★ ★ ★ ★ ★

### External door for

- Basements
- Unheated outbuildings
- Free-standing garages

### Ready-to-fit door set

Door leaf and frame, galvanized and with powder-coated primer in Traffic white (similar to RAL 9016).

### Single-leaf

### Break-in-resistant RC 2

acc. to DIN EN 1627 on hinge side and opposite hinge side

### Thermally insulated

$U_D = 1.7 \text{ W}/(\text{m}^2 \cdot \text{K})$

### Acoustic rating

with optional retractable bottom seal  
Rw approx. 32 dB

### Climatic class III

acc. to RAL-RG 426

### Duty category S

acc. to RAL-RG 426



Colours and decor surfaces

Page 27

Size range

Page 30

### Stable door leaf

The KSI 40 features a double-skinned, 40-mm-thick door leaf with 3-sided thick rebate and sheet steel on both sides (0.8 mm). The stability of the door leaf is a result of the all-round reinforcement frame and the mineral wool insert which is glued over the entire surface. A 3-sided EPDM seal and double lip seal (incl. aluminium semicircular threshold as a bottom edge) seal the door reliably. This means you can always rely on the door in terms of function and tightness. Hörmann offers this door as a complete set with frame.

### High security

The standard security of the KSI 40 lets you and your family sleep peacefully, as it comes with pull-off protection and a drill-resistant security lever/knob handle set. The solid steel bolts on the hinge side make it almost impossible to force the door open. The KSI 40 has been tested in accordance with European standard DIN EN 1627 on the hinge and opposite hinge side and has resistance class 2.



1.5-mm-thick corner frame with all-round seal

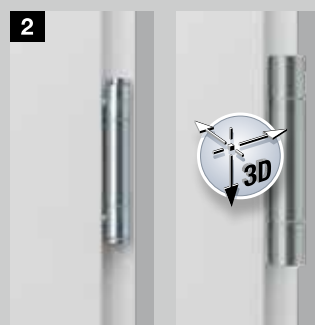

3-part hinge (standard)

Three-way adjustable VX hinge (on request)



Security lever/knob handle set with drill resistance and pull-off protection

Lock bolt for standard security



Solid steel security bolts on the hinge side

## MZ Thermo46 / MZ Thermo65 External door with thermal break and the best thermal insulation values



The multi-purpose doors are more than just extremely robust. Thanks to a thermal break, they feature up to 49 % better thermal insulation than conventional multi-purpose doors. They are available with or without glazing as well as in numerous colours and decor surfaces.



## Product characteristics

### Break-in resistance

★ ★

### Thermal insulation

★ ★ ★ ★ ★

### Acoustic insulation

★ ★

### Fire-retarding

### Stress

★ ★ ★ ★ ★

### Deformation resistance

★ ★ ★ ★ ★

### External door for

- Basements
- Heated outbuildings
- Garages with direct access to the house
- Workshops and hobby rooms

### Ready-to-fit door set

Door leaf and frame with thermal break, galvanized and painted in Traffic white (similar to RAL 9016).

### Single-leaf

#### Thermally insulated

MZ Thermo65

THP 011:  $U_D = 0.87 \text{ W}/(\text{m}^2 \cdot \text{K})$

THP 051:  $U_D = 1.0 \text{ W}/(\text{m}^2 \cdot \text{K})$

MZ Thermo46

TPS 011:  $U_D = 1.1 \text{ W}/(\text{m}^2 \cdot \text{K})$

TPS 021:  $U_D = 1.4 \text{ W}/(\text{m}^2 \cdot \text{K})$

TPS 051:  $U_D = 1.6 \text{ W}/(\text{m}^2 \cdot \text{K})$

### TPS 021 / 051 glazing

Double insulated glazing (24 mm) with a U-value of up to approx.  $1.4 \text{ W}/(\text{m}^2 \cdot \text{K})$ , with synthetic glazing frame



Colours and decor surfaces

Page 27

Size range

Page 30

### High thermal insulation

The MZ Thermo46 / MZ Thermo65 multi-purpose door will help you reduce heating losses permanently. The door leaf with PU rigid foam infill, frame and threshold all come with a thermal break. This and the all-round double seals on all four sides make sure the door is perfectly sealed and improves thermal insulation by up to 49 % compared to a conventional multi-purpose door.

### Stability and functionality

The MZ Thermo46 / MZ Thermo65 is exceptionally stable and robust thanks to the fully filled door leaf. The door can be optimally adjusted using the three-way adjustable guide rollers.

### With or without glazing

On request, the MZ Thermo46 also comes with glazing to let daylight into your workshop or hobby room. The glazed versions also offer excellent thermal insulation on the interior and exterior thanks to double insulated safety glass.



The multi-purpose door MZ Thermo65 offers first class insulation with a 65-mm-thick door leaf and a particularly high  $U_D$ -value of up to  $0.87 \text{ W}/(\text{m}^2 \cdot \text{K})$ .



The multi-purpose door MZ Thermo46 features a 46-mm-thick door leaf and a thermal insulation value of up to  $1.1 \text{ W}/(\text{m}^2 \cdot \text{K})$ .



Glazing frame Roundstyle in TPS 021

You may choose from 3 styles: with a solid door leaf or glazing.



THP 011 / TPS 011



TPS 021



THP 051 / TPS 051



Glazing frame Profilstyle in TPS 051

\* Up to 49 % better thermal insulation compared to a conventional multi-purpose door



## MZ

### Stable and inexpensive internal and external door

Proven for over four decades, this multi-purpose door is stable, durable and weather-resistant, making it ideal for inside and outside. The MZ comes in a single-leaf or double-leaf design and is available with glazing on request.





## Product characteristics

### Break-in resistance

★ ★

### Thermal insulation

★ ★ ★

### Acoustic insulation

★ ★

### Fire-retarding

### Stress

★ ★ ★ ★ ★

### Deformation resistance

★ ★ ★ ★ ★

### Internal and external door for

- Unheated outbuildings
- Utility sheds
- Storage rooms

### Ready-to-fit door set

Door leaf and frame, galvanized and with powder-coated primer in Grey white (similar to RAL 9002).

### Single or double-leaf

### Dual handed (with corner frame)

### Thermally insulated

$U_D = 1.7 \text{ W}/(\text{m}^2 \cdot \text{K})^*$

### Acoustic rating

$R_w$  approx. 39 dB\*

### Possible additional functions:

### T30 fire-retarding\*

As a fire-rated door H8-5 up to door size 1000 x 2125 mm (see page 18)

\* For doors without glazing and with corner frame

### Stability for you

This ready-to-fit door set is especially robust thanks to a double-skinned, 45-mm-thick door leaf rebated on both sides, a sheet thickness of 0.9 mm, a mineral wool infill and steel reinforcement. The door provides a very high level of security with 2 solid steel security bolts. A 2-mm-thick corner frame with all-round EPDM seal keeps the door shut tight and has a bottom threshold rail that can be easily removed. The door is also available with a block frame and a 3-sided EPDM seal on request.



2-mm-thick corner frame with all-round seal

### More light thanks to glazing

Hörmann also offers its multi-purpose door MZ with glazing. Due to security reasons, this glazing is kept very narrow, but it still lets you benefit from daylight inside. 7 mm wired glass is provided as standard, but 20 mm insulated wired glass with a view of 230 x 1360 mm is also possible. The natural-finish aluminium glazing frame is fastened on the opposite hinge side with glazing beads as standard. For doors opening inwards, the glazing frame is optionally available with glazing beads on the hinge side.



Rectangular glazing (optional)



Round glazing (optional)



Glazing view 5 (optional)



## H8-5

# The best-selling boiler room door in Europe



For decades, the fire-rated door H8-5 has been providing optimum safety for boiler rooms and rooms with oil tanks. This door is the best example of how you can benefit from Hörmann's expertise in fire protection.



## Product characteristics

### Break-in resistance

★ ★

### Thermal insulation

★ ★ ★

### Acoustic insulation

★ ★ ★

### Fire-retarding

★ ★ ★ ★ ★

### Stress

★ ★ ★ ★ ★

### Deformation resistance

★ ★ ★ ★ ★

### Internal door for

- Boiler rooms
- Rooms with oil tanks

### Ready-to-fit door set

Door leaf and frame, galvanized and with powder-coated primer in Grey white (similar to RAL 9002).

### Single-leaf

### Dual handed

### T30 fire-retarding

acc. to DIN EN 1634

### Thermally insulated

acc. to EN ISO 12567-1

$U_D = 1.7 \text{ W}/(\text{m}^2 \cdot \text{K})^*$

### Acoustic rating

acc. to DIN 52210

$R_w$  approx. 39 dB\*

### Possible additional functions:

### Smoke-tight

acc. to DIN 18095

with overhead door closer, smoke-tight seal and threshold\*\*

\* With all-round seal

\*\*Not suitable for escape and rescue routes

### Stable door leaf

The double-skinned, 45-mm-thick door leaf is rebated on two sides. With a sheet thickness of 0.9 mm it is highly stable and is equipped with a fire-retarding mineral wool infill, steel reinforcement and 2 steel security bolts. The lock and lever handle set may be used with profile cylinders and deadlock keys. One deadlock key is provided.

### Integrated fire protection

On both the door and fire hatch the fire-proof material is not exposed but is concealed on the front side across the full width and flush-fitting.

### Sealed all-round

The 2-mm-thick corner frame with all-round seal reliably seals the fire-rated door H8-5. The bottom threshold rail is easy to remove if fitted with a continuous floor.

### Also as a smoke-tight door

On request, the H8-5 can be equipped with optional extras such as an overhead door closer, smoke-tight seal and threshold\*\* to make it a smoke-tight door.



2-mm-thick corner frame with all-round seal



The model H8-5 fire hatch is recommended for rooms with oil tanks



## H3D

# The functional door between garage and home



Due to fire hazards in garages, a fire-rated door between the house and garage is required by law. The H3D multi-purpose door is the best choice for this sensitive area. On request, this door can also act as a seal against smoke and engine noise and additionally protects your family from unwanted visitors with the RC 2 security package.



## Product characteristics

**Internal door for**  
the passage from the  
garage into the house

### Ready-to-fit door set

Door leaf and frame,  
galvanized and with  
powder-coated primer  
in Grey white (similar  
to RAL 9002).

### Single or double-leaf

**T30 fire-retarding**  
acc. to DIN EN 4102

**Thermally insulated**  
 $U_D = 1.9 \text{ W/(m}^2\cdot\text{K)}$

### Possible additional functions/optional extras:

#### Smoke-tight

acc. to DIN 18095

With the following optional extras:

- Retractable bottom seal or aluminium bottom profile with seal
- Overhead door closer and profile cylinder

#### Acoustic-rated\*

acc. to DIN EN ISO 717.1

With the following optional extras:

- Bottom seal  $R_w$  37 dB
- Aluminium bottom profile  $R_w$  41 dB
- Threshold rail  $R_w$  44 dB

#### Break-in-resistant RC 2\*\*

acc. to DIN EN V 1627

With the following optional extras:

- 2 additional security bolts
- Drill-proof locking cylinder acc. to DIN 18252, P-3-BS
- Aluminium security fitting in acc. with DIN 18257, class ES 1

### Glazings

- Clear fire-proof glass F30
- Please note: glazed doors require an overhead door closer.

\* The acoustic values apply to solid doors without glazing and are not applicable to doors fitted into gas concrete.

\*\*The resistance class RC 2 applies to doors without glazing and is not applicable to doors fitted into partition walls.

#### Break-in resistance

★ ★ ★ ★ ★

#### Thermal insulation

★ ★

#### Acoustic insulation

★ ★ ★ ★ ★

#### Fire-retarding

★ ★ ★ ★ ★

#### Stress

★ ★ ★ ★ ★

#### Deformation resistance

★ ★ ★ ★ ★

### Sturdy door leaf

The double-skinned, 45-mm-thick door leaf comes with a mineral wool infill, steel reinforcement and steel security bolts. The 2-mm-thick corner frame is equipped with a 3-sided EPDM seal and is easy to fit using grouting lugs.

### With optional glazing

On request, the multi-function door H3D is available with clear fire-proof glass for more light. These doors are equipped with an additional overhead door closer.

### Optional extras for further functions

You can increase the acoustic insulation and break-in resistance of the H3D with various optional extras or even make it a smoke-tight door.

Four types of clear fire-proof glass F30 are available for the H3D.

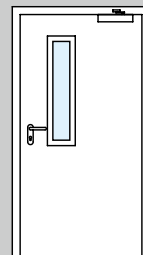

Glazing  
View 1

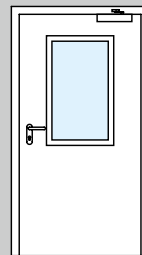

Glazing  
View 2

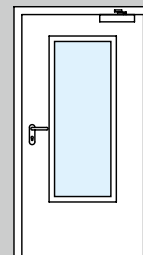

Glazing  
View 3

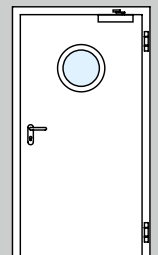

Round glazing  
Ø 300, 400, 500 mm





## WAT 40

As a passage from the garage into the home



With standard fire protection and security functions, the WAT 40 is the right choice for the passage from the garage into the hallway of your home. With a thick rebate leaf design and numerous colour and decor options, the door blends in perfectly with the other internal doors in your home.





## Product characteristics

### Break-in resistance

★★★★★

### Thermal insulation

★★

### Acoustic insulation

★★★

### Fire-retarding

★★★★★

### Stress

★★★★★

### Deformation resistance

★★★★★

### Internal door for

the passage from the garage into the home

### Ready-to-fit door set

Door leaf and frame, galvanized and painted in Traffic white (similar to RAL 9016).

### Single-leaf

### T30 fire-retarding

acc. to DIN EN 1634

### Smoke-tight

acc. to DIN EN 1634-3 with optional overhead door closer and bottom seal

### Break-in-resistant RC 2

acc. to DIN EN 1627

### Thermally insulated\*

$U_D = 1.8 \text{ W}/(\text{m}^2 \cdot \text{K})$

### Acoustic-rated\*

acc. to EN ISO 717-1  
Rw approx. 38 dB

\* Only in combination with a corner frame



Colours and decor surfaces

Page 27

Size range

Page 30

### Stable and functional

The WAT 40 features a double-skinned door leaf with a thick rebate design, an insert which is glued over the entire surface and sheet steel on both sides, making it especially stable. Door function and tightness are always ensured thanks to three-way adjustable hinges, seals on three sides and a retractable bottom seal.

### Security and fire protection as standard

The WAT 40 provides a high level of security through its multiple-point locking which features a security lever/knob handle set with drilling and pull-off protection and 3 steel bolts to prevent forced opening. This and the fact that it can withstand a fire for at least 30 minutes make the WAT 40 the right choice if fire protection and security are equally important to you.

### Various surfaces

Hörmann offers the WAT 40 in various surface finishes, such as, for example, Decograin. The door blends in perfectly with the other doors in your home thanks to this natural timber look.



Stable door leaf in a thick rebate design



Security lever/knob handle set with drill resistance and pull-off protection



Three-way adjustable galvanized guide rollers for easy door function

3 solid steel bolts on the hinge side prevent forced opening



## ZK

### The durable and inexpensive door

Over many years, Hörmann ZK doors have proven themselves as robust doors for everywhere from the basement to the roof. ZK doors do not warp and come with a high-quality surface that is durable, resistant to stains and easy to clean. Reliable quality at a low price.



## Product characteristics

### Break-in resistance

### Thermal insulation

★ ★

### Acoustic insulation

### Fire-retarding

### Stress

★ ★ ★ ★

### Deformation resistance

★ ★ ★ ★ ★

### Internal door for

- Basements
- Children's rooms
- Entrance to an unrenovated loft

### Door leaf or single, ready-to-fit door set

Door leaf and frame, galvanized and painted in Traffic white (similar to RAL 9016).

### Single or double-leaf

### Thermally insulated

$U_D = 2.1 \text{ W}/(\text{m}^2 \cdot \text{K})^*$

### Acoustic rating

$R_w$  approx. 25 dB\*

### Climatic class III

acc. to RAL-RG 426

### Duty category S

acc. to RAL-RG 426

\* For doors without glazing and with corner frame

### Stable door leaf

The double-skinned, 40-mm-thick door leaf with a thick rebate on 3 sides consists of galvanized sheet steel (0.6 mm) and a honeycomb insert glued over the entire surface, making it dimensionally stable and robust.

### Fully equipped as standard

As standard, you will receive the internal door ZK with a fitted lock and bright galvanized hinge top parts V 0020, firmly screwed into the reinforced sections, but without a lever handle set.

### As just a door leaf or ready-to-fit with a frame

The internal door ZK is supplied as just a door leaf or as a ready-to-fit door set, i.e. complete with lever handle set and special corner frame in Traffic white.

### Smooth, quiet closing

The door has a mortice lever/knob handle set in acc. with DIN 18251 class 3 and is prepared for profile cylinders (backset 55 mm). The door closes easily and quietly since it is equipped as standard with a plastic catch and steel bolt, deadlock insert and key, and on request with a profile cylinder.

### Flexible fitting

Thanks to the height adjustment and individual surface design, ZK doors are also ideal for modernising any room from the basement to the roof. They can be flexibly used in existing standard frames and all Hörmann steel frames (prepared for series V 8000 hinges).

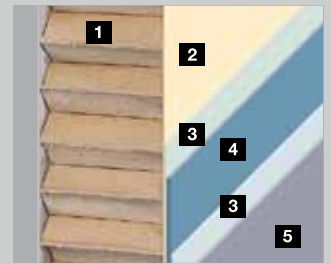

- 1 Honeycomb insert
- 2 Adhesive
- 3 Zinc coating
- 4 Steel
- 5 Powder-coating/foil-coating



You can individually design your door's smooth, silk matt surface.



The door leaf can be shortened at the bottom. With a height adjustment of up to 20 mm, this door is suitable for any modernisation project.

### Optional extras

Page 20



### Colours and decor surfaces

Page 27

### Size range

Page 30

## Extra equipment for an individual design

### Glazing shapes for internal door ZK



**Round glazing**  
Ø 300 or 400 mm,  
brushed stainless steel



**Glazing view 5**  
Anodised aluminium  
in natural finish (E6 / EV 1)



**Glazing view 6**  
Anodised aluminium  
in natural finish (E6 / EV 1)



**Glazing view 7**  
Anodised aluminium  
in natural finish (E6 / EV 1)



**Glazing view 8**  
Anodised aluminium  
in natural finish (E6 / EV 1)



Masterpoint



Mastercarré



Masterligne

### The glazing in the door

All ZK doors are available with glazing in the structures shown, with light 7 mm wired ornamental glass, 6 mm single-pane or laminated safety glass.

For on-site glazing, please note the pane thickness of 4 – 6 mm. Round glazing is only available from the factory.

### Optional extras for internal door ZK



Plastic ventilation grille  
(455 × 90 mm)



Wide-angle spyhole

Lever handle sets in various shapes and surfaces for internal door ZK



Black or white plastic



Stainless steel



Aluminium

# Whatever you want!

## Preferred colours\*

Hörmann steel doors come in 16 inexpensive preferred colours and all RAL colours. Surfaces are powder-coated with a high-quality primer (painted for external doors) which makes them especially resistant and durable.

All colours based on RAL.

## RAL to choose

The security door KSI 40 and internal door ZK are available in all RAL colours on request.



Grey aluminium\*\* RAL 9007

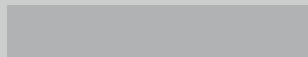

White aluminium RAL 9006

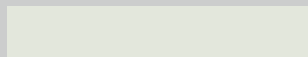

Grey white\*\* RAL 9002

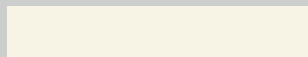

Cream\*\* RAL 9001

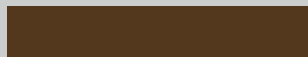

Terra brown RAL 8028

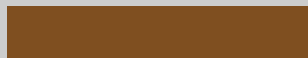

Clay brown RAL 8003



Window grey RAL 7040

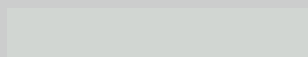

Light grey RAL 7035

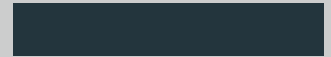

Anthracite grey RAL 7016



Moss green RAL 6005



Pigeon blue RAL 5014

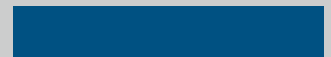

Gentian blue\*\* RAL 5010



Purple red RAL 3004



Ruby red RAL 3003



Flame red\*\* RAL 3000

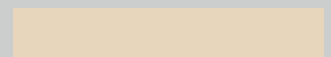

Light ivory RAL 1015

## Decors\*

For a natural and exclusive door style, we offer high-quality decors in 7 true-to-original timber looks as well as the especially elegant Titan Metallic CH 703 decor.



Golden Oak

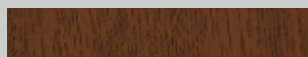

Dark Oak



Night Oak



Winchester Oak (only MZ Thermo46 / MZ Thermo65 / KSI Thermo46)

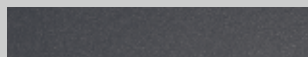

Titan Metallic CH 703 (only MZ Thermo46 / MZ Thermo65 / KSI Thermo46)

## Only for internal doors

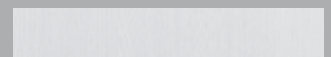

White Ash



Light Oak



Beech

The colours and surface finishes shown are subject to the limitations of the printing process and cannot be regarded as binding. Dark colours should not be used for doors that are exposed to the sun, as an increased material expansion may impair the door's function.

\* Except for MZ, H8-5, H3D

\*\*Except for KSI 40, MZ, H8-5, H3D, ZK

## Proven and inexpensive frames

Hörmann steel frames are especially robust and can withstand “accidents” with toy cars or run-ins with hard objects. The hot-galvanized and primed surface can be painted individually, letting you match it perfectly to the look of the steel or timber doors used. On request, the frames also come with a high-quality powder coating in any RAL colour.





## Product characteristics

**Corner and profile frames** for 40-mm-thick rebated door leaves

**Ready-to-fit standard frames** galvanized and with powder-coated primer in Light grey (similar to RAL 7035).

### Availability

- Ready-to-fit and welded
- To screw or clamp

### Fitting in

- Brickwork
- Partition wall

### Corner or profile frame

Where do you want your internal door to be fitted? This question must be answered before you can select your frame. If installed in brickwork, in the basement for example, an inexpensive corner frame is all you need. However, for the living areas we recommend a profile frame enveloping the wall. Partition wall frames are always designed as profile frames and are ideal for dry loft constructions.

### Welded or to screw or clamp

All Hörmann standard frames for brickwork or partition walls are ready-to-fit and welded or to screw or clamp. They come in a handy package that can be transported in a car and are already prepared for easy fitting by yourself.

### Variety is our strength

We have every frame you could possibly need. We offer door and window frames or passage frames between rooms. The frames are also available with segmental arches or Norman arches as well as in combination with a side element and transom light. All frames are additionally available in a final coating in any RAL colour or an elegant stainless steel version. We would be pleased to advise you.

### Flexible, long-lasting, elegant: VarioFix frame

For the Hörmann steel profile frame VarioFix, wall tolerances of up to 20 mm are no longer a problem: The adjustable decorative rebate compensates for different wall thicknesses during renovations and new construction projects. As easy to fit as a timber frame, the steel frame is additionally distinguished by its long service life and attractive design. Only VarioFix offers high resistance and an elegant shape coupled with the fitting principle of timber frames.

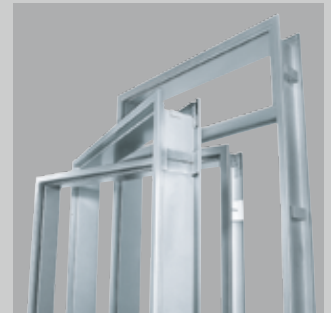

Corner and profile frames



Frame to screw or clamp

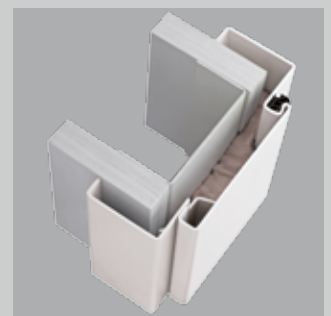

Profile frame VarioFix

Bottom image:

Sliding door frame for glass and timber pocket doors.



Standard sizes	External Doors				Internal doors				
Ordering size (nominal size)	Security door		Multi-purpose door		Fire-rated door		Multi-function door	Fire-rated security door	Internal door
	KSI Thermo46	KSI 40	MZ Thermo46 / MZ Thermo65	MZ	Door H8-5	Fire hatch H8-5	H3D	WAT 40	ZK
<b>Single-leaf doors</b>									
750 × 875						●			
800 × 800						●			
875 × 875						●			
875 × 1000						●			
875 × 1250						●			
875 × 2000	●		●						
875 × 2125	●		●						
625 × 2000									●
750 × 1750				●	●				
750 × 1875				●	●				●
750 × 2000		●		●	●		●	●	●
750 × 2125		●					●	●	●
800 × 1800				●	●				
800 × 1875				●	●				
800 × 2000				●	●				
875 × 1750				●	●				
875 × 1800				●	●				
875 × 1875		●		●	●		●		●
875 × 2000		●		●	●		●	●	●
875 × 2125		●		●	●		●	●	●
1000 × 1875		●		●	●				●
1000 × 2000	●	●	●	●	●		●	●	●
1000 × 2100	●		●						
1000 × 2125	●	●	●	●	●		●	●	●
1100 × 2100	●		●						
1125 × 2000							●		
1125 × 2125				●			●		●
1250 × 2000				●					●
1250 × 2125				●					●
<b>Double-leaf doors</b>									
1500 × 2000				●			●		●
1500 × 2125							●		●
1750 × 2000				●			●		●
1750 × 2125							●		●
2000 × 2000				●			●		●
2000 × 2125				●			●		●
2125 × 2125							●		
2250 × 2250							●		

Please state handing  
on order!



Left-hand hinged



Right-hand hinged



Traffic leaf left-hand hinged



Traffic leaf right-hand hinged

Special sizes	External Doors					
Ordering size (nominal size)	Security door		Multi-purpose door			
	KSI Thermo46	KSI 40	MZ Thermo46 / MZ Thermo65			MZ
			TPS 011 / THP 011	TPS 021	TPS 051 / THP 051	
Single-leaf doors						
Width	832 – 1250	625 – 1250	700 – 1250	700 – 1250	875 – 1250	625 – 1250
Height	1875 – 2250	1700 – 2250	1750 – 2250	1875 – 2250	1875 – 2250	1570 – 2134
Double-leaf doors						
Width						1250 – 2250
Height						1570 – 2134

Special sizes	Internal doors				
Ordering size (nominal size)	Fire-rated door		Multi-function door	Fire-rated security door	Internal door
	Door H8-5	Fire hatch H8-5	H3D	WAT 40	ZK
<b>Single-leaf doors</b>					
Width	625 – 1000	625 – 1000	625 – 1125	625 – 1164	500 – 1250
Height	1750 – 2125	800 – 1749	1750 – 2250	1964 – 2132	1500 – 2250
<b>Double-leaf doors</b>					
Width			1375 – 2250		1500 – 2500
Height			1750 – 2250		1500 – 2250

Frames	Corner frame	Profile frame
Ordering size (nominal size)		
625 × 2000	●	●
750 × 2000	●	●
875 × 2000	●	●
1000 × 2000	●	●
625 × 2125	●	●
750 × 2125	●	●
875 × 2125	●	●
1000 × 2125	●	●

Profile frame	Brickwork	Partition wall	Gypsum plasterboard
Wall widths (MW)			
75		●	
80	●		●
100	●	●	●
125		●	
130	●		
145	●		
150		●	
160	●		
180	●		
205	●		
270	●		
290	●		
330	●		

Multi-purpose door MZ Thermo46 / MZ Thermo65, security door KSI Thermo46

Vertical view

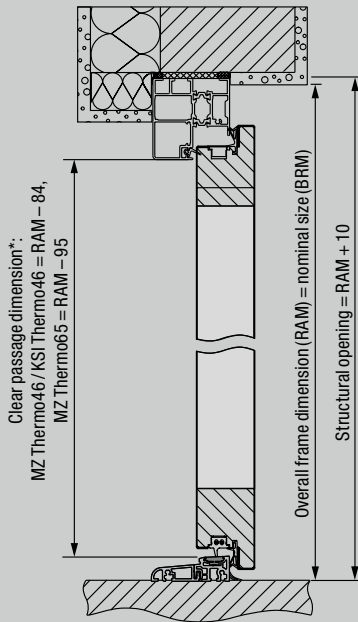

Horizontal view

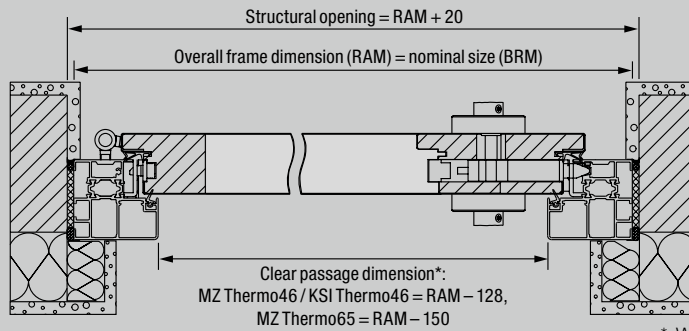

\* With an opening angle of 90° and without handles and levers, the clear passage width is reduced by 2 mm.

Fitting versions

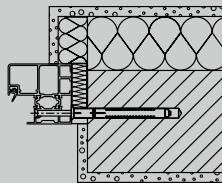

**Block frame**  
Fitting to brickwork  
Countersunk fitting

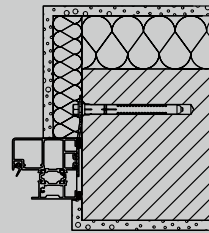

**Block frame**  
Anchor fitting

Security door KSI 40

Vertical view

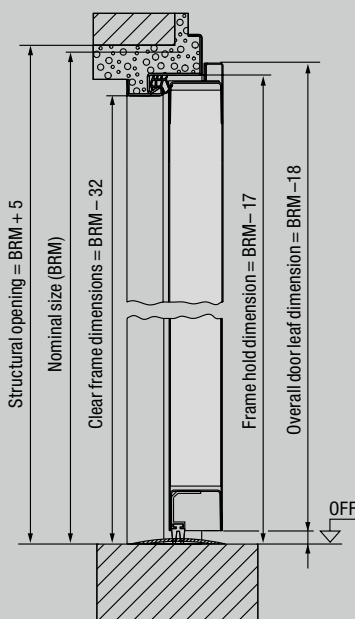

Horizontal view

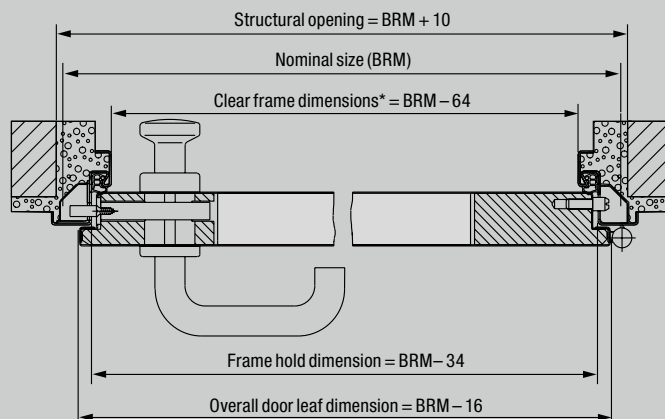

\* With an opening angle of 90° and without handles and levers, the clear passage width is reduced by 2 mm.

Fitting versions

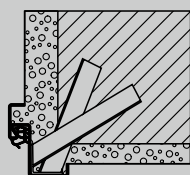

Fitting with grouting  
lugs

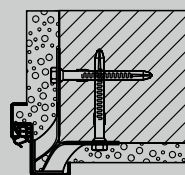

Fitting with grouting  
lugs

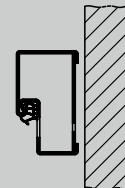

Block frame for fitting  
in the opening  
(profile 21101)

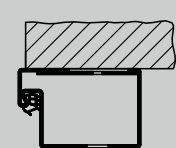

Block frame for fitting  
to the wall (profile 006)  
(tested on the opposite  
hinge side)

## Multi-purpose door MZ, fire-rated door H8-5

Vertical view

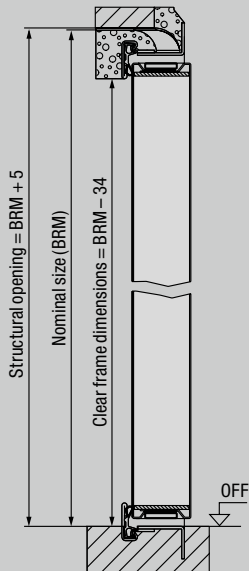

Horizontal view

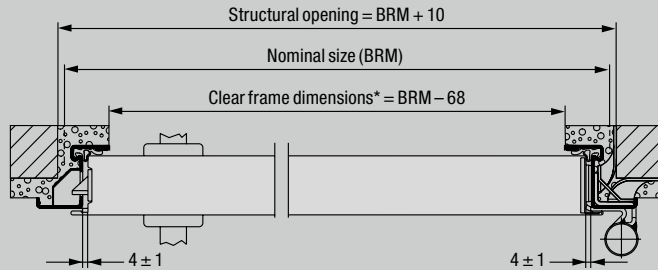

\* With an opening angle of 90° and without handles and levers, the clear passage width is reduced by 25 mm.

Fitting versions

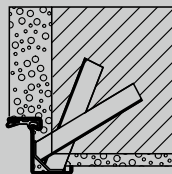

Fitting with grouting lugs

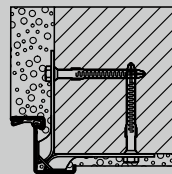

Fitting with grouting lugs

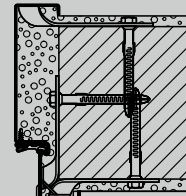

Corner and counter frame  
Fitting with grouting lugs

## Multi-function door H3D

Vertical view

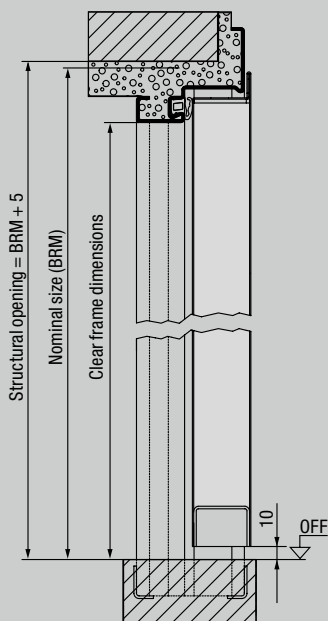

Horizontal view

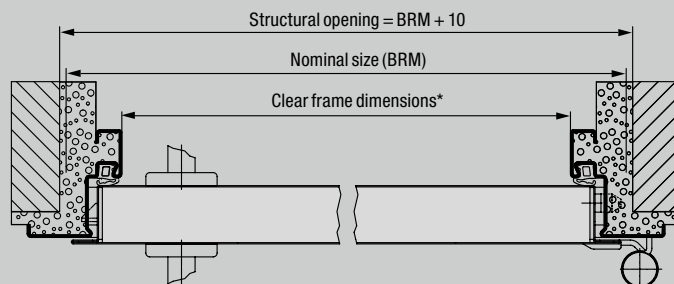

\* With an opening angle of 90° and without handles and levers, the clear passage width is reduced by 93 mm.

Fitting versions

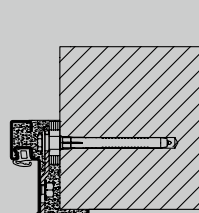

Corner frame  
with concealed  
plug-and-screw fitting

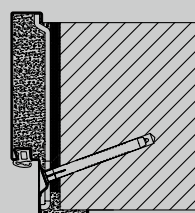

Profile frame  
Diagonal fixing  
up to wall width 175

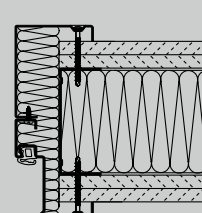

Corner and counter  
frame  
Screw-fixing

This door comes in a variety of other frame types. For more information, please contact your Hörmann partner.



## Fire-rated security door WAT 40

### Vertical view

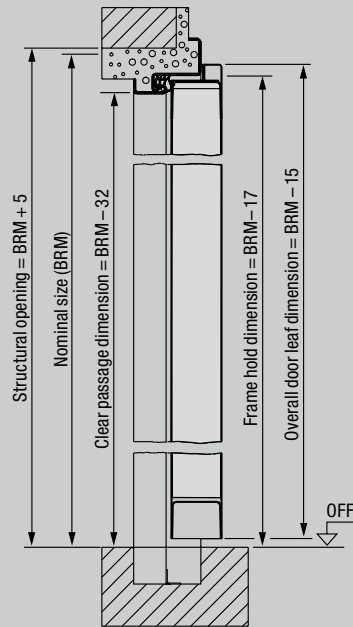

### Horizontal view

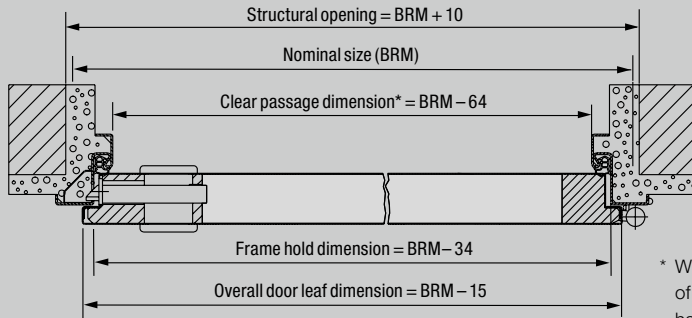

\* With an opening angle of 90° and without handles and levers, the clear passage width is reduced by 2 mm.

### Fitting versions

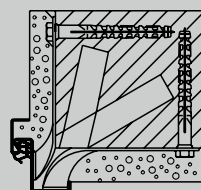

**Corner frame**  
Fitting to brickwork  
Grouting lugs

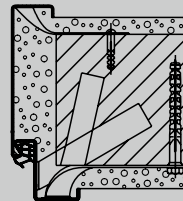

**Profile frame**  
Fitting to brickwork  
Grouting lugs

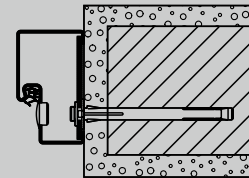

**Block frame**  
Fitting to brickwork  
Plug-and-screw fitting

## Internal door ZK

### Vertical view

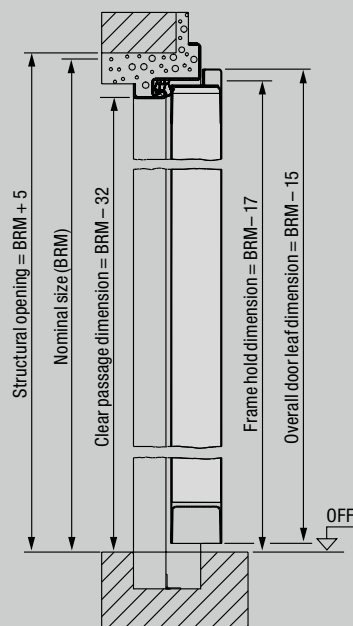

### Horizontal view

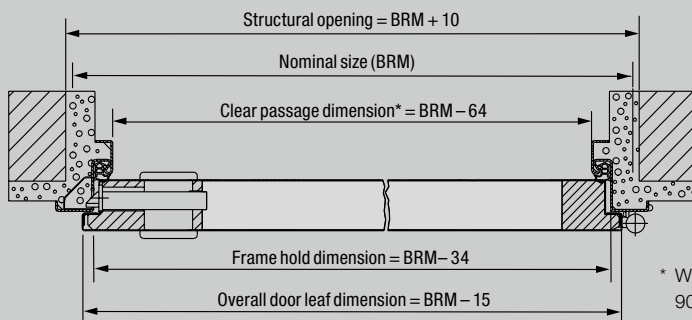

\* With an opening angle of 90° and without handles and levers, the clear passage width is reduced by 2 mm, and by 4 mm in the case of double-leaf doors.

### Fitting versions

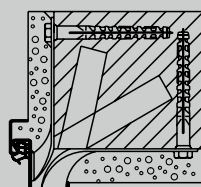

**Corner frame**  
Fitting to brickwork  
Grouting lugs

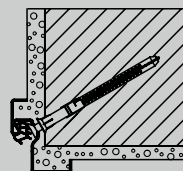

**Special corner frame**  
Plug-and-screw  
fitting through  
the groove bottom

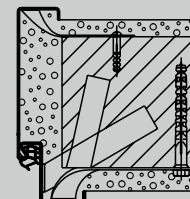

**Profile frame**  
Fitting to brickwork  
Grouting lugs

Corner frame DIN 18111  
for brickwork

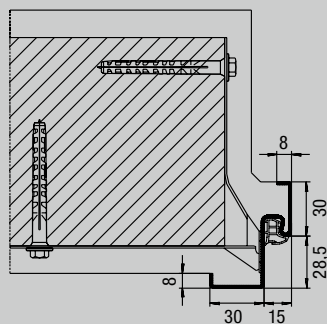

Profile 11100

Profile frame DIN 18111  
for brickwork

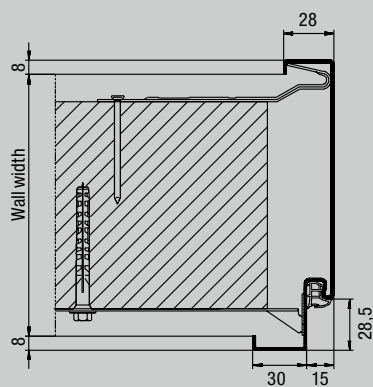

Profile 21100

Profile frame B 45  
for gypsum plasterboard

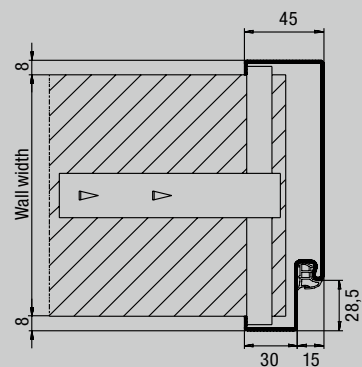

Profile 21101

Profile frame  
for partition walls

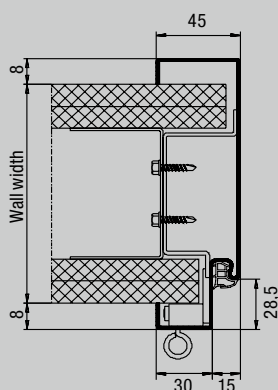

Profile 21120

Profile knock-down frame  
for partition walls  
**3-part for retrofitting**

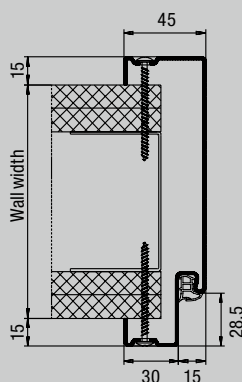

Profile 21120  
Screw-fixing

Double-shell profile frame  
for partition walls  
**For retrofitting**

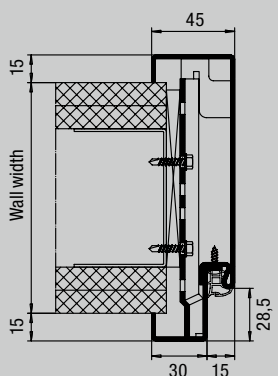

Profile 21180  
rebated

Steel profile frame VarioFix  
for all wall types  
**For retrofitting**

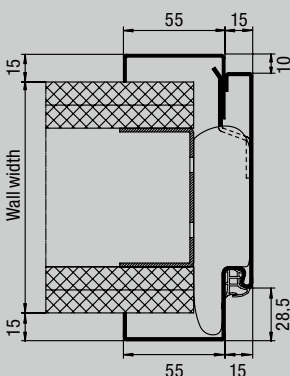

Profile 31103  
rebated



# Discover a new feeling of home: high-quality internal doors

Hörmann internal doors give your home an extra level of comfort. Hörmann offers a comprehensive programme of beautiful door designs, various handle variants and a selection of surfaces. For example, the extremely impact-resistant Duradecor surface finish will convince you with regard to ease of care and robustness.

Whether classic or modern, white lacquer or real wood veneer, with glass elements or stainless steel embellishments or as an all-glass door matching the DesignLine timber doors – Hörmann offers you the internal door that suits you and your furnishings perfectly.



Internal door BaseLine



Internal door DesignLine and all-glass doors



Internal door with panel design



Internal doors ConceptLine



You can find more information in our Internal Doors catalogue.

