

Art.-Nr.: 1 106 512 RE / Stand: 04:2017 / Druck 04:2017

DE**Anleitung für Montage, Betrieb und Wartung**

Garagenschwinger

EN**Instructions for Fitting, Operating and Maintenance**

Up-and-over garage door

FR**Instructions de montage, d'utilisation et d'entretien**

Porte de garage basculante

ES**Instrucciones de montaje, funcionamiento y mantenimiento**

Puerta de garaje basculante

RU**Руководство по монтажу, эксплуатации и техническому обслуживанию**

Гаражные подъемно-поворотные ворота

+**NL** NEDERLANDS**IT** ITALIANO**PT** PORTUGUÊS**PL** POLSKI**HU** MAGYAR**CS** ČESKY**SL** SLOVENSKO**NO** NORSK**SV** SVENSKA**FI** SUOMI**DA** DANSK**SK** SLOVENSKY**TR** TÜRKÇE**LT** LIETUVIŲ KALBA**ET** EESTI**LV** LATVIEŠU VALODA**HR** HRVATSKI**SR** SRPSKI**EL** ΕΛΛΗΝΙΚΑ**RO** ROMÂNĂ**BG** БЪЛГАРСКИ

ENGLISH

Contents

Tools needed for fitting.....	129
Articles supplied	130-131

1	⚠ Safety Instructions	8
1.1	Qualified persons.....	8
1.2	Warnings and symbols used	8
1.3	Intended use	9
1.4	General safety instructions	9
2	Fitting and Initial Start-Up.....	9
2.1	Safety instructions	9
2.2	Fitting.....	9
2.2.1	Transport locking device / on-site infill	9
2.2.2	Fitting the handle	10
2.2.3	Fitting to the ceiling	10
2.2.4	Door action check	10
2.3	Initial start-up.....	10
2.3.1	Checking the door spring tension (Figure 5.1).....	10
3	Manually operation	10
3.1	Safety instructions	10
3.2	Opening the door with the handle	10
3.3	Locking and unlocking the door	10
4	Inspection and Maintenance	11
4.1	Safety instructions	11
4.2	Checking the condition of the door	11
4.3	Checking the door spring tension	11
4.4	Replacing the door tension springs.....	11
4.5	Checking the track rollers and tracks.....	11
4.6	Checking the lock and locking mechanism.....	11
4.7	Accessories	11
5	Surface Protection.....	11
5.1	Door with steel / aluminium sheet infill.....	11
6	Cleaning and Care	11
6.1	Door surfaces made of steel / aluminium sheet metal.....	11
6.2	Data label.....	11
7	Assistance with malfunctions.....	11
8	Dismantling	12



Illustrated section	129
----------------------------------	------------

Make sure that these instructions remain with the door operator!

Read and follow these instructions carefully!

These instructions are **original operating instructions** as outlined in the EC Directive 2006/42/EC.

They provide you with important information on the safe fitting and operation, as well as proper care and maintenance, of your garage door.

Keep these instructions and the warranty booklet in a safe place for later reference.

Enter the serial number (see the data label) here.

Serial no.:

1 ⚠ Safety Instructions

The manufacturer is not liable for damage resulting from non-compliance with these instructions and the safety instructions.

1.1 Qualified persons

Have a qualified person (competent persons in acc. with EN 12635) fit, start-up and maintain the door following these instructions. Observe the requirements in the standards EN 12604 and EN 12635.

1.2 Warnings and symbols used

Special safety instructions are included at various important points. They are identified by the following symbols and signal words.



The general warning symbol indicates a danger that can lead to **injury or death**.



WARNING

Indicates a danger that can lead to death or serious injuries.



CAUTION

Indicates a danger that can lead to minor or moderate injuries.

ATTENTION

Indicates a danger that can lead to **damage or destruction of the product**.



Important note for avoiding damage to property



Permissible arrangement or activity

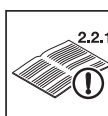

See text (e.g. section 2.2.1)



See separate fitting instructions for the control or for the additional electrical control elements

Dissemination as well as duplication of this document and the use and communication of its content are prohibited unless explicitly permitted. Noncompliance will result in damage compensation obligations. All rights reserved in the event of patent, utility model or design model registration. Subject to changes.



Manually operation

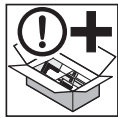

Optional components



Move component slowly

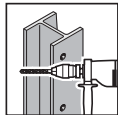

Drilling in steel



Drilling in concrete / brickwork



Inspect



Tighten the screws firmly



Audible engagement

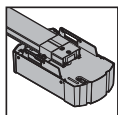

Operator

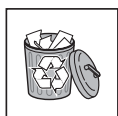

Dispose of component / packaging

1.3 Intended use

- The garage door is suitable for use outside; it opens outwards with an up-and-over action.
- The garage door is intended to be used with an operator! Follow the separate instructions for fitting and operation of the operator.

1.4 General safety instructions

- Always keep the swivelling and opening area of the door clear. When operating the door, always make sure that there are no persons, especially children, or objects within the door's area of travel!
- Never use the door to lift objects and / or persons.
- Do not attach any additional components of another make! The tension springs are matched to the door leaf weight. Additional components can overload the springs.
- Do not alter or remove any components! Otherwise you risk putting important safety components out of action. Only use original components precisely matched to the garage door.

- Protect the door from caustic, aggressive substances, e.g. nitrous reactions from stones or mortar, acids, alkali solutions, de-icing salt, aggressive paints or sealants.
- Make sure that there is sufficient water run-off and ventilation (drying) in the area of the bottom seal and the frame parts.
- Operating the door under windy conditions may be dangerous.

2 Fitting and Initial Start-Up

2.1 Safety instructions

⚠ WARNING

Danger of injury

There is a danger of injury during fitting. Observe the following instructions:



- ▶ Wear safety glasses and protective gloves.



- ▶ Check that the fixing materials supplied are suitable for the given structural conditions. Only use suitable fixing material.
- ▶ Always obtain the permission of the structural engineer before fastening the door to supporting structural elements.
- ▶ Secure the door from falling.
- ▶ Support the tracks properly.
- ▶ Secure the door leaf from falling.
- ▶ Fit all delivered fastenings according to the fitting instructions.

2.2 Fitting

The garage door can be fitted from the inside behind the opening or in the opening.

All specified dimensions in the illustrated section are in mm.

2.2.1 Transport locking device / on-site infill

⚠ WARNING

Door tension spring is under tension

Observe the following instructions to avoid any injuries.

- ▶ You must fasten the lever arm to the door before removing the transport locking device.

On-site infill

- ▶ First install the infill and then remove the transport locking device so that the door does not bounce up.
- ▶ Observe the maximum permissible infill weight.

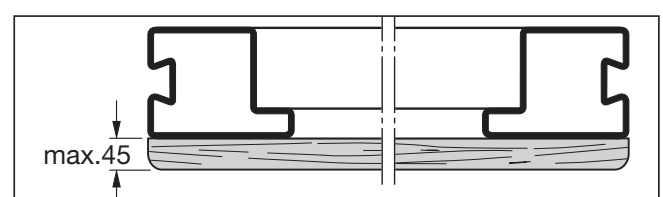

ENGLISH

2.2.2 Fitting the handle

- Always choose the pin setting (**a**, **b** or **c**) with the largest possible guidance for the interior handle.
- Shorten the pin of part ① if dimension **A** is less than 36 mm.

2.2.3 Fitting to the ceiling**⚠ CAUTION****Protruding anchor**

There is a risk of injury when fitting to the ceiling without sufficient headroom.

- ▶ Shorten the anchor flush with the lower edge of the track.

2.2.4 Door action check

- ▶ Check the door action.

In order for the door to travel freely, the diagonal dimensions **a** and **b** must be equal.

To ensure simple and safe fitting, carefully go through the work steps illustrated in Figures 1 to 8!

2.3 Initial start-up**2.3.1 Checking the door spring tension (Figure 5.1)**

- ▶ Open the door halfway.
The door should hold this position.

⚠ WARNING**Door spring tension**

Improper adjustment of the door spring tension may result in injuries.

- ▶ Only have a specialist adjust the door spring tension in accordance with **Figure 5.1** when the door is open and secured.

If the door moves substantially downwards:

- ▶ Increase the spring tension.

If the door moves substantially upwards:

- ▶ Decrease the spring tension.

⚠ WARNING**Door travel**

There is a risk of injury in the door's swivelling and opening area.

- ▶ When in operation, make sure that neither persons, children in particular, nor objects are located within the door's area of travel.
- ▶ Keep a safe distance of 1300 mm away from the door.

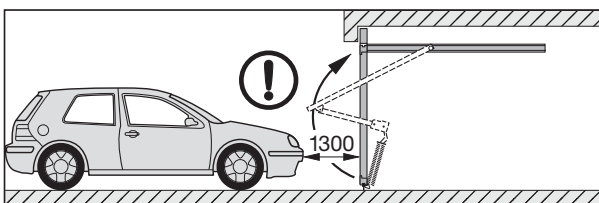
**NOTE:**

- Follow the operator manufacturer's instructions for doors with operator.

Perform a test run and check the door in accordance with Chapter 2, *Fitting and Initial Start-Up*.

When properly fitted and inspected, the garage door can be easily moved, is functionally safe and easy to operate.

3 Manually operation**3.1 Safety instructions****⚠ WARNING****Door travel**

There is a risk of injury in the door's swivelling and opening area.

- ▶ When in operation, make sure that neither persons, children in particular, nor objects are located within the door's area of travel.

Opening and closing

There is a risk of injury when opening or closing the door improperly.

Manually opening:

- ▶ Only open the door with the exterior handle or interior handle, never with the lever arm or the cord knob.
- ▶ Always slide the door fully into the end-of-travel position and wait until the door has come to a stop.

Manually closing:

- ▶ Only close the door with the exterior handle, interior handle or the cord knob, never with the lever arm.
- ▶ Make sure that the locking engages correctly.

3.2 Opening the door with the handle**Opening from the outside:**

- ▶ Turn the handle a quarter turn clockwise.

Opening from the inside:

- ▶ Turn the handle a quarter turn anti-clockwise.

The door is not locked when closed with the grip handle. Use the key or locking pin to lock the door.

3.3 Locking and unlocking the door

From outside with the key and from inside with the locking pin.

Unlocking from the outside:

- ▶ Turn the key one whole turn clockwise and remove the key.

Locking from the outside:

- ▶ Turn the key one whole turn anti-clockwise and remove the key.

Unlocking from the outside - self-locking:

1. Turn the key half a turn clockwise and slightly open the door.
2. Turn the key back to the original position and remove it.

When the door is closed, the lock is locked again.

Unlocking from inside:

- ▶ Push the locking pin to the left.

By unlocking in this way, you can then open the door without a key.

Locking from inside:

- Push the locking pin to the right.

4 Inspection and Maintenance

4.1 Safety instructions

- Inspection and maintenance tasks must be carried out by a specialist in accordance with these instructions at least once a year (or every 6 months if there are more than 50 door cycles per day).

WARNING

Danger of injury

There is a risk of injury during inspection and maintenance. Follow the instructions below:

- Disconnect the operator and control from the power supply.
- Functional parts, particularly safety components, may only be exchanged by a specialist.

4.2 Checking the condition of the door

- Visually inspect the general condition of the door, all components and safety devices for completeness, proper condition and effectiveness.
- Check all fixing points for a secure hold. Tighten the screws if necessary.
- Lubricate all pivot points with a commercially available lubricating oil. Do not use grease (see **Figure 4.6**).

4.3 Checking the door spring tension

See Chapter 2, *Fitting and Initial Start-Up*.

4.4 Replacing the door tension springs

- Have the door tension springs replaced by a specialist after approx. 25,000 door cycles.

This is required at the following approximate time:

Door cycles per day	Period
Up to 5	Every 15 years
6 – 10	Every 8 years
11 – 20	Every 4 years
21 – 40	Every 2 years
Over 40	yearly

CAUTION

Elongated door tension spring

Danger of injury due to elongated door tension spring – the coil spacing is irregular.

- Call in a qualified specialist to replace the door tension spring immediately.

4.5 Checking the track rollers and tracks

- Clean the tracks.
- Check the track rollers for wear. Have the track rollers replaced by a specialist if they are greatly worn or damaged.

4.6 Checking the lock and locking mechanism

ATTENTION

Care products

Unsuitable care products may cause damage.

- Only use specialised care products for the profile cylinder. Do not use oil or graphite.
- Lubricate the locking rotary catch with a commercially available lubricating oil. Do not use grease.

Check the locking as shown in Figure 7b.2 and adjust it if necessary.

4.7 Accessories

- To ensure a high level of quality, safety, reliability, as well as a long service life, only use original parts intended for this particular garage door.
- Only use an operator approved for the garage door according to EN 13241-1. Follow the separate instructions for fitting and operation provided by the operator manufacturer. Immobilise both rotary catches.

5 Surface Protection

5.1 Door with steel / aluminium sheet infill

The door leaf is made of galvanized material and has a polyester powder-coating. Scratches or minor damage are no reason for complaints. Refresh the final coat when necessary, depending on the local weather conditions.

For this, follow the steps below:

1. Lightly sand the door surface with a fine sand paper (at least 180 grain size).
2. Clean the door surface with water and then dry it.
3. Apply a 2K-EPOXY-etch primer to the door surface and paint it with a conventional synthetic resin paint for outdoor applications. Make sure the two coatings are compatible with each other. Follow the instructions provided by the paint manufacturer.

6 Cleaning and Care

6.1 Door surfaces made of steel / aluminium sheet metal

- Clean the door surfaces with clear water and a soft sponge or with conventional paint cleaners.

6.2 Data label

- Clean the data label.
- It must always be easy to read.

7 Assistance with malfunctions

If the door is difficult to move or exhibits other malfunctions:

- Check all function-related components. To do this, please follow the instructions in the section 4 *Inspection and Maintenance*.
- In the case of uncertainty, please contact a specialist for assistance.

ENGLISH

8 Dismantling

Have the door dismantled and disposed of by a specialist.

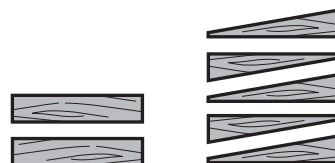
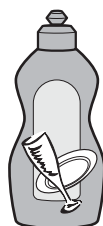
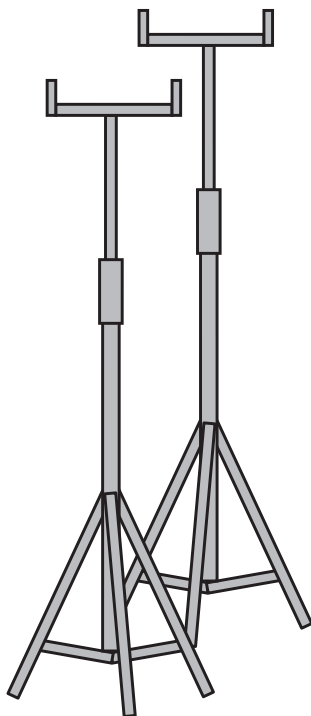
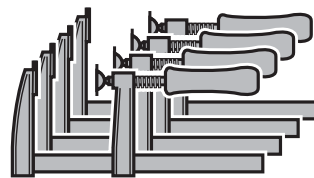
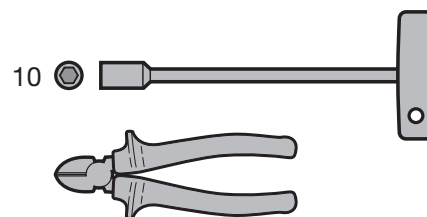
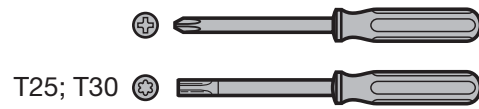
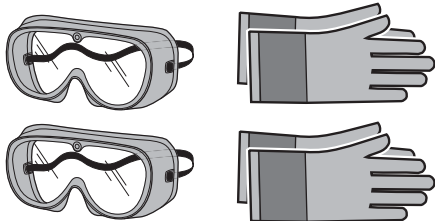
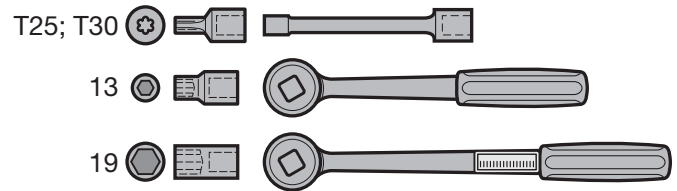
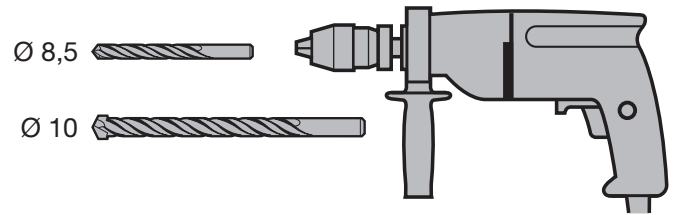
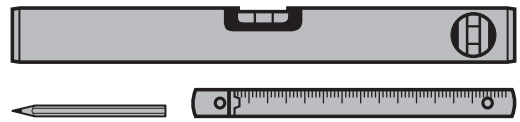
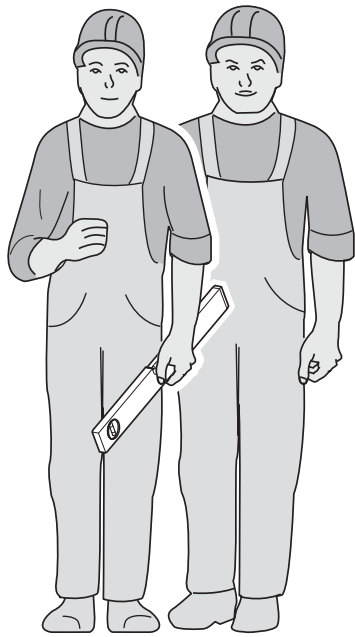

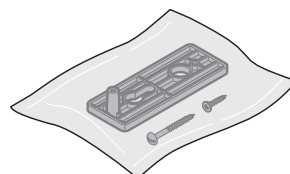
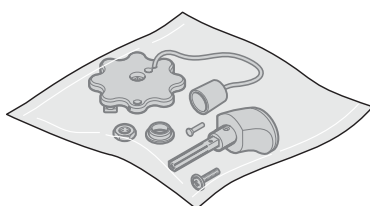
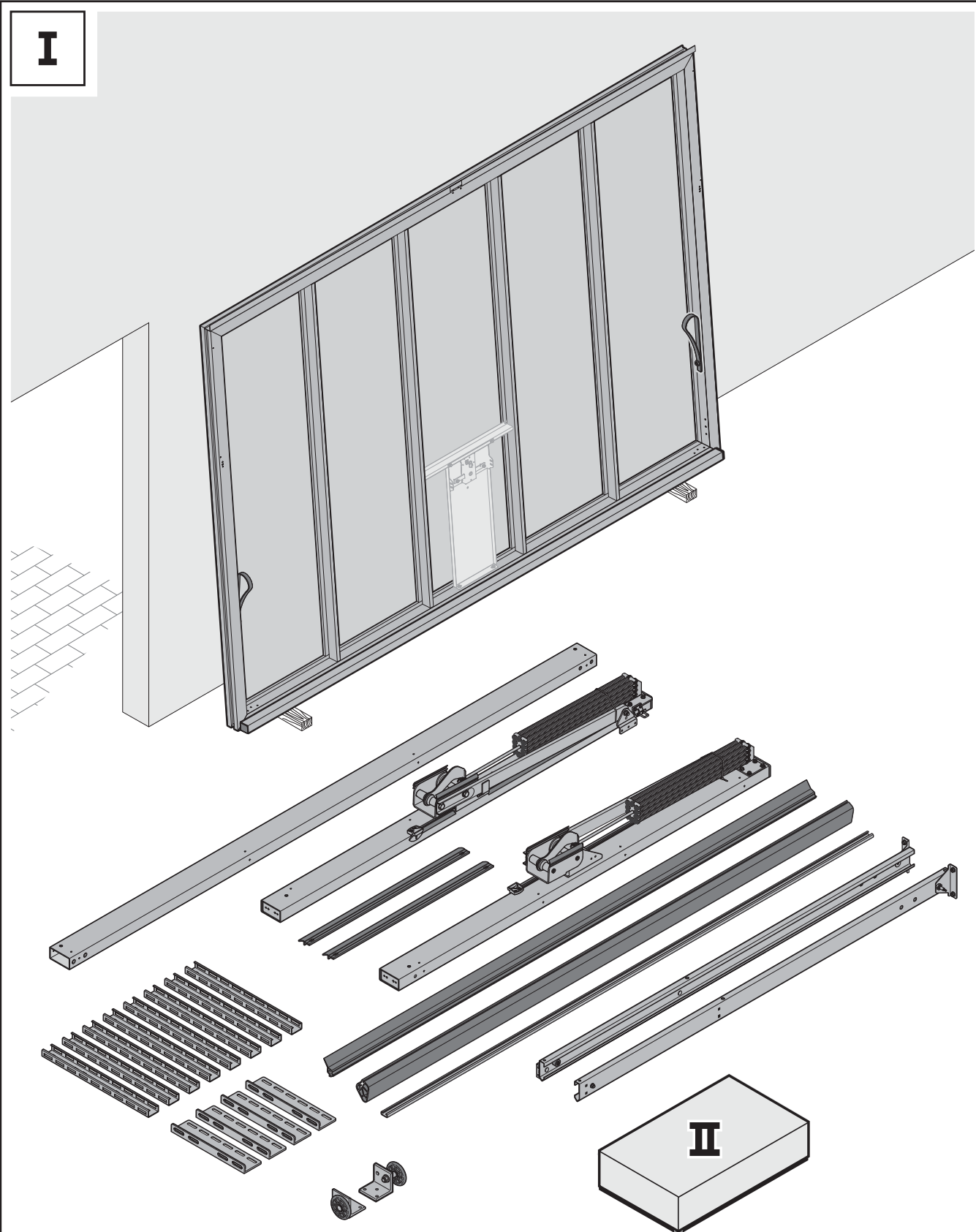
I

II

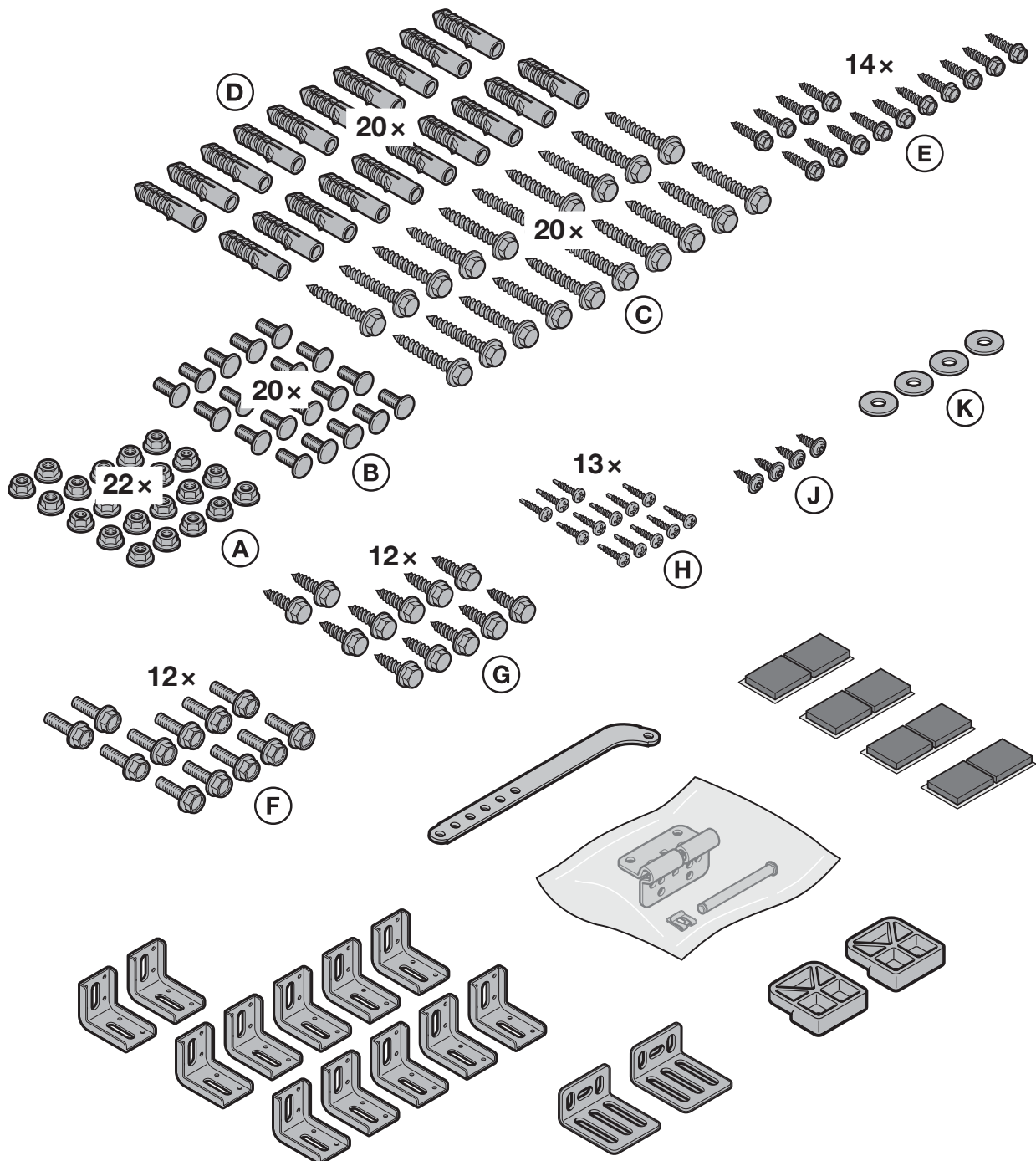
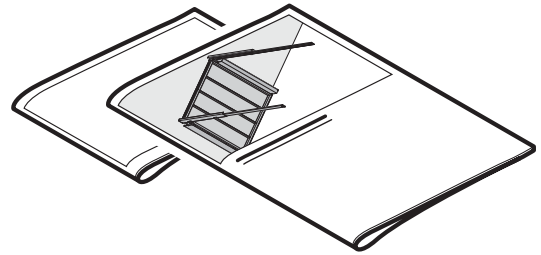
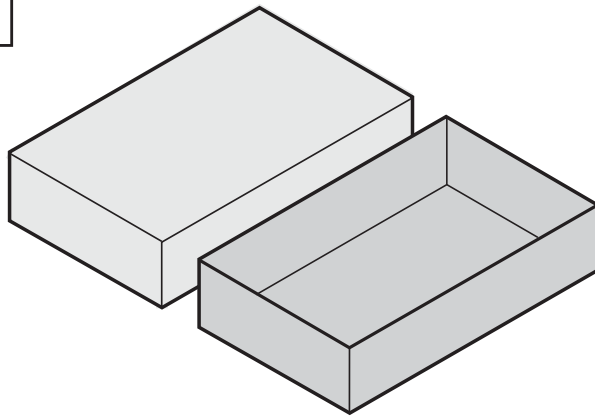

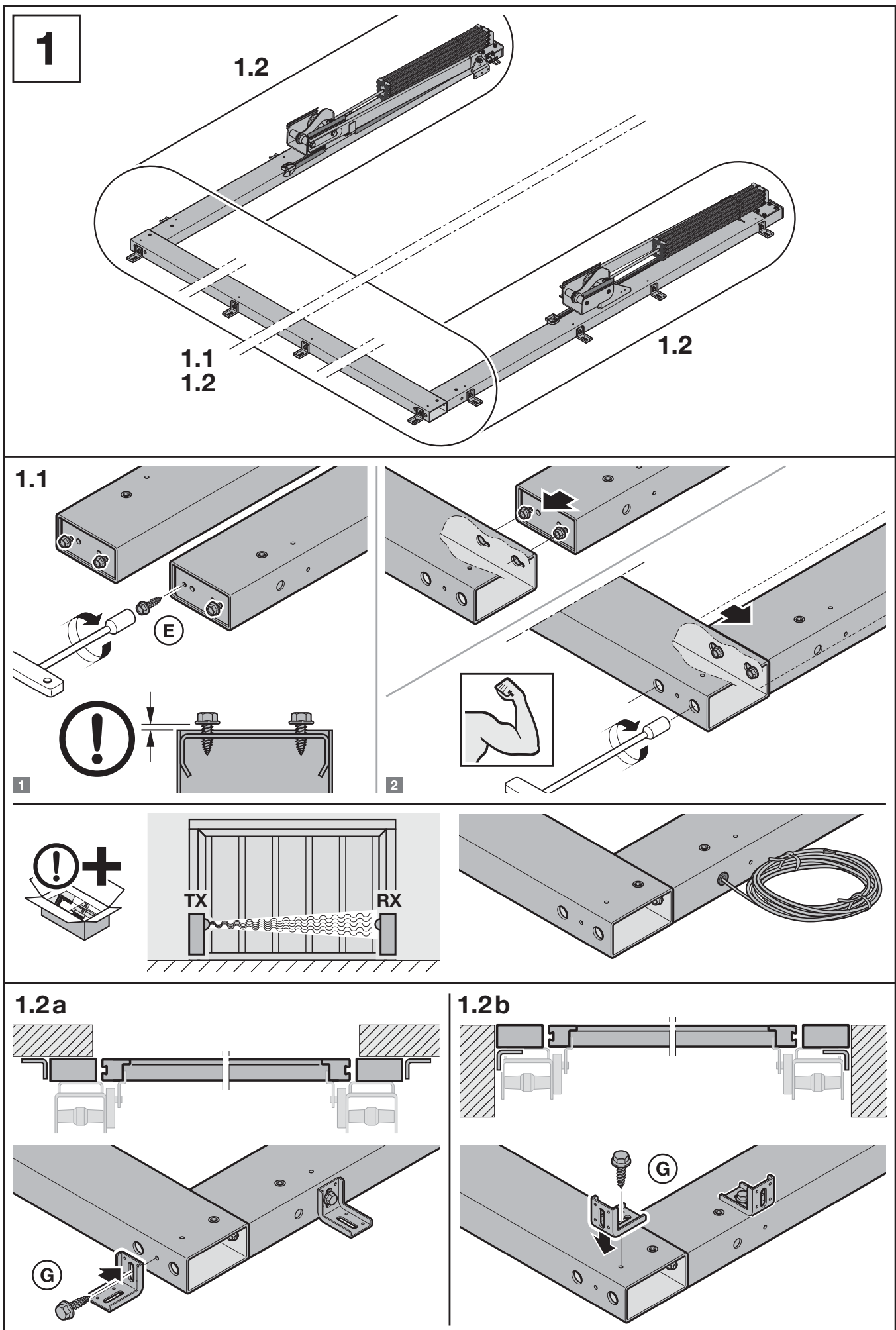

1.3

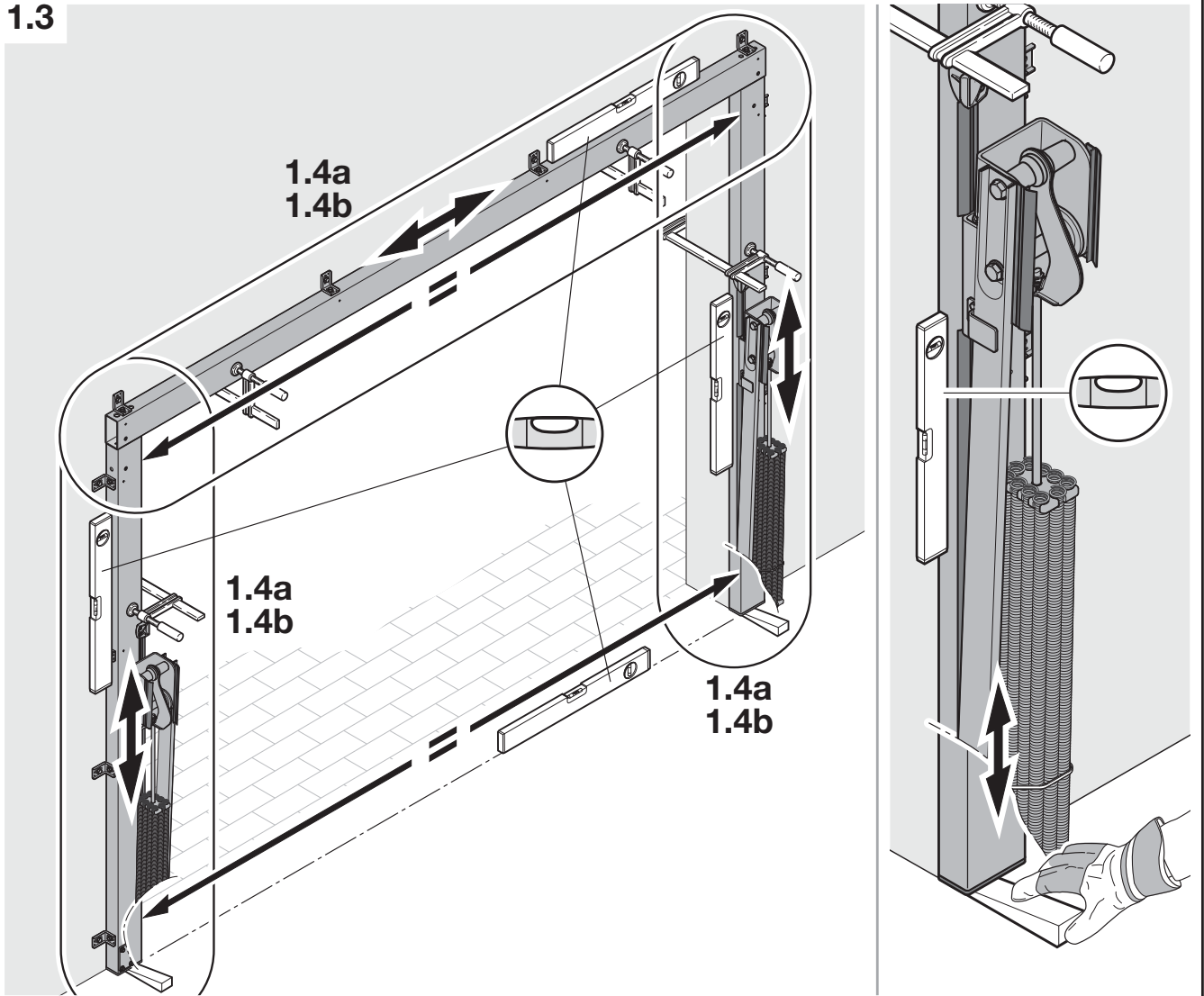

1.4a

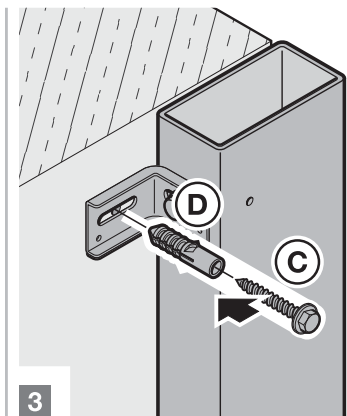
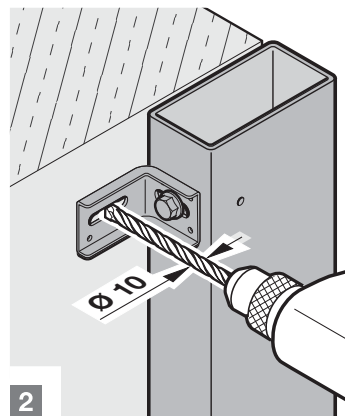
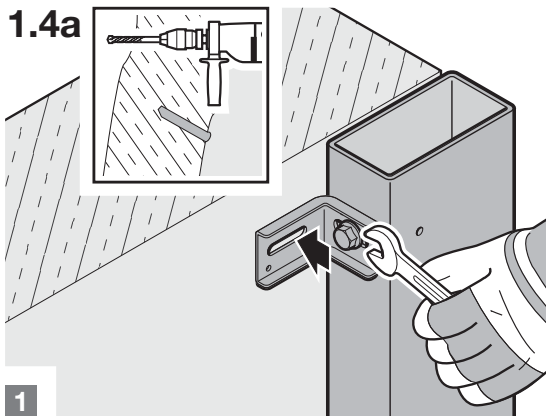

1.4b

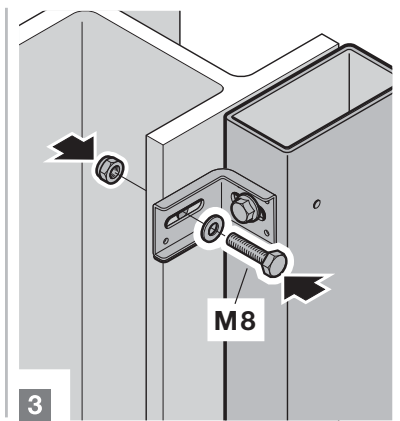
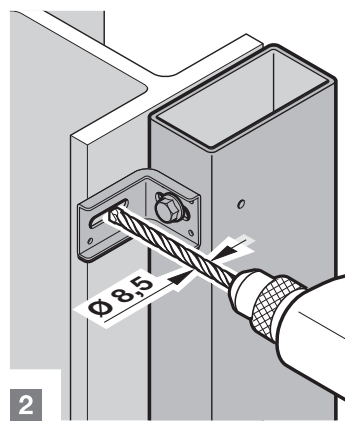
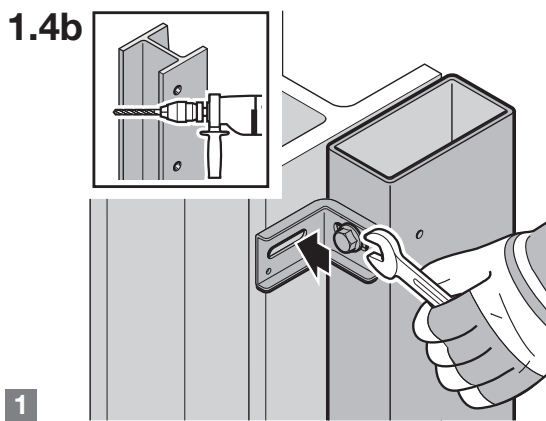

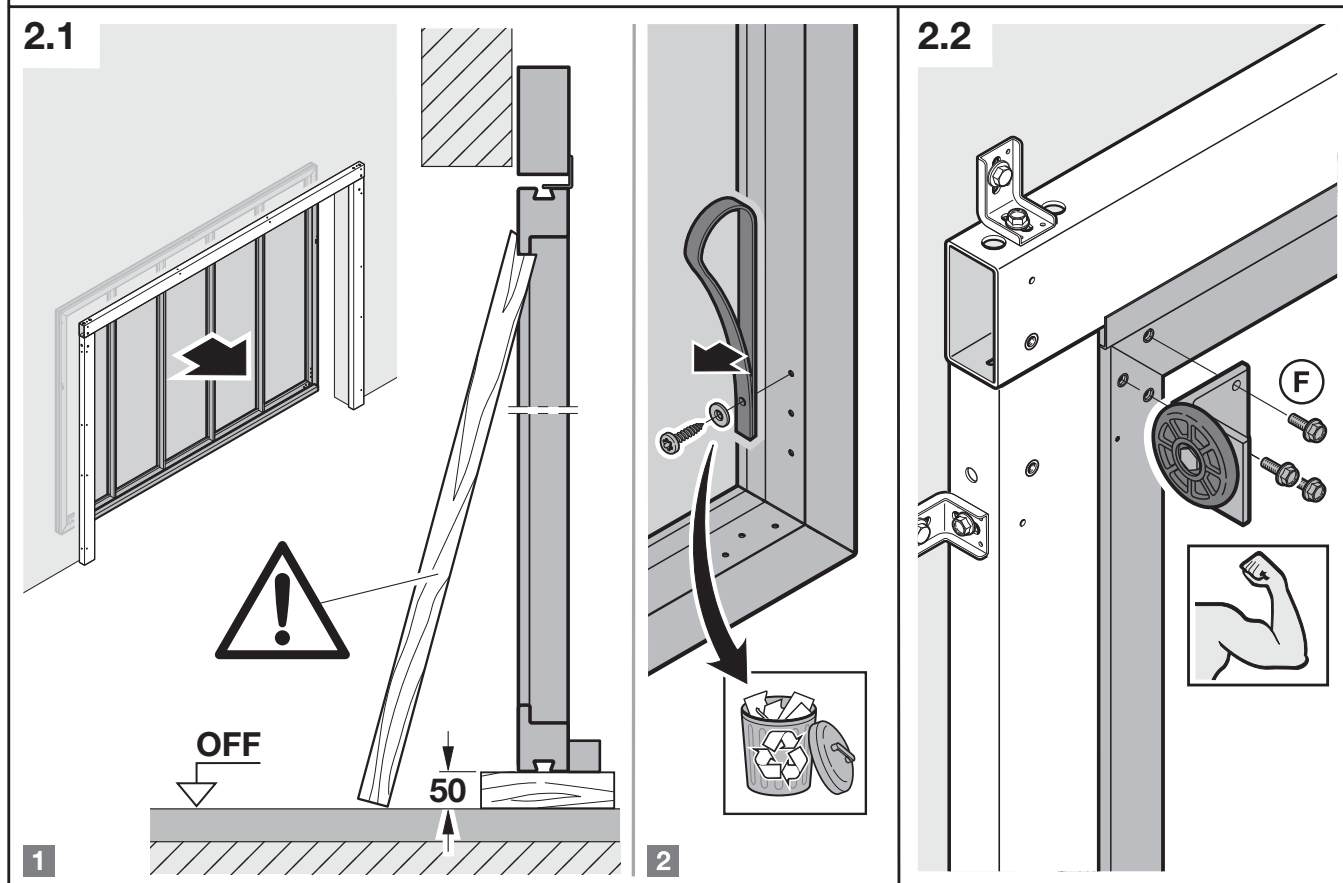
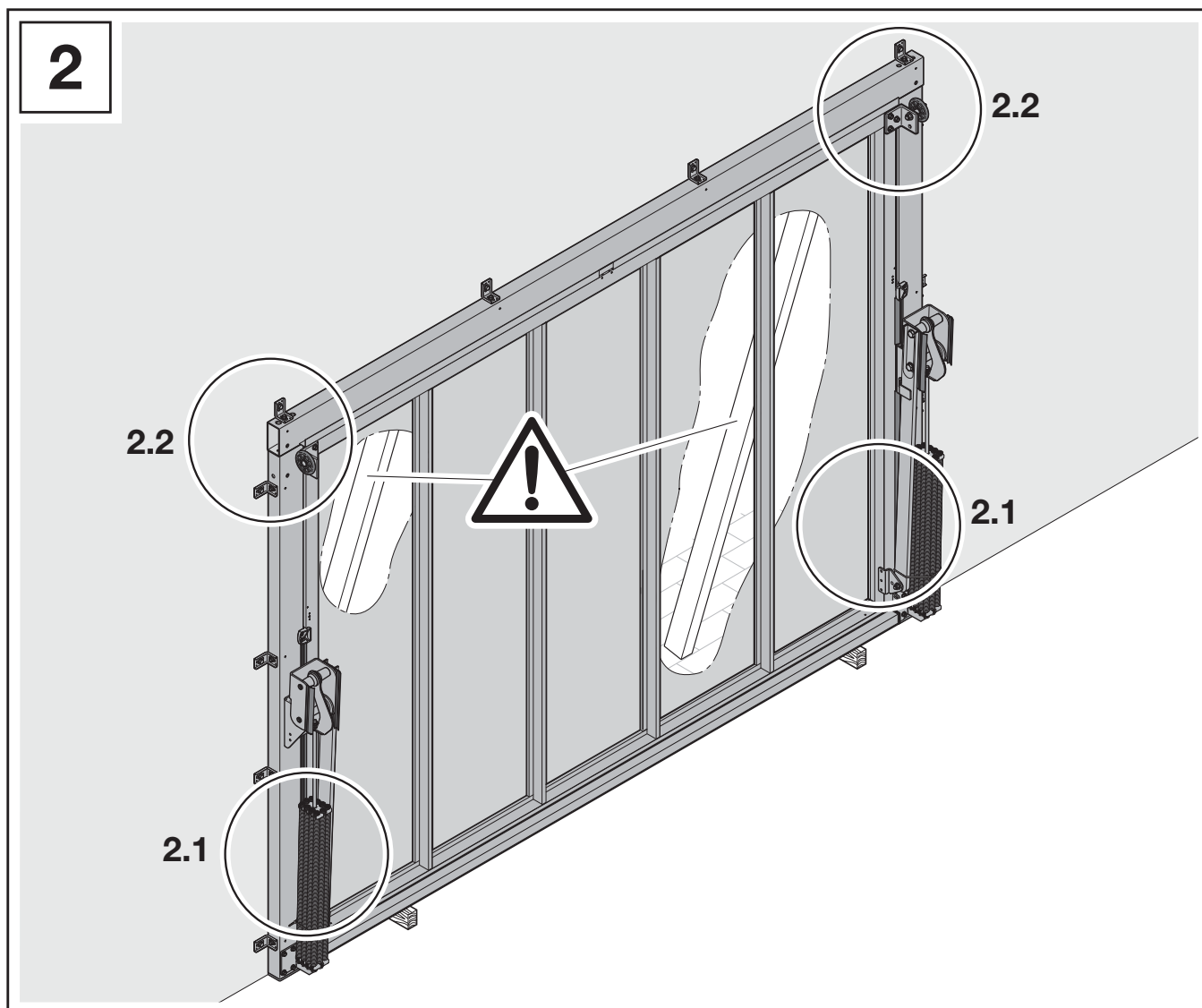

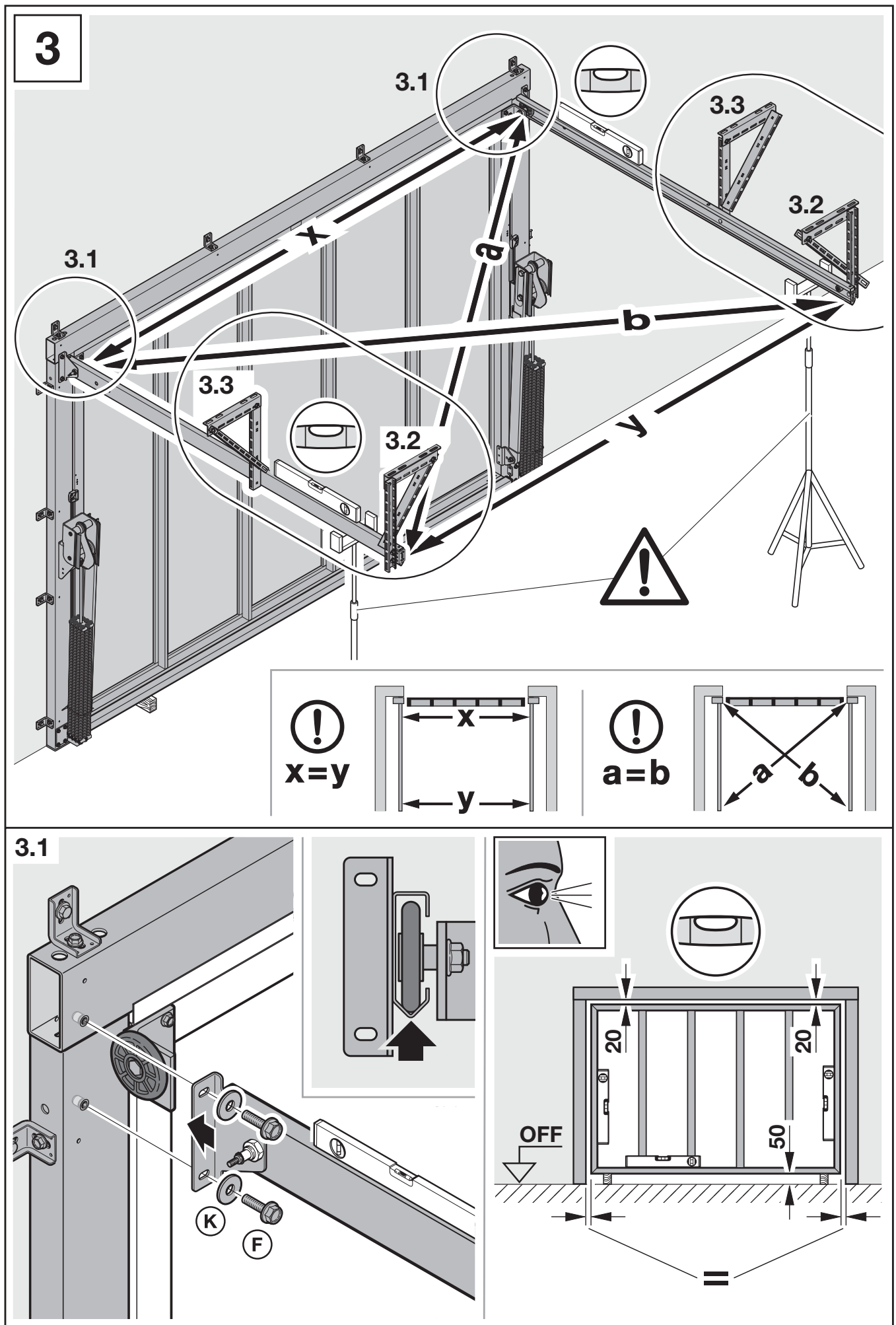

3.2

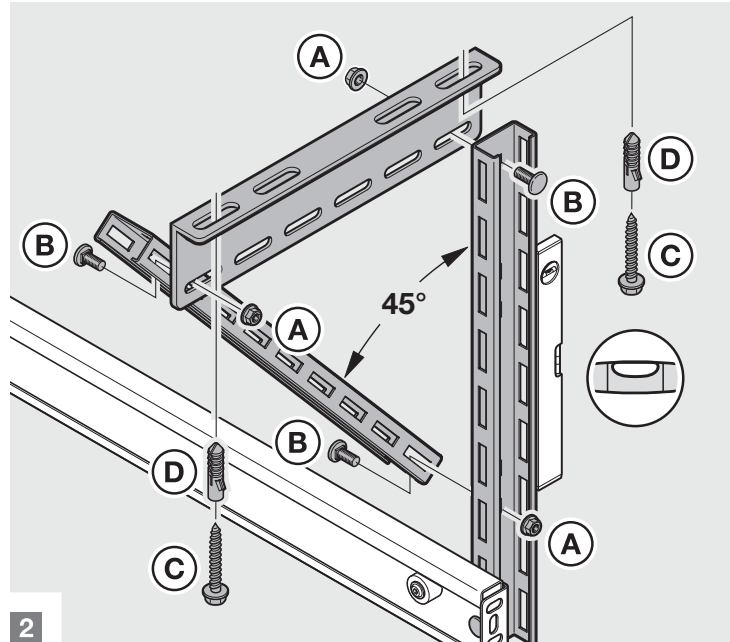
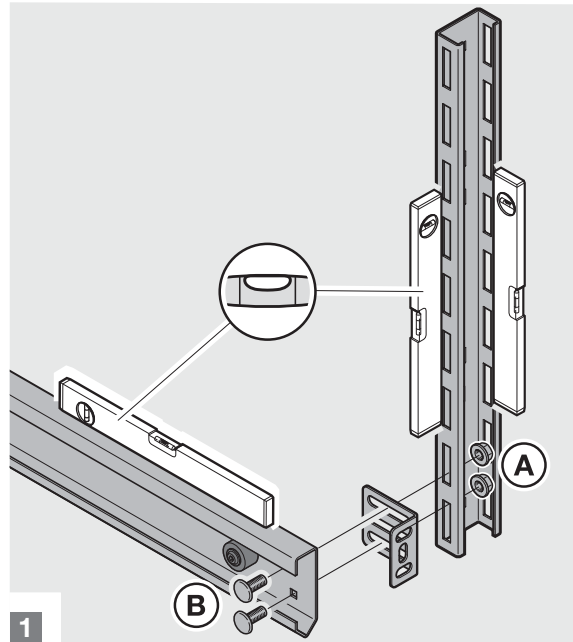
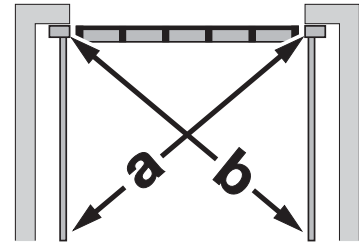
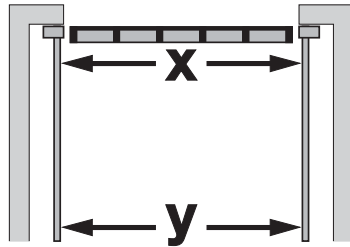

3.3

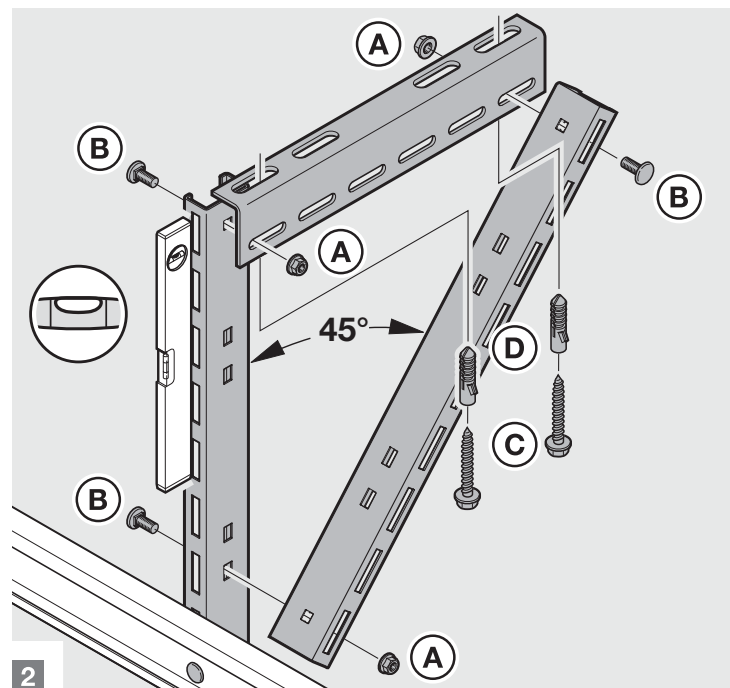
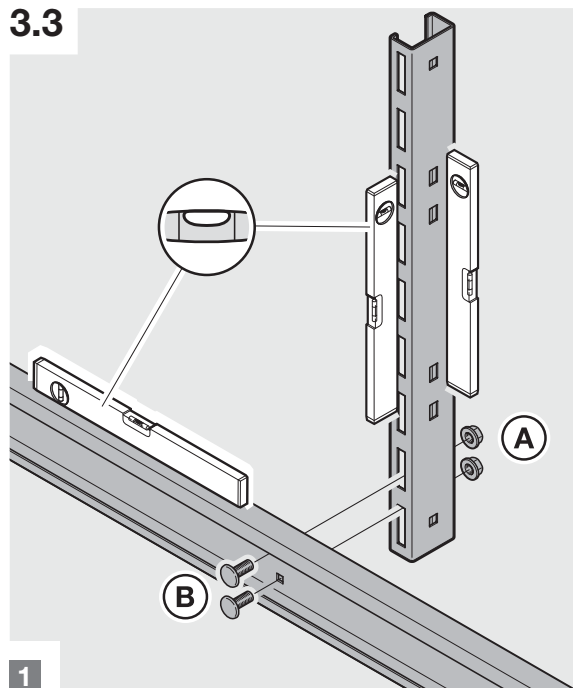

3.4

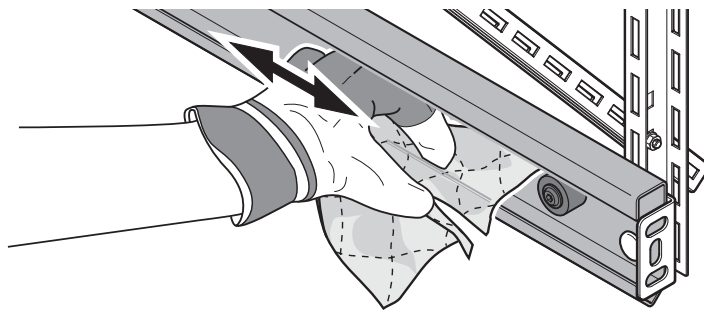

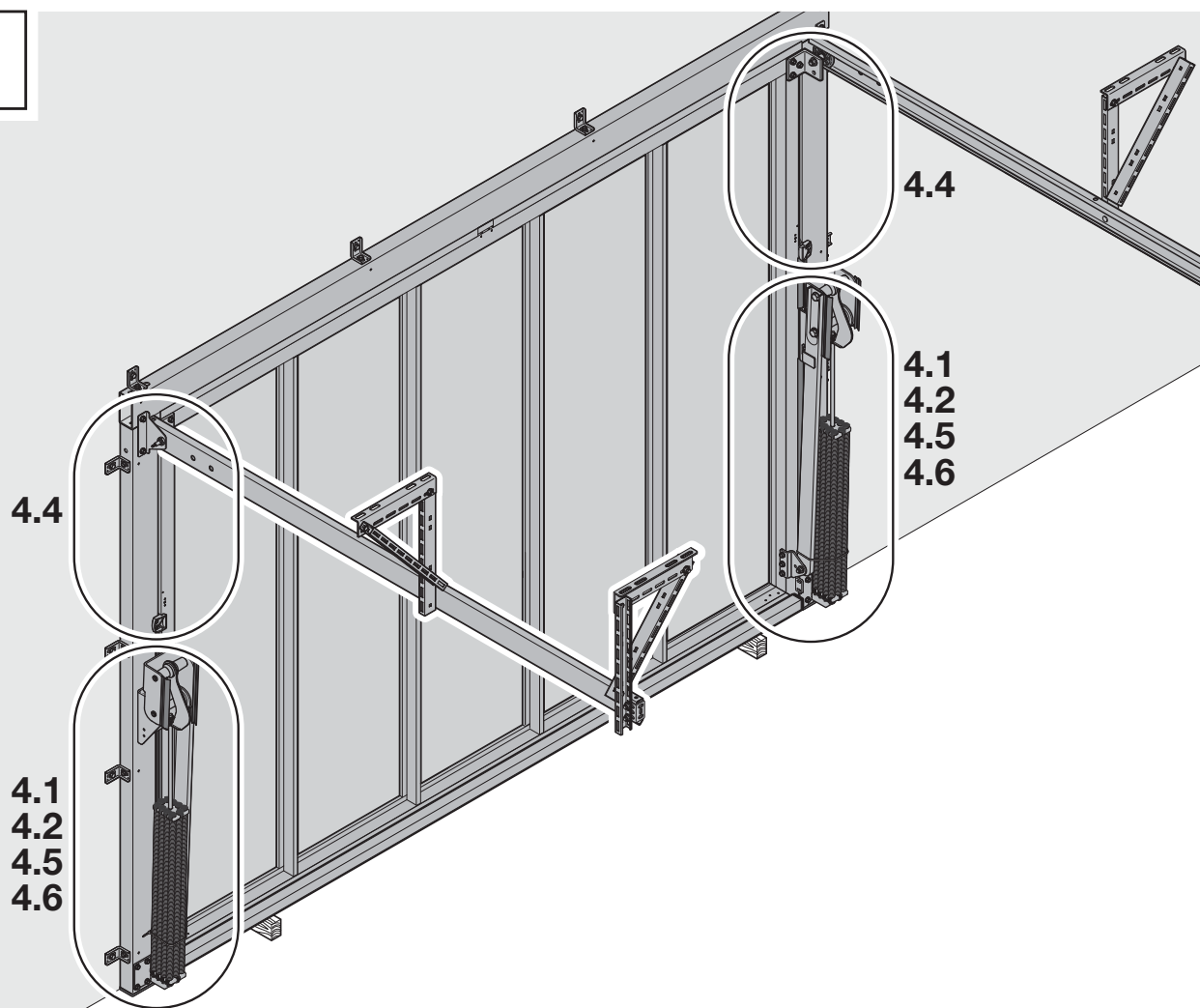
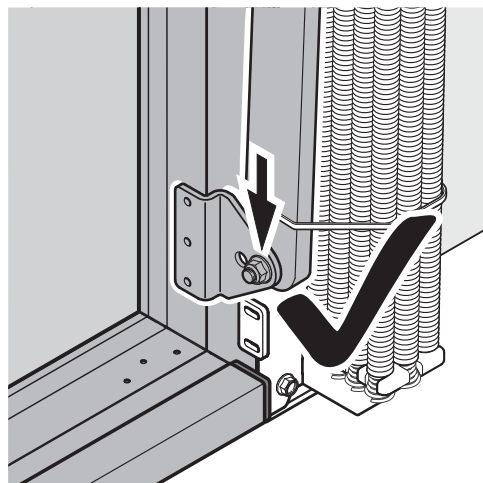
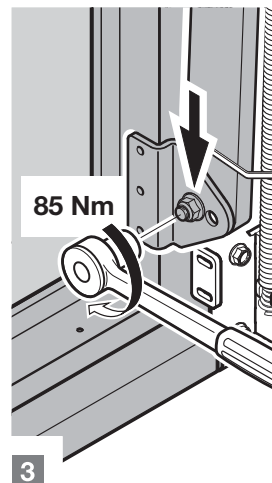
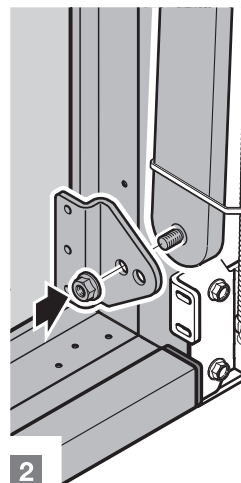
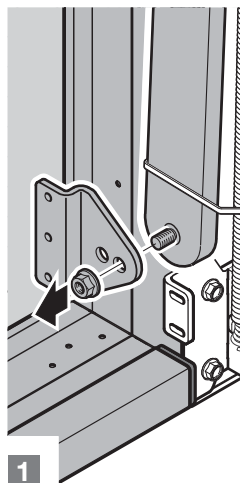
4**4.1a**
 ≤ 20
**4.1b**
 $21-45$

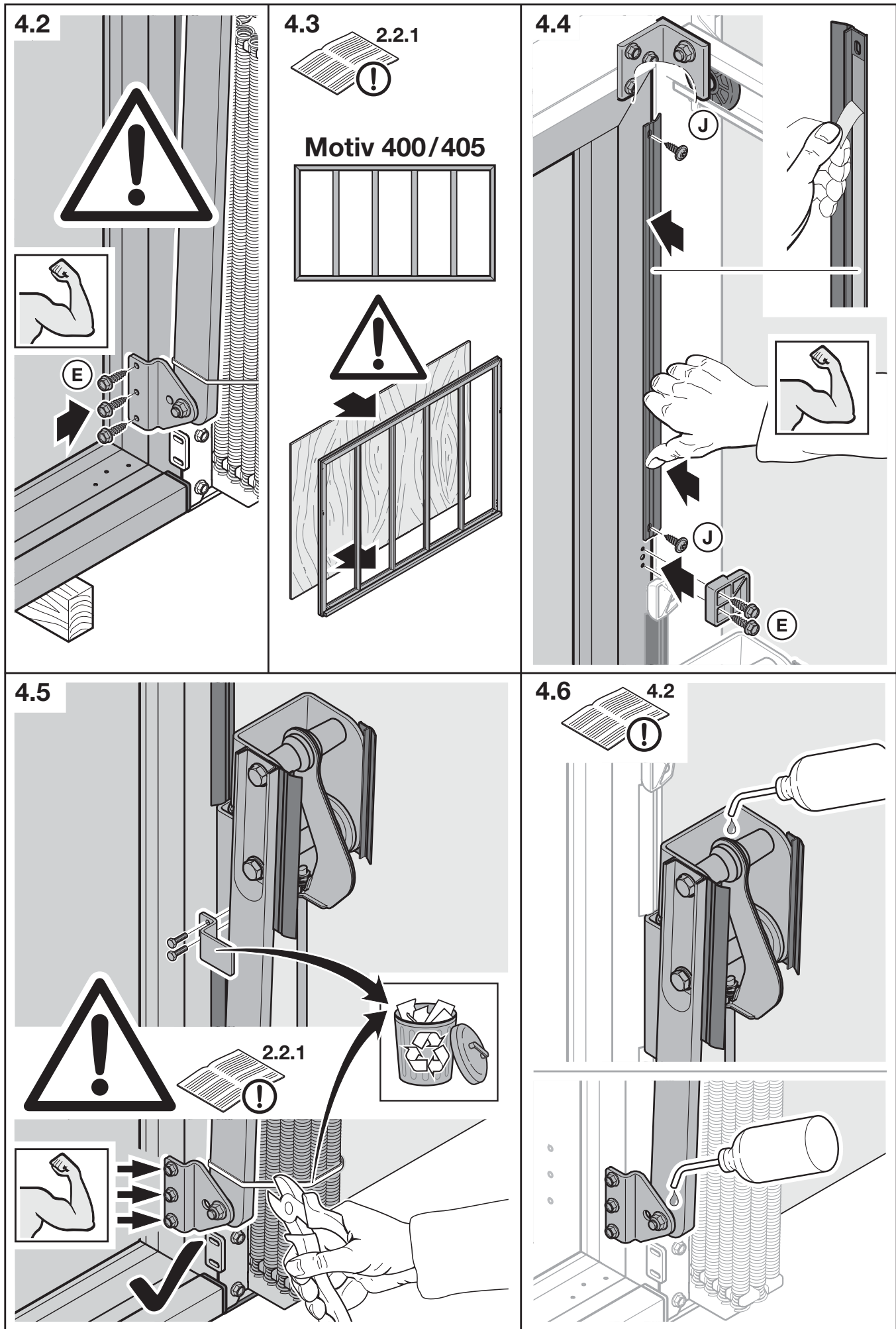

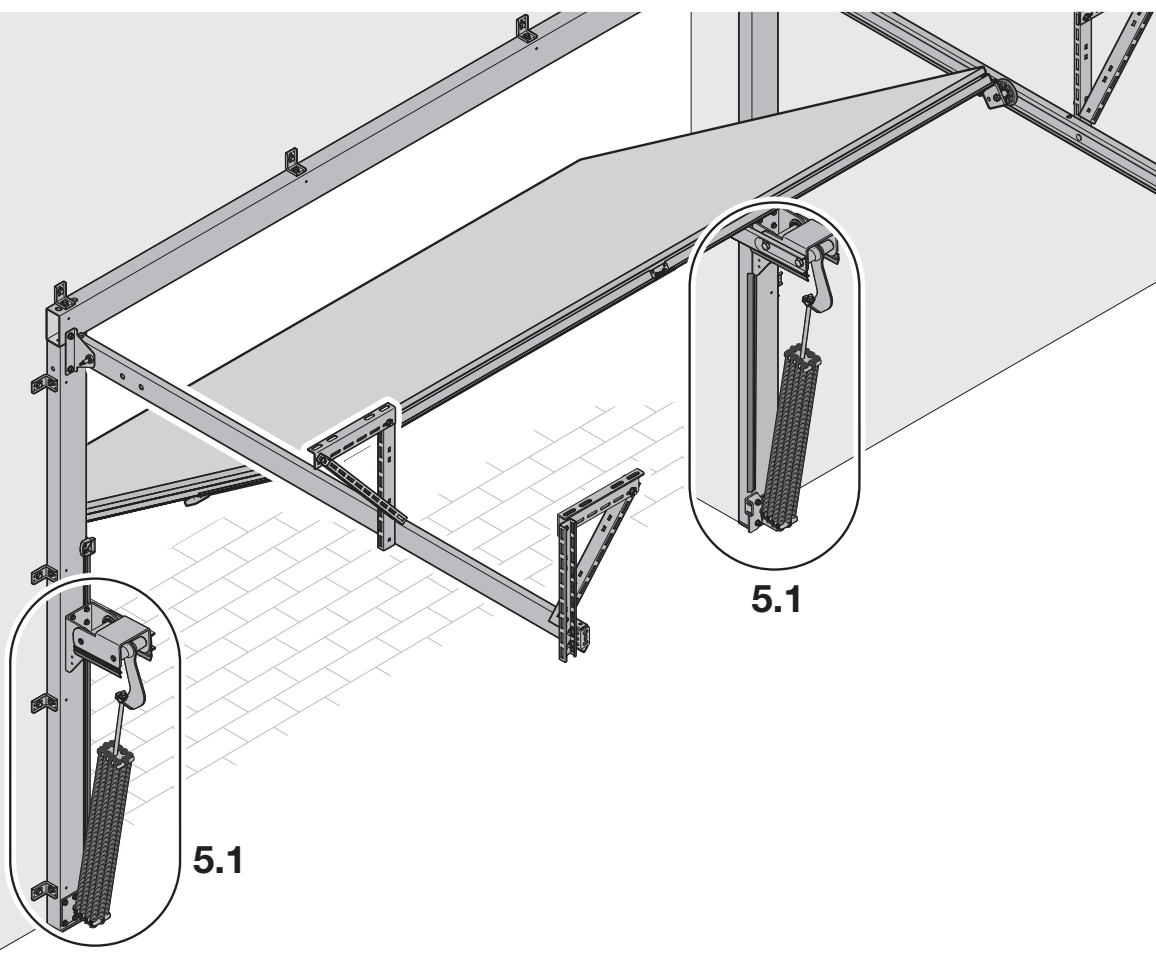
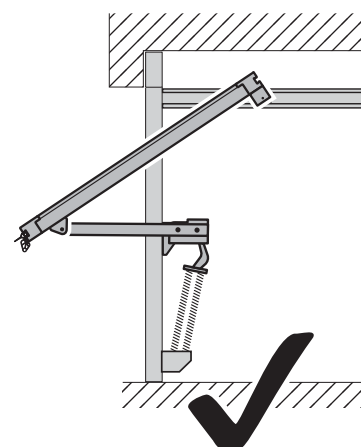
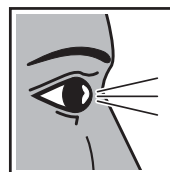
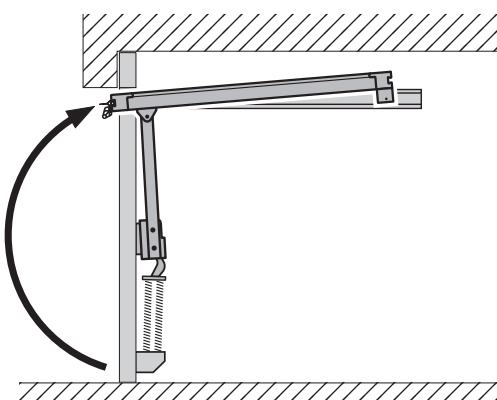
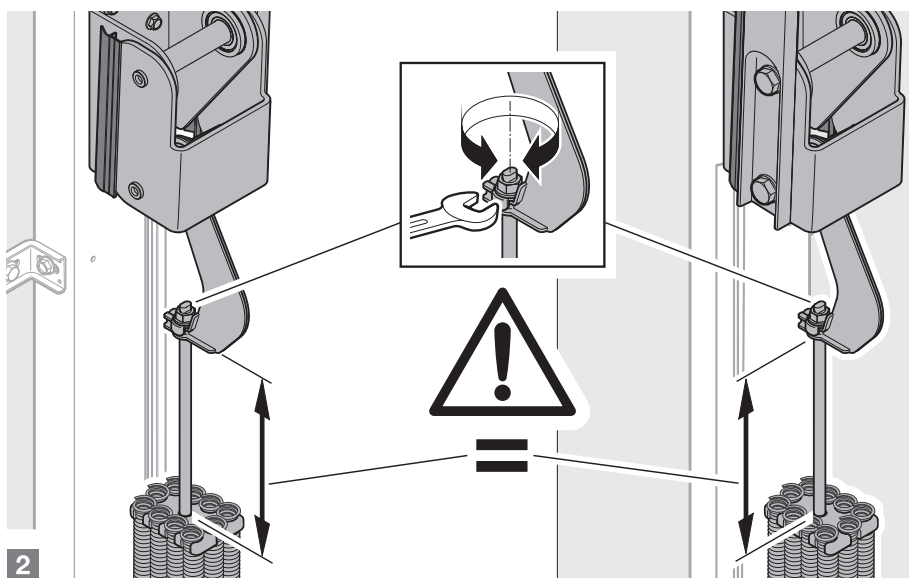
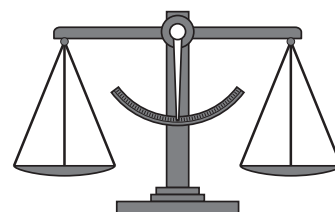
5**5.1****2.3.1****1****2****3**

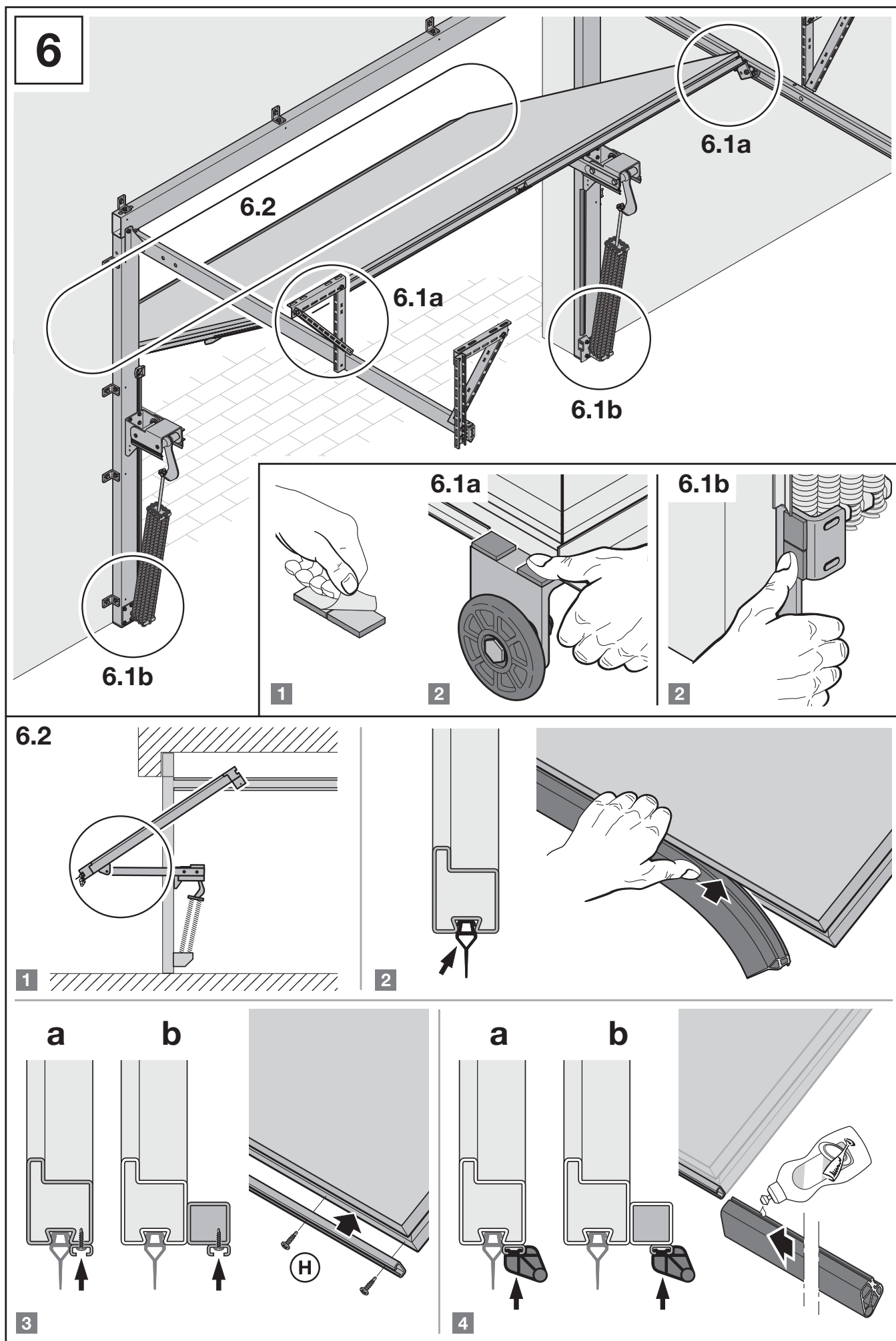

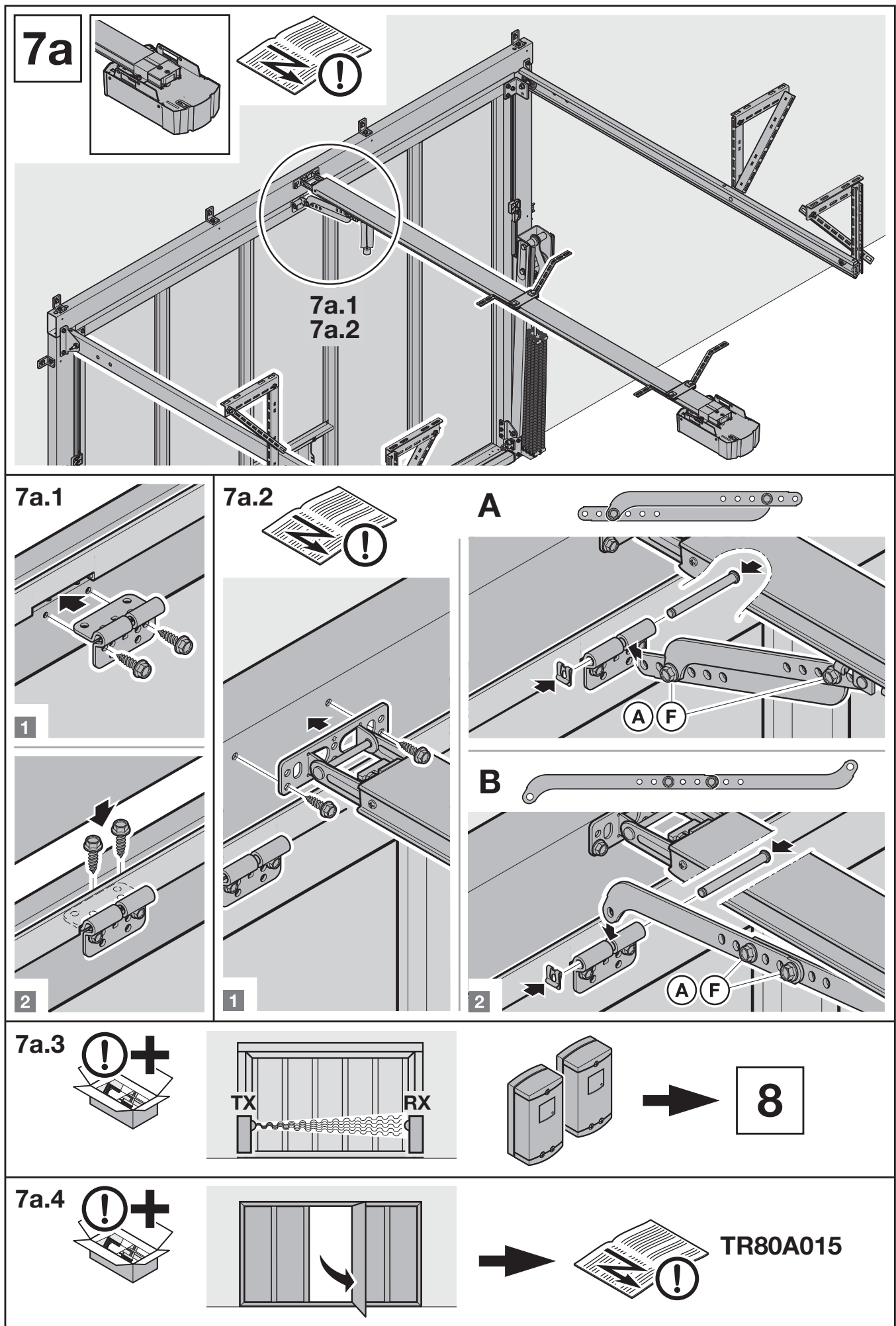

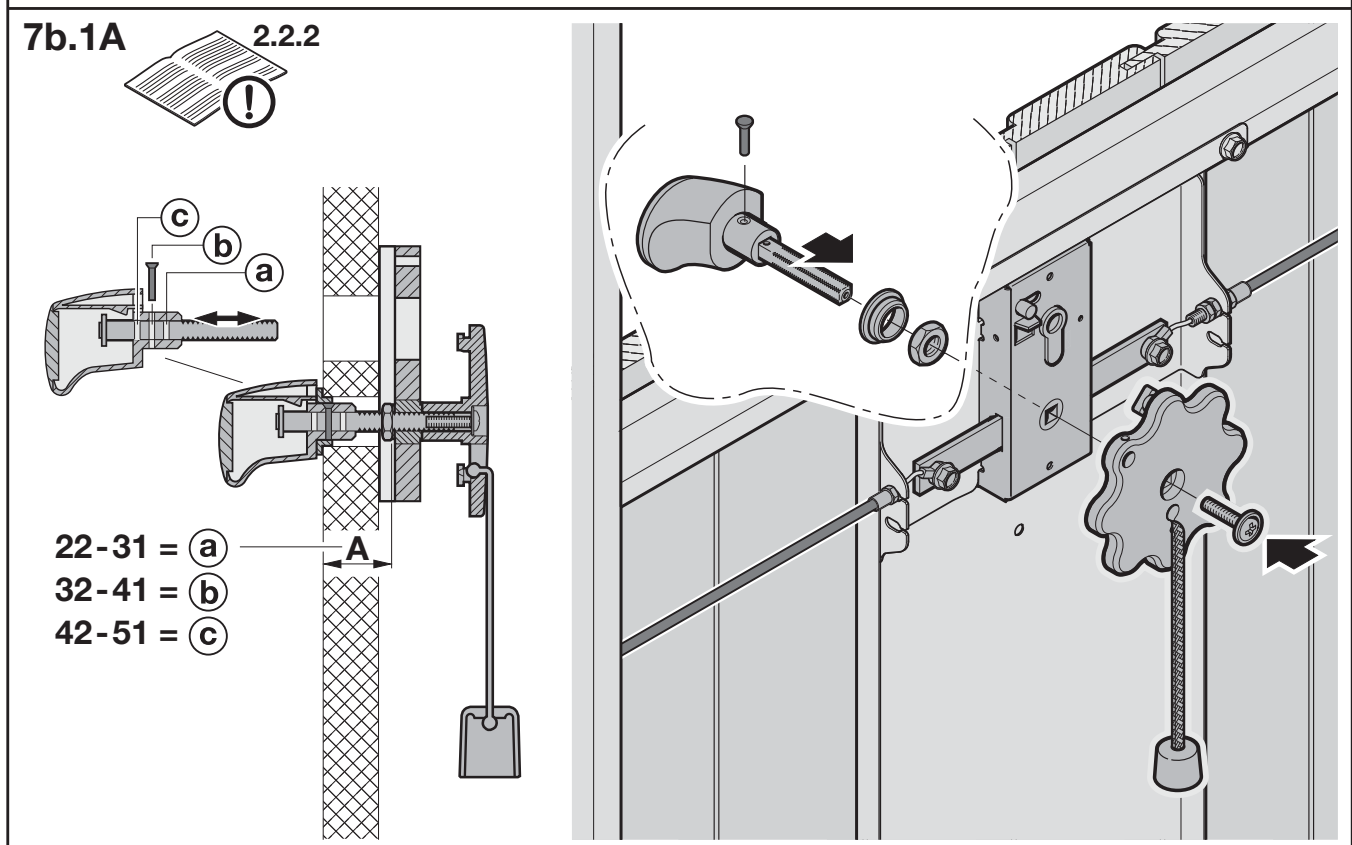
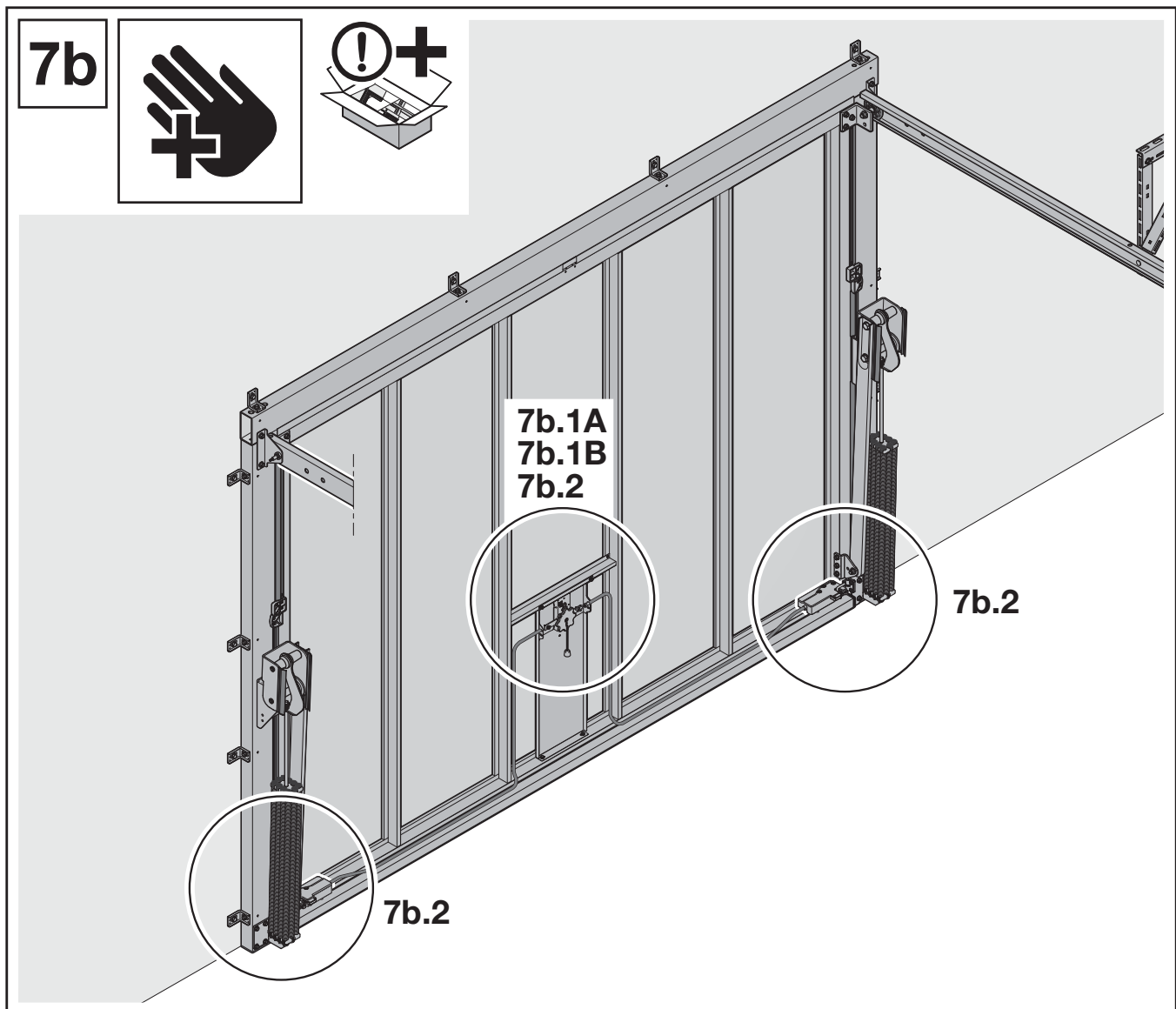

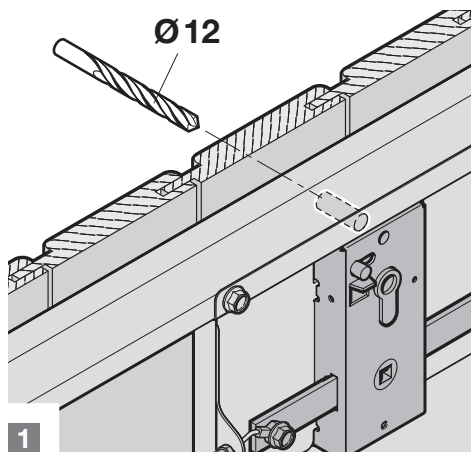
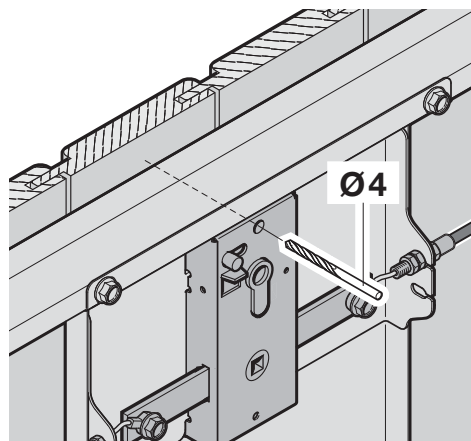
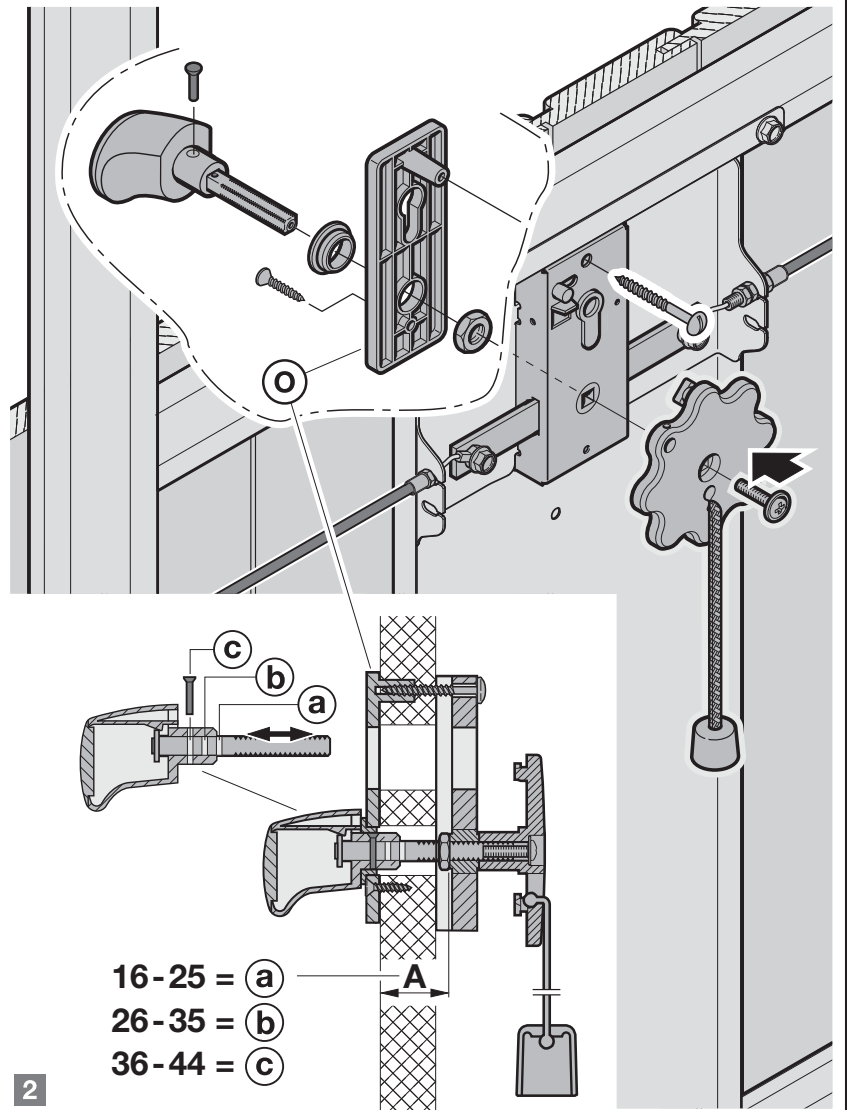
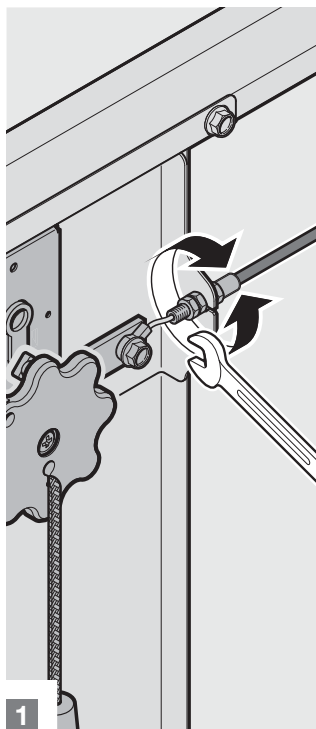
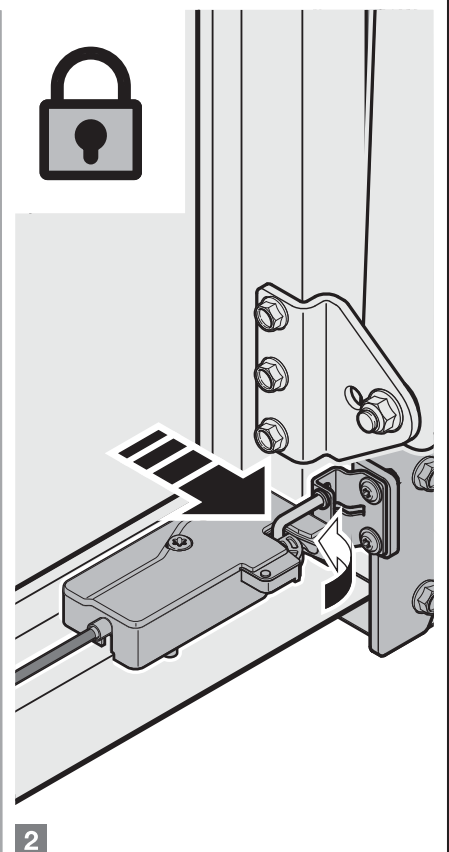
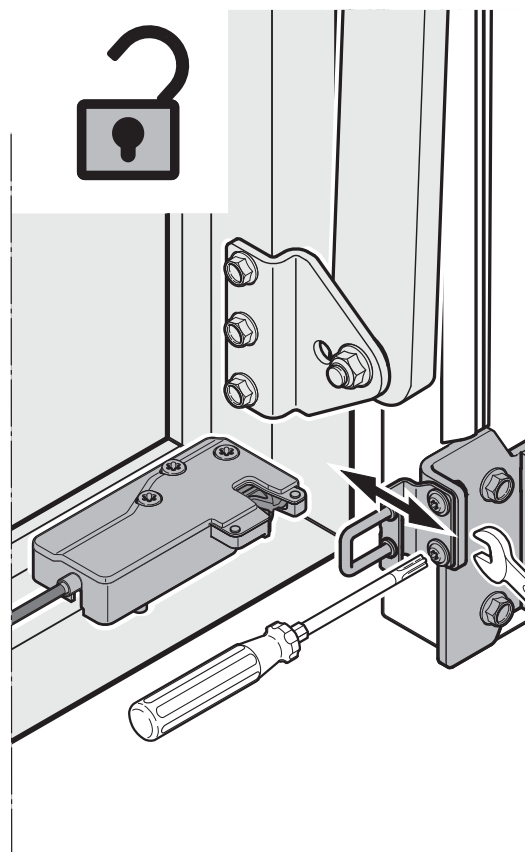
7b.1B**2.2.2****1****2****7b.2****4.6****1****2**

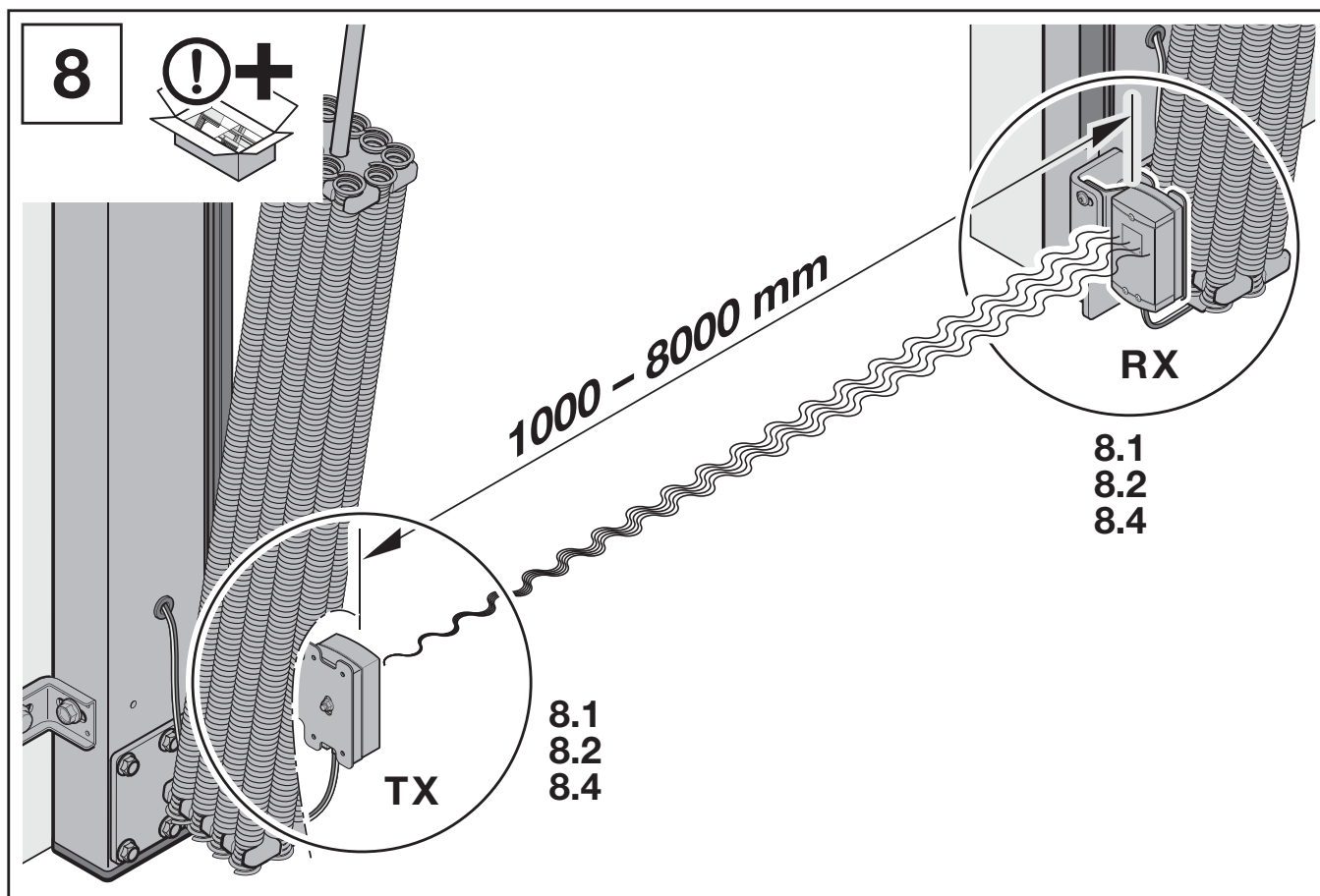

8.1

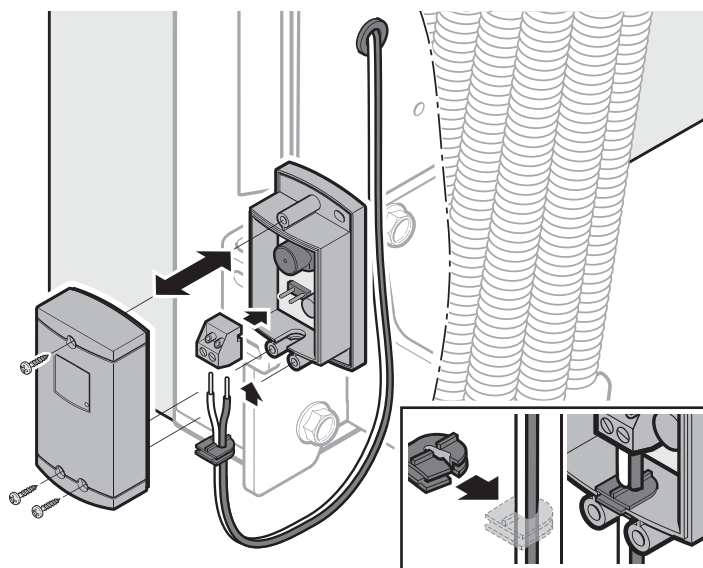
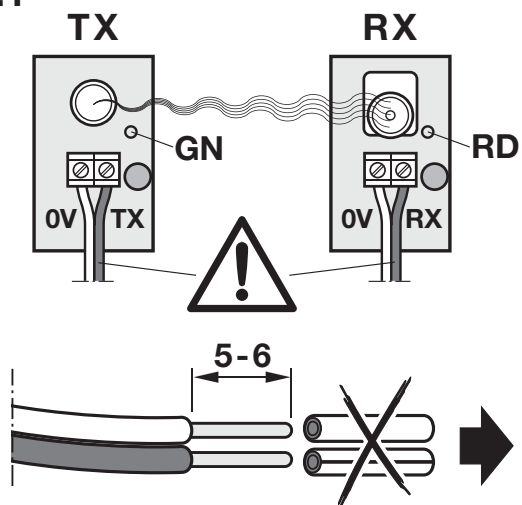

8.2

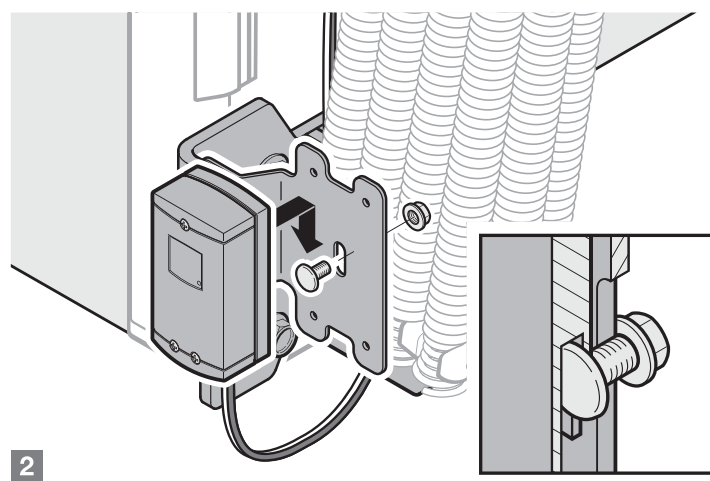
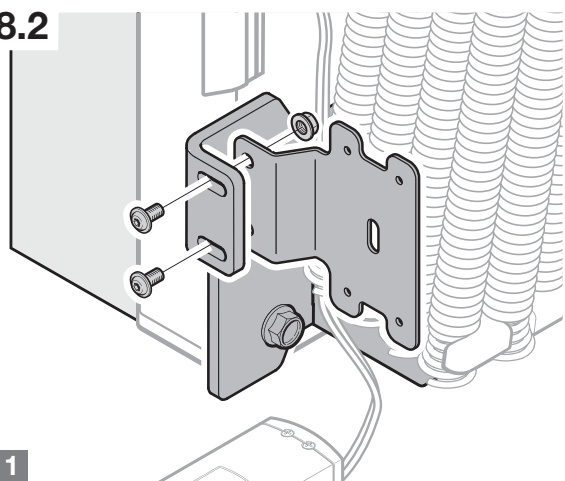

8.3

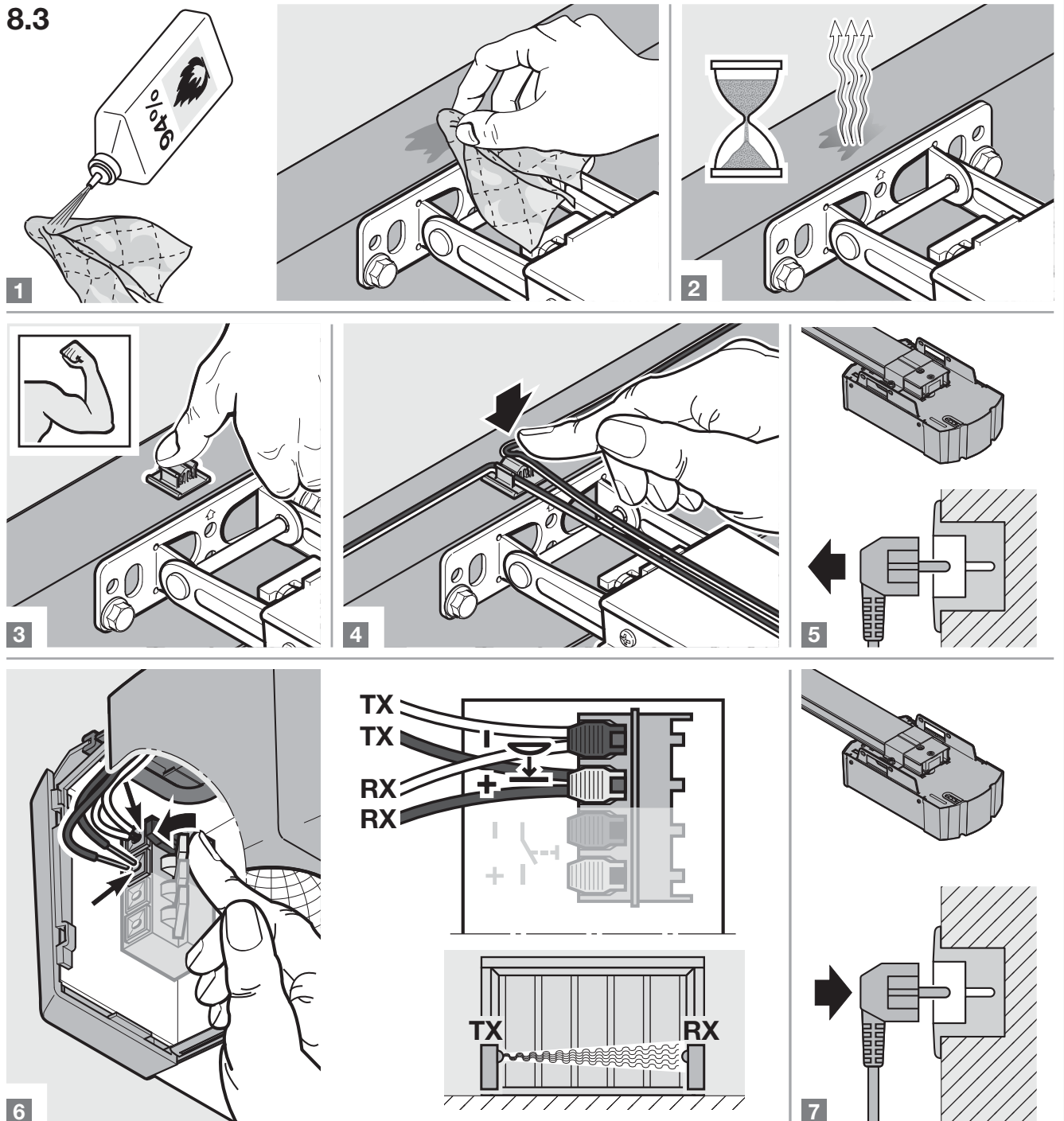

8.4

