



SeceuroGlide Compact Garage Door Fitting Instructions



SeceuroGlide | Sectional Compact
Rear Mounted System

Fitter's Information Pack - SeceuroGlide Sectional Compact

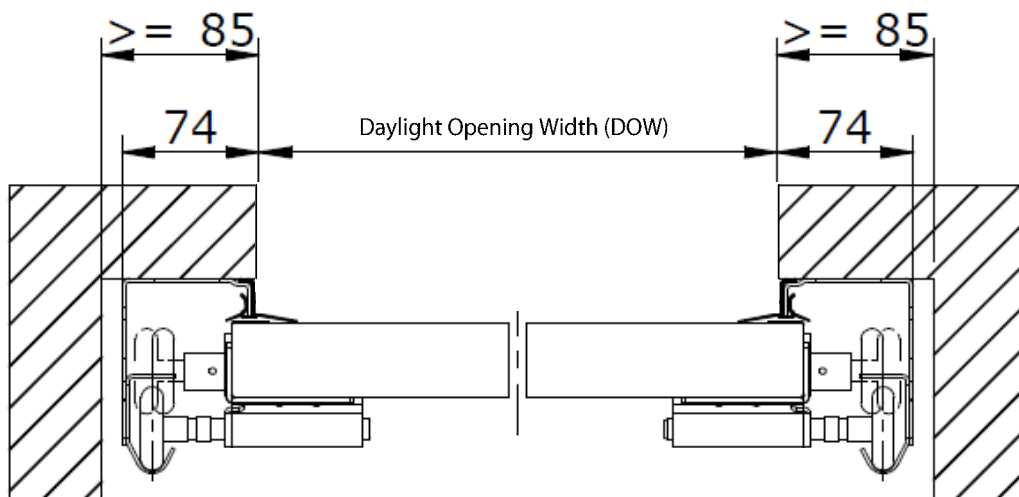
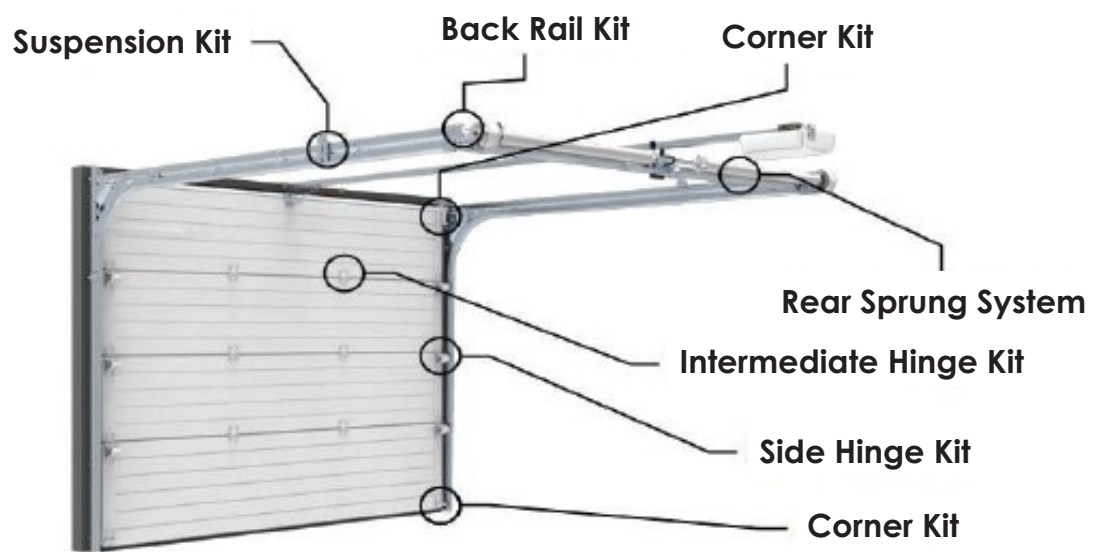

✓ EN 12604
 ✓ EN 12453
 ✓ EN 13241

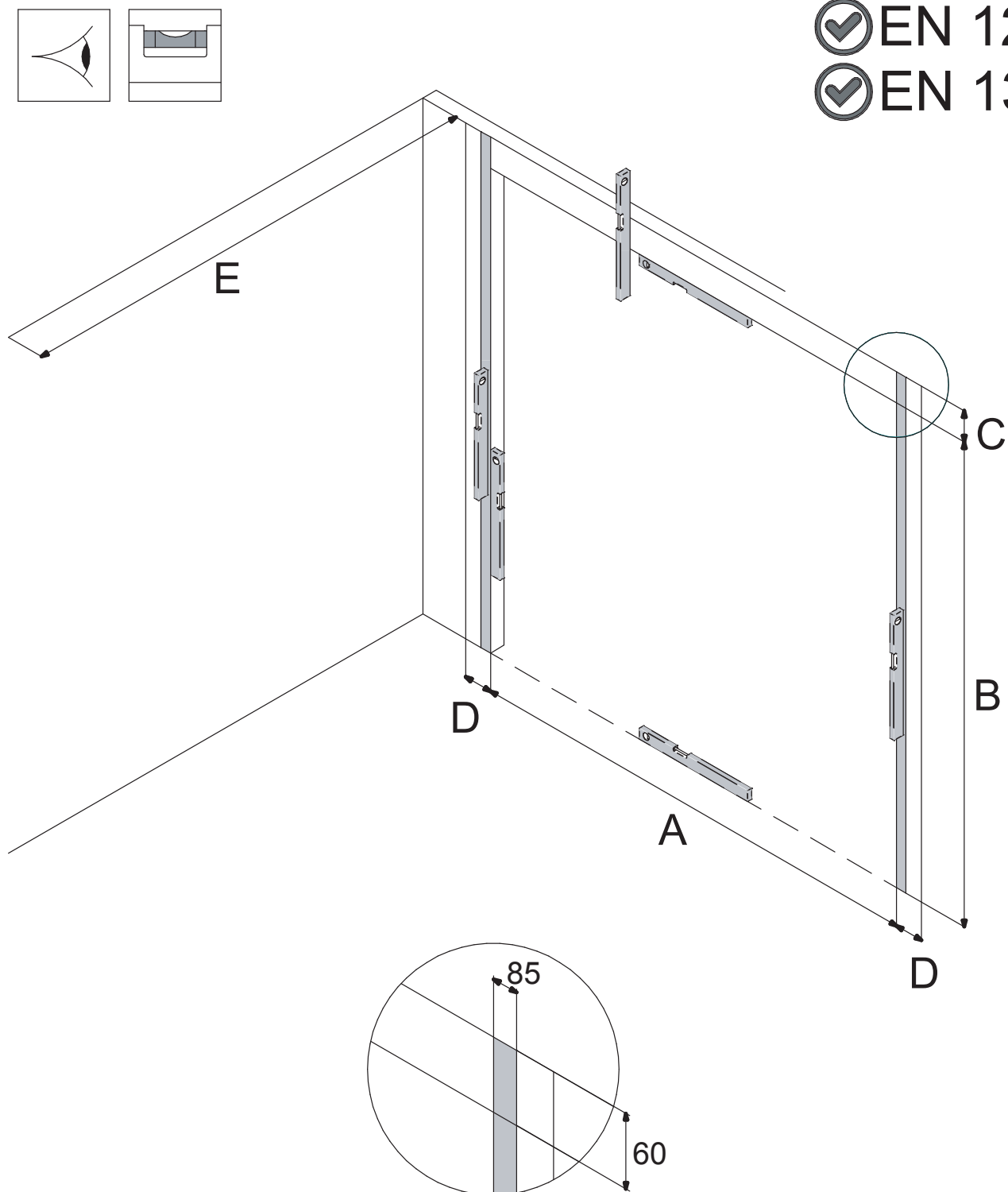

A	B	C	D	E
DLW	DLH	FHR	FSR	FMD
Daylight Width	Daylight Height	Free Head Room	Free Side Room	Free Mounting Depth

Seals are 100mm larger than needed,
cut down to suit the opening

Slide weather seals onto
vertical tracks

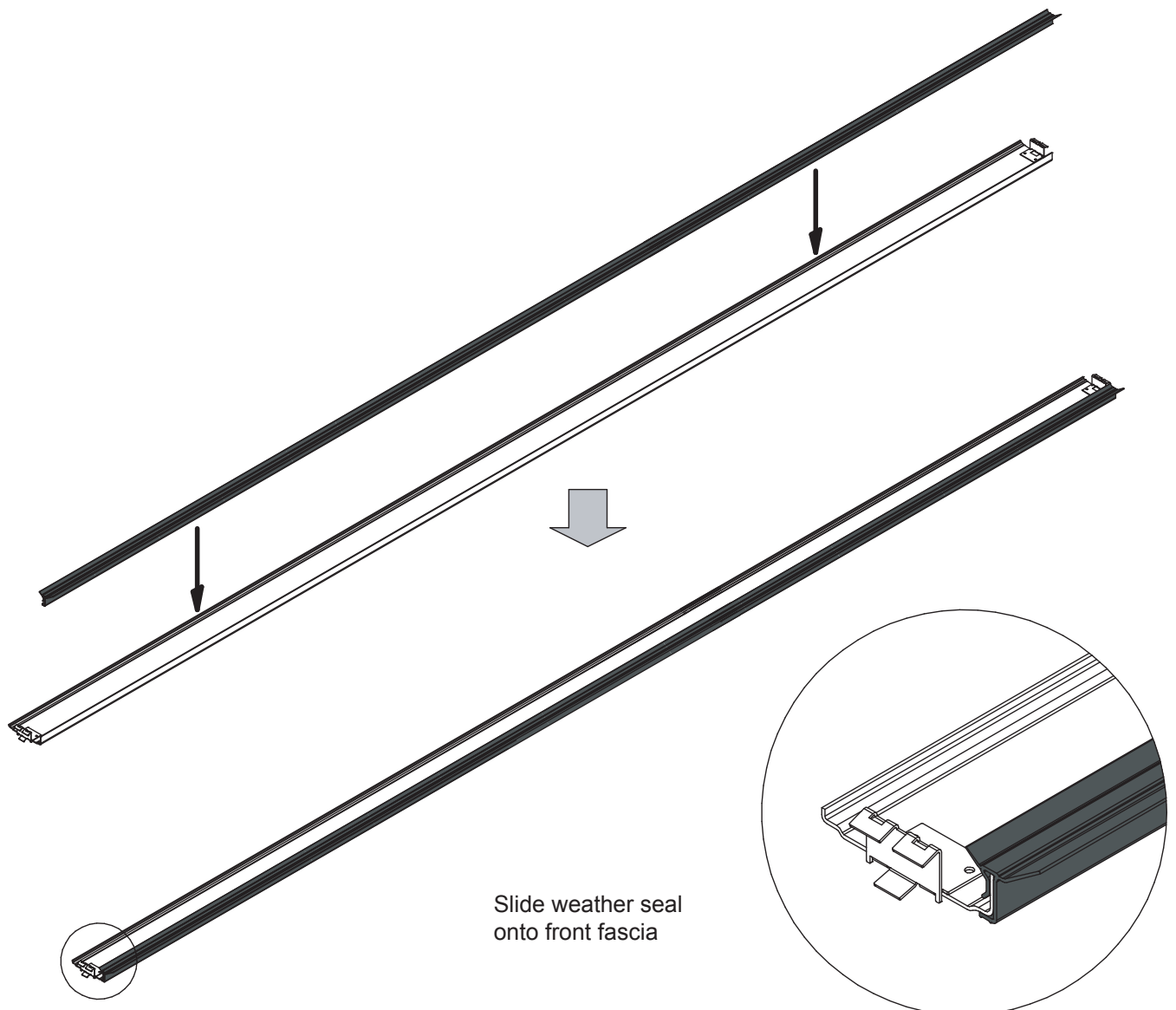
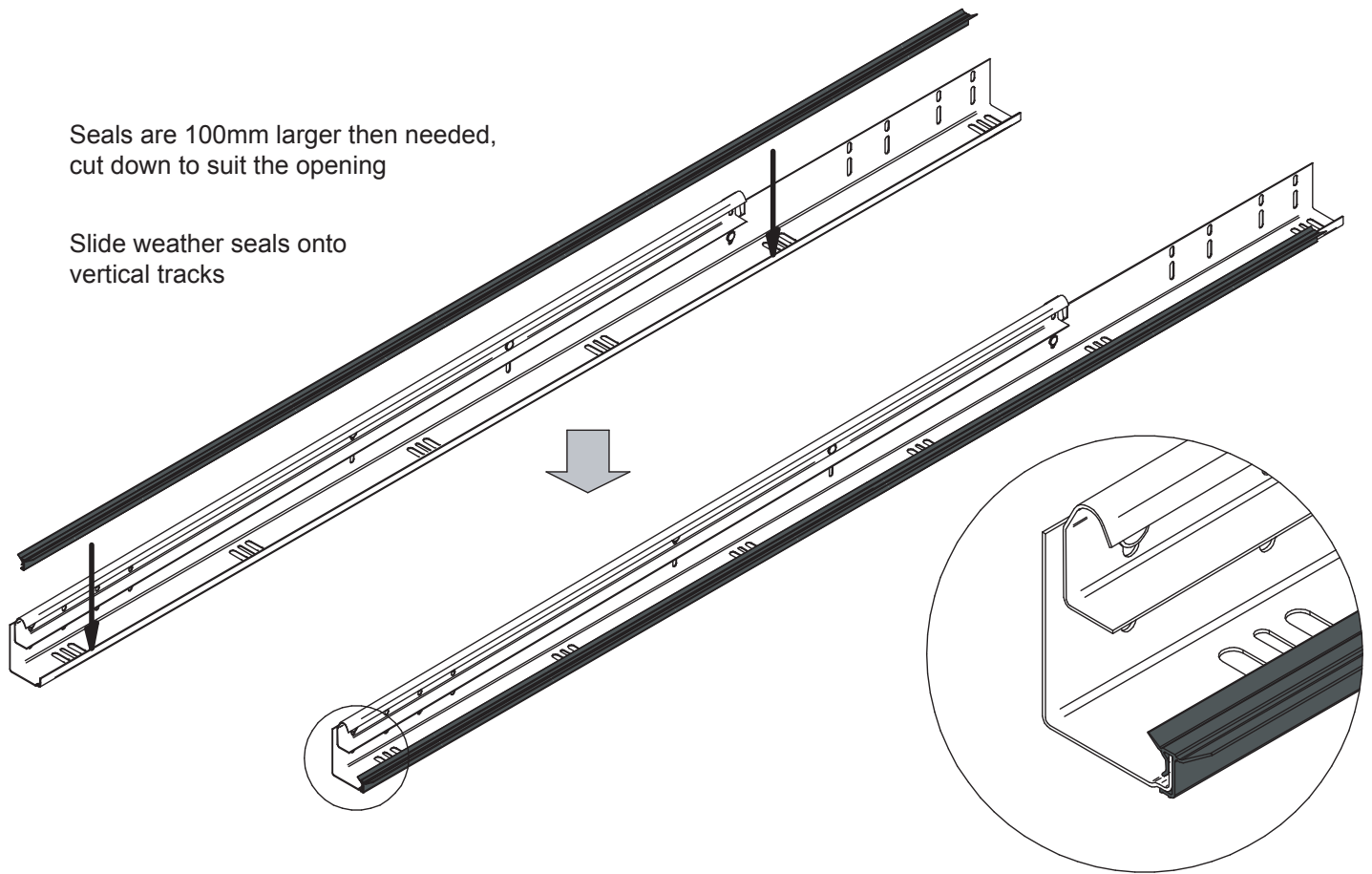

Slide weather seal
onto front fascia

Clamp tracks to the wall

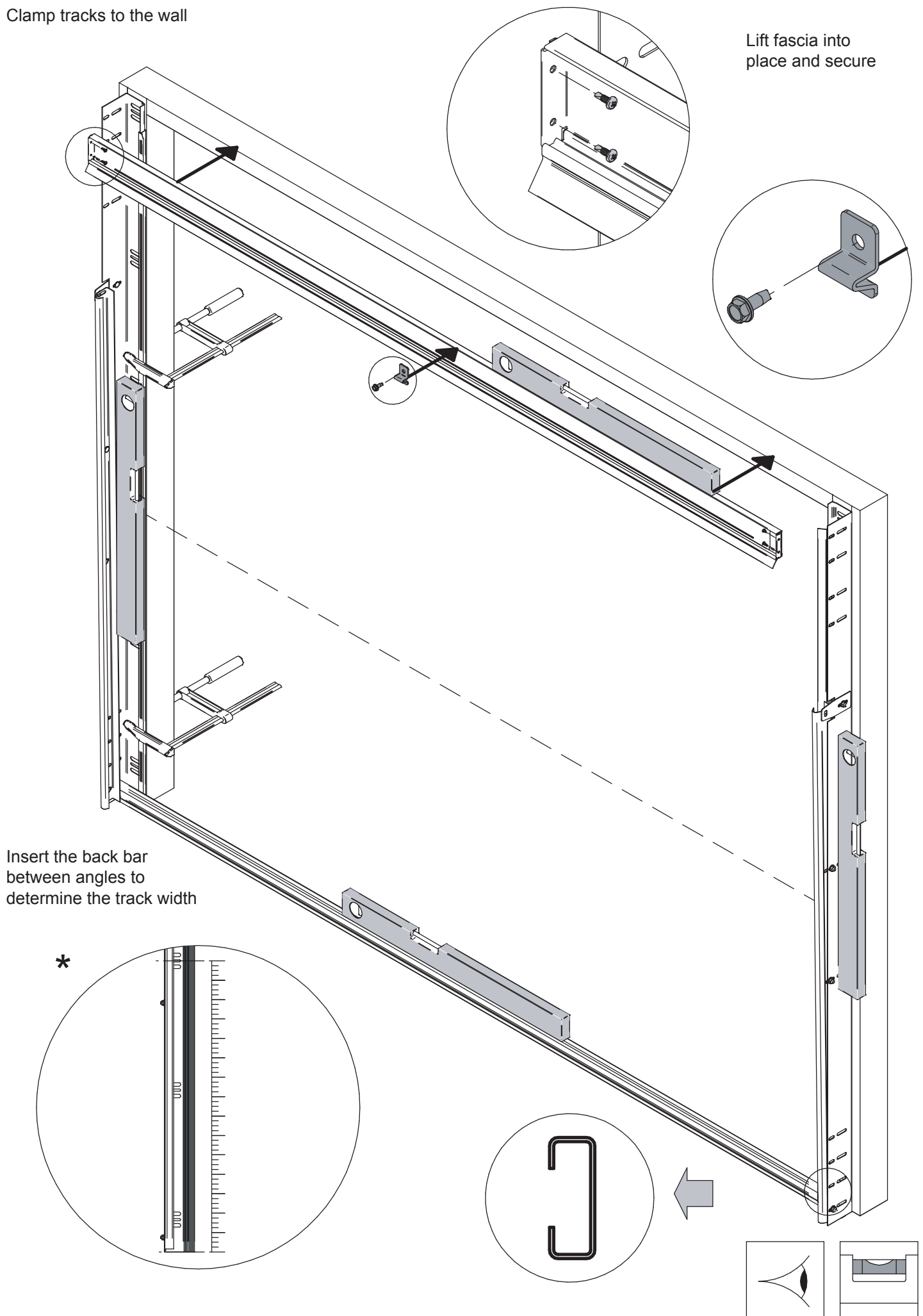

Secure the tracks to the wall with the appropriate fixings shown below

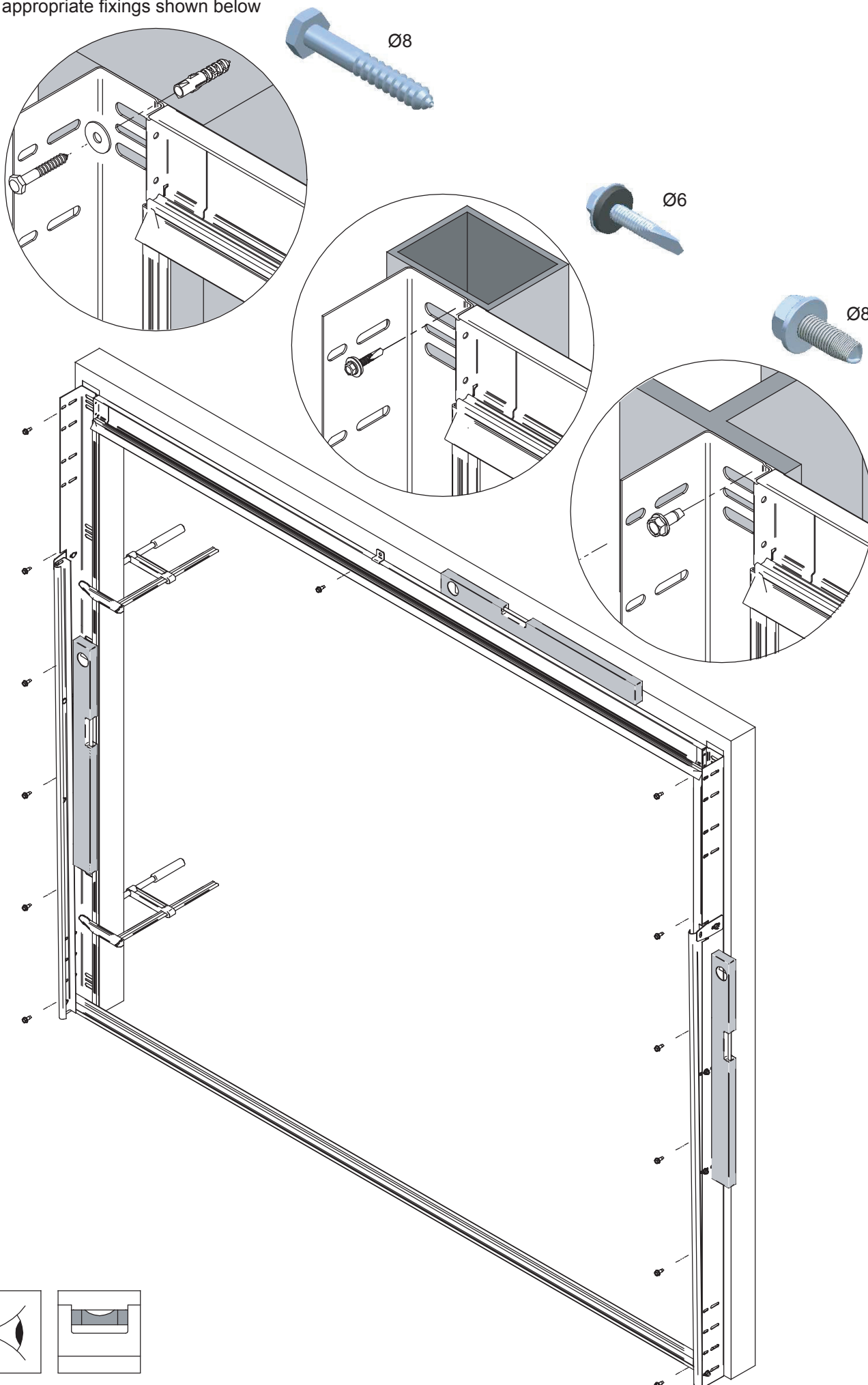

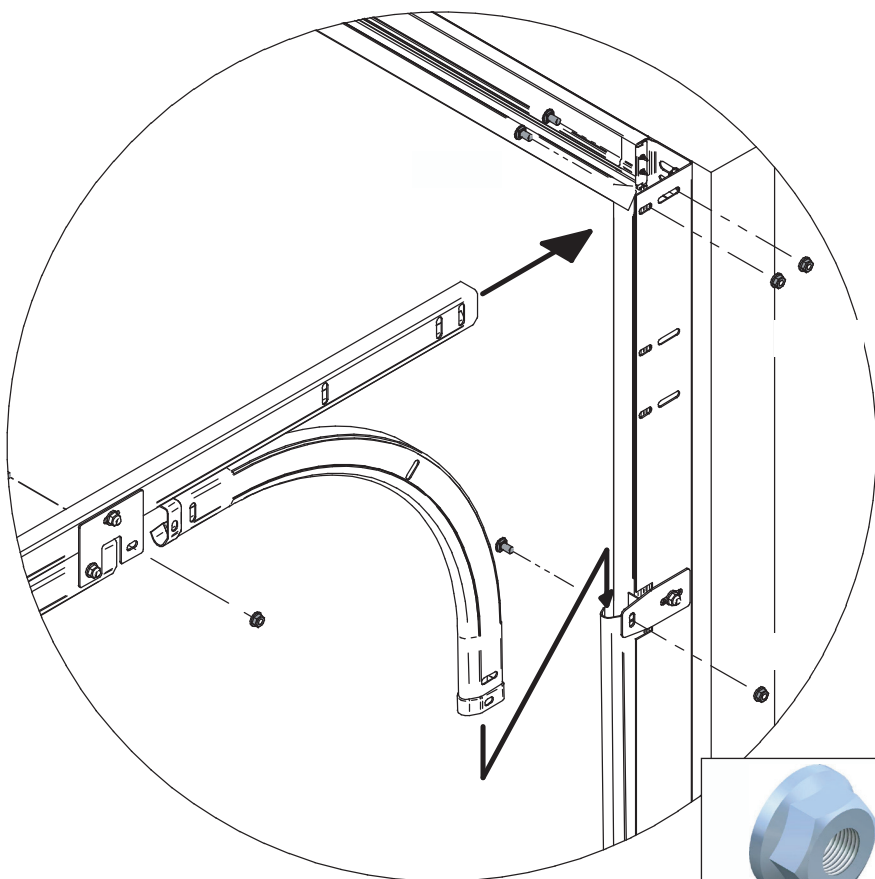
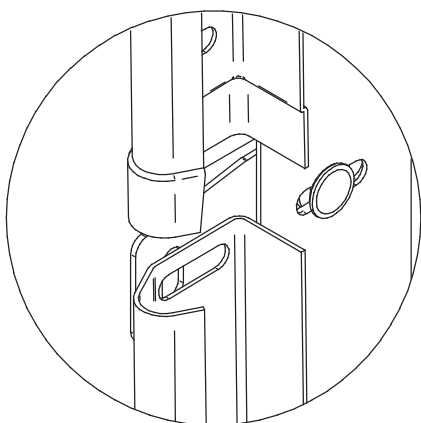
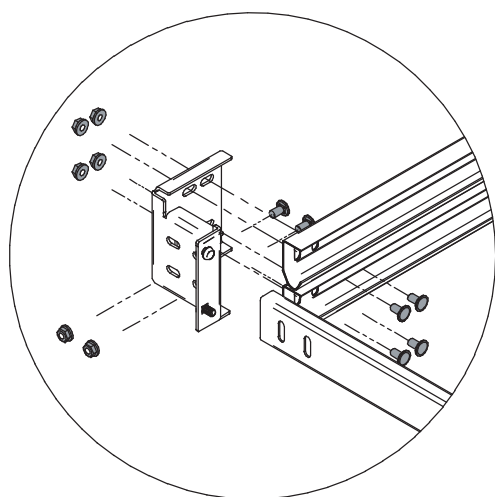
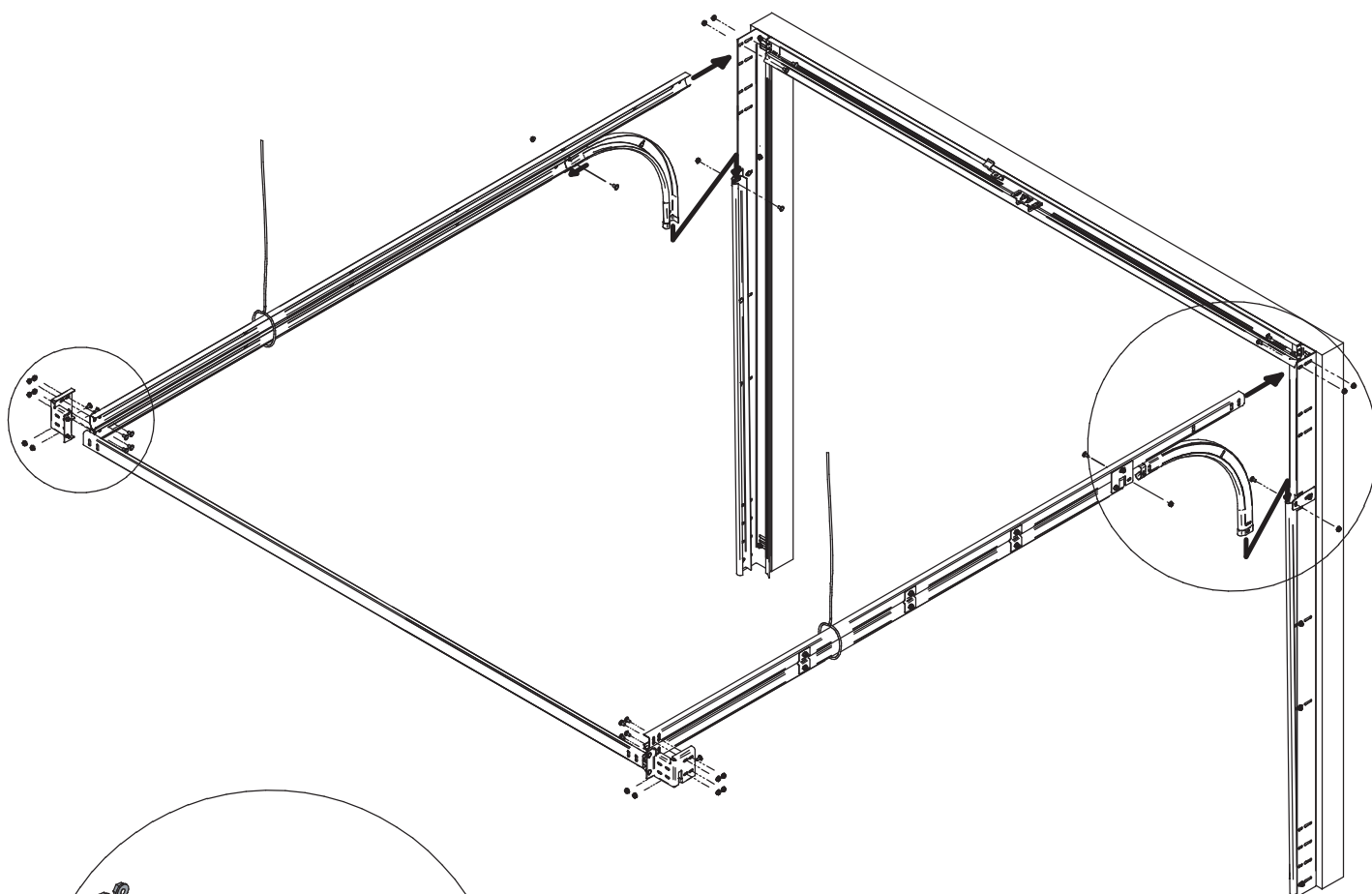

Bolt both horizontal tracks to the vertical tracks securely. Fix the rear bar to secure the horizontal tracks at the rear

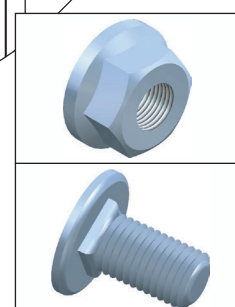
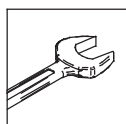

Secure front pulley
plates to frame

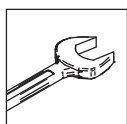
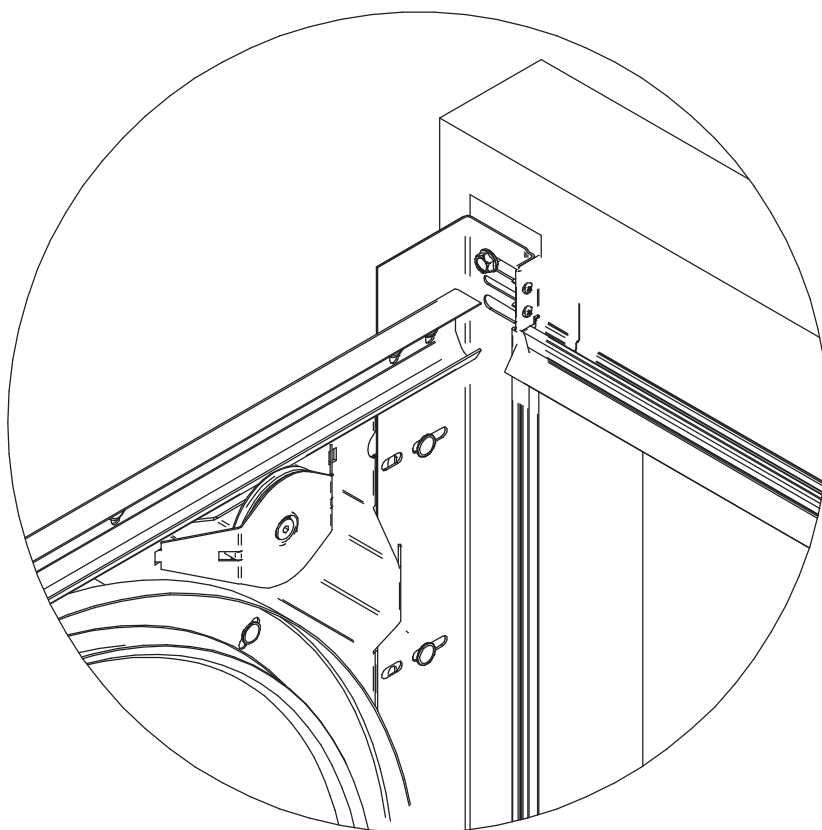
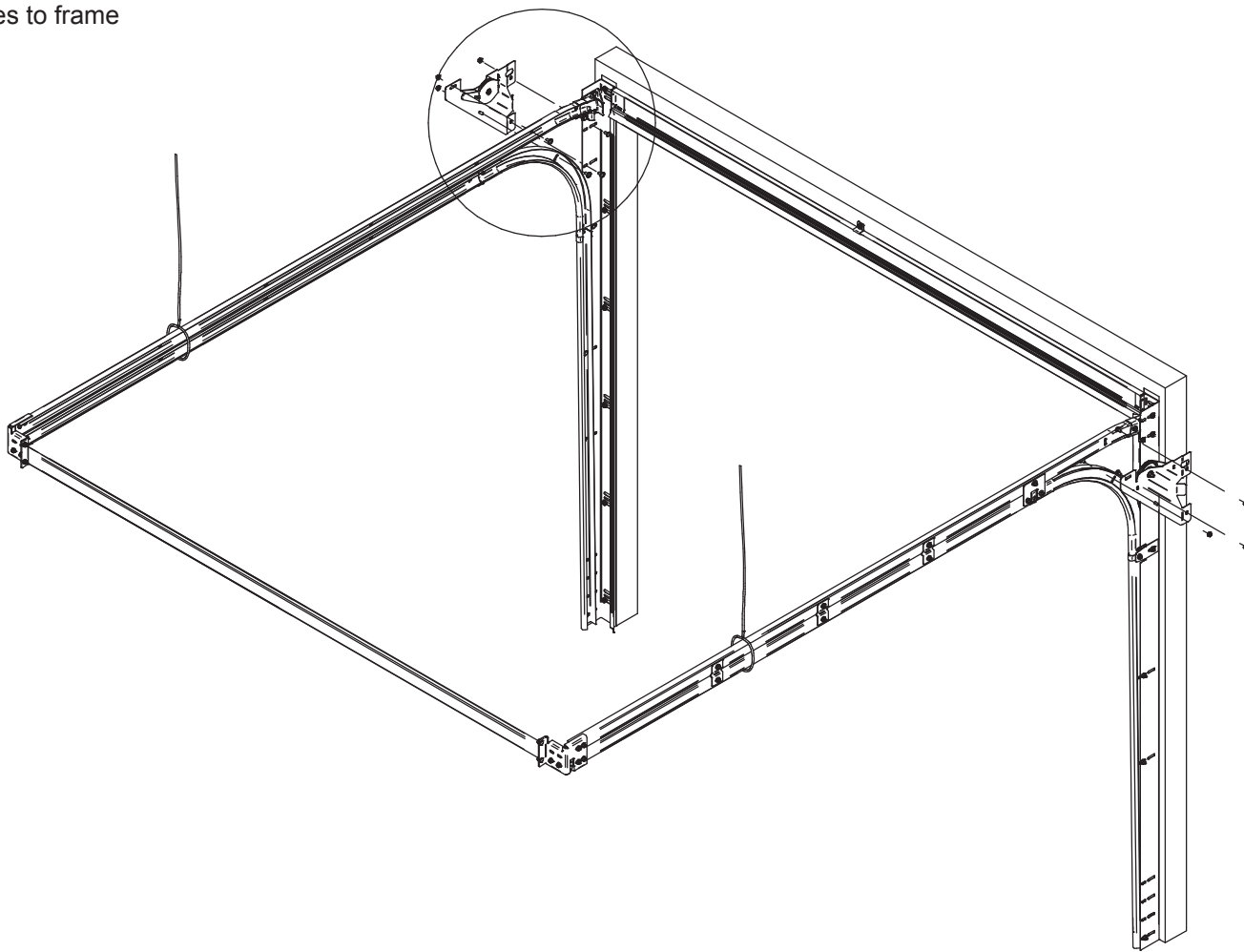

Measure from corner to corner to determine if the horizontal track area is square, adjust accordingly. Before securing the L shape hangers, ensure the horizontal tracks are level

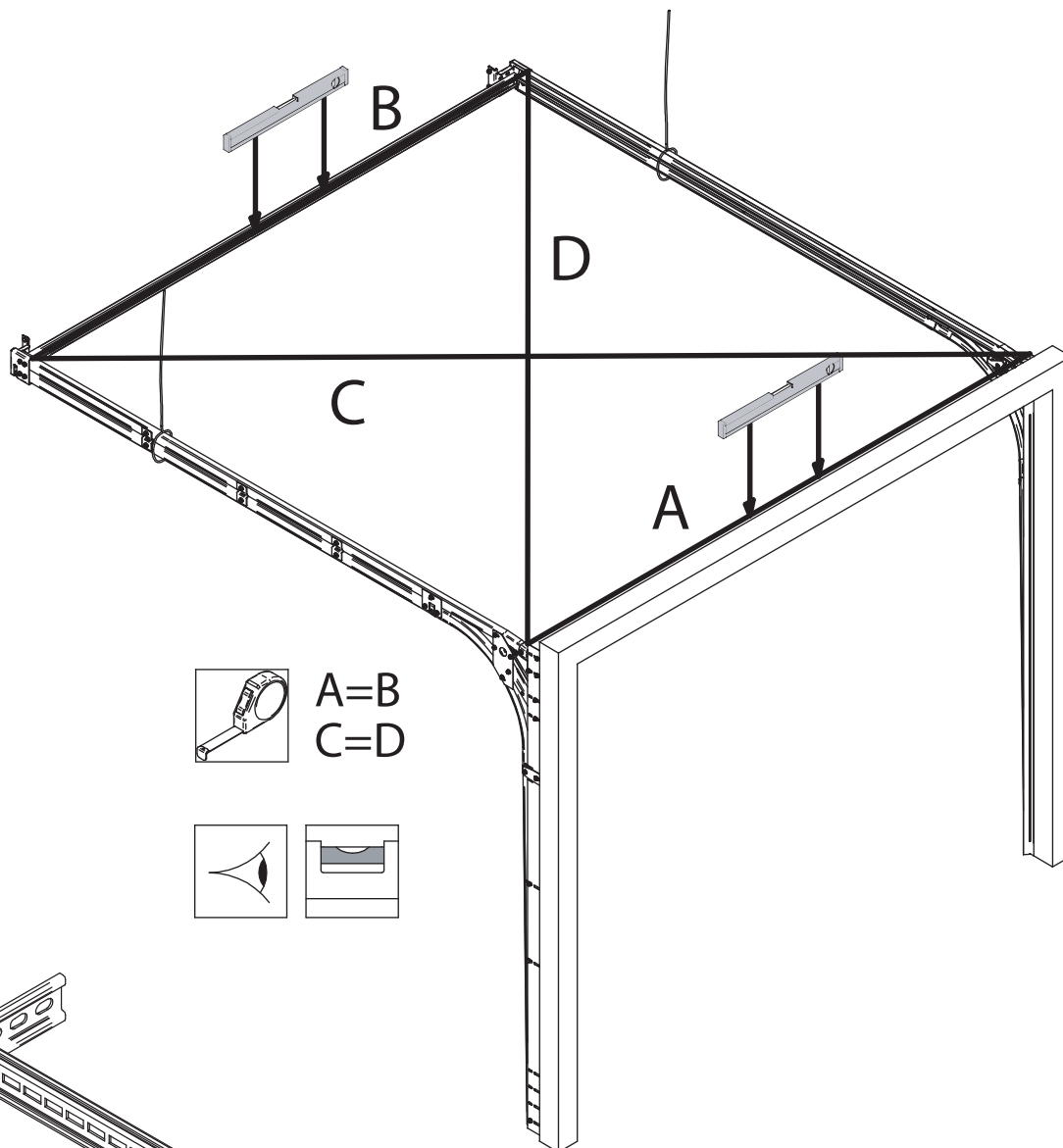

Using the L shape hangers and the clamping brackets secure the back bar to neighbouring walls

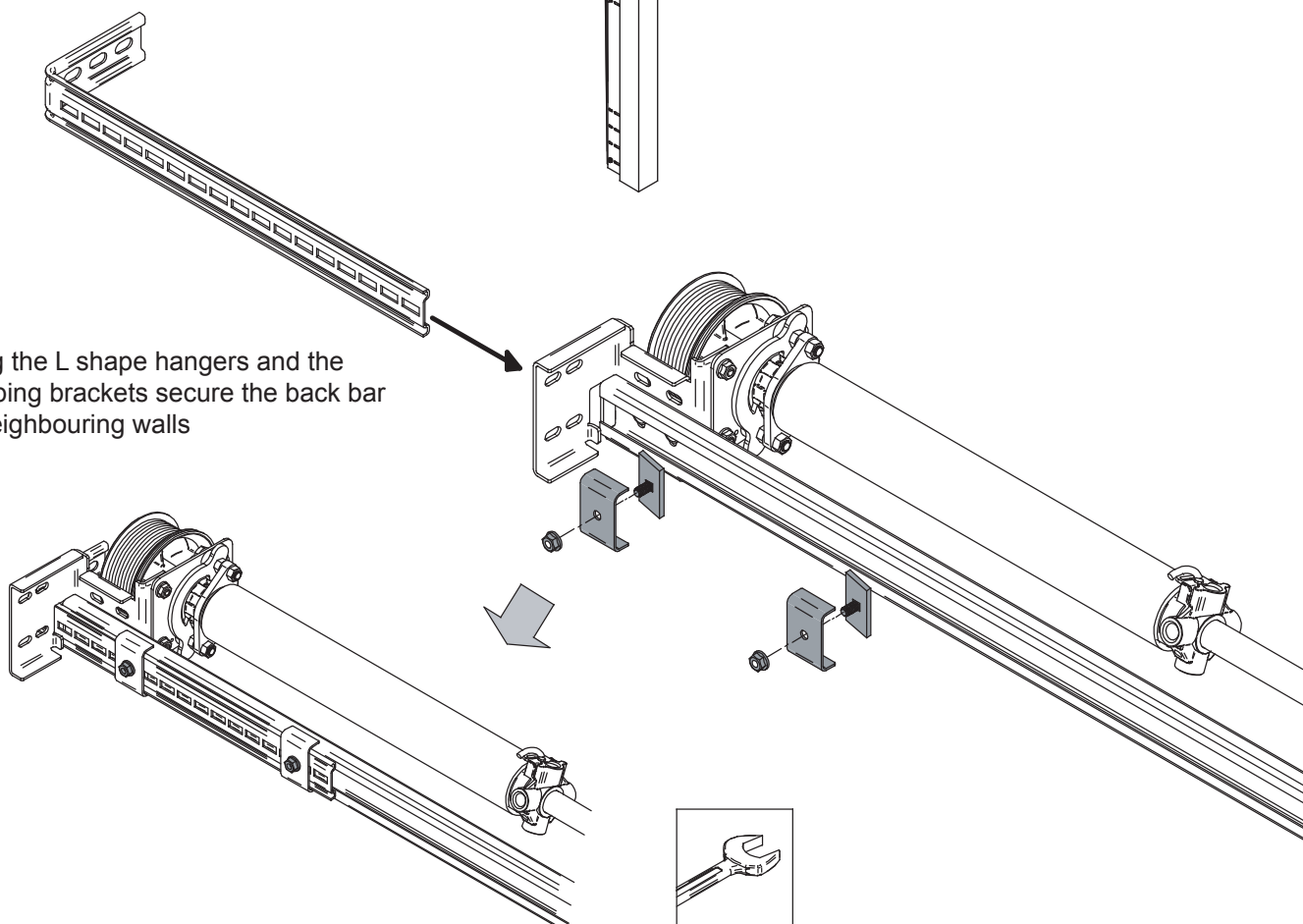

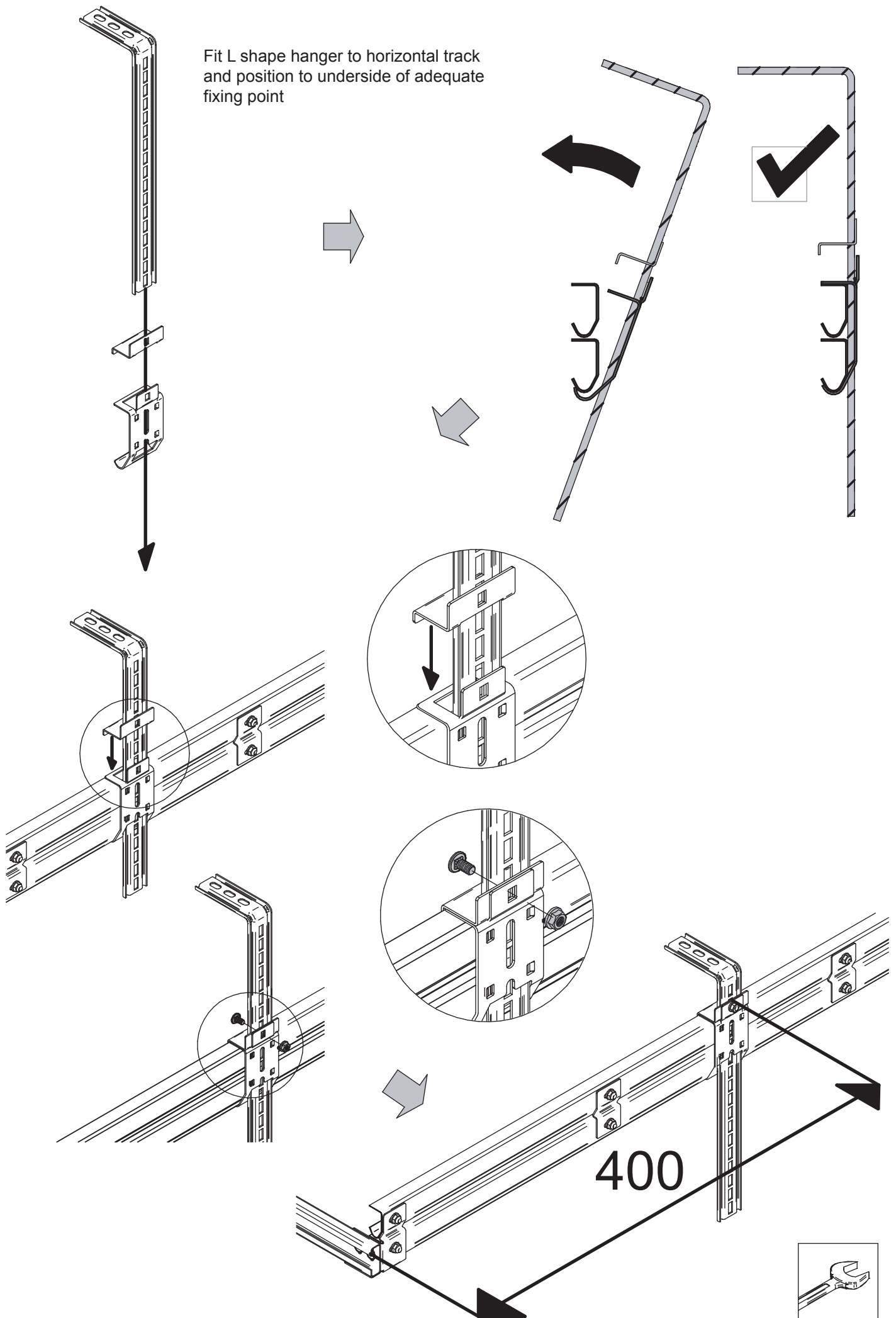

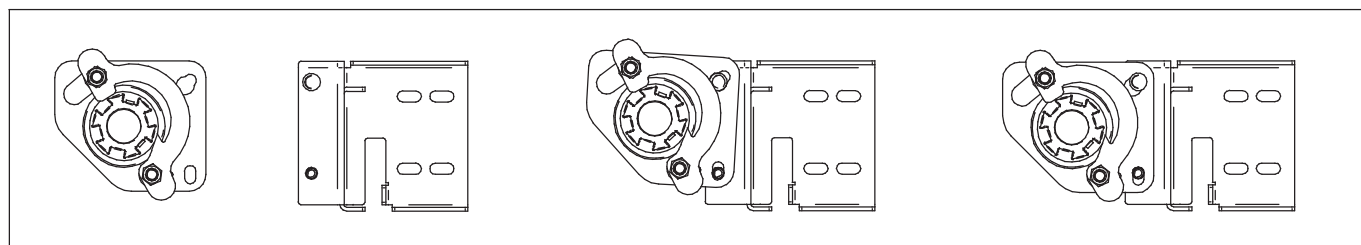
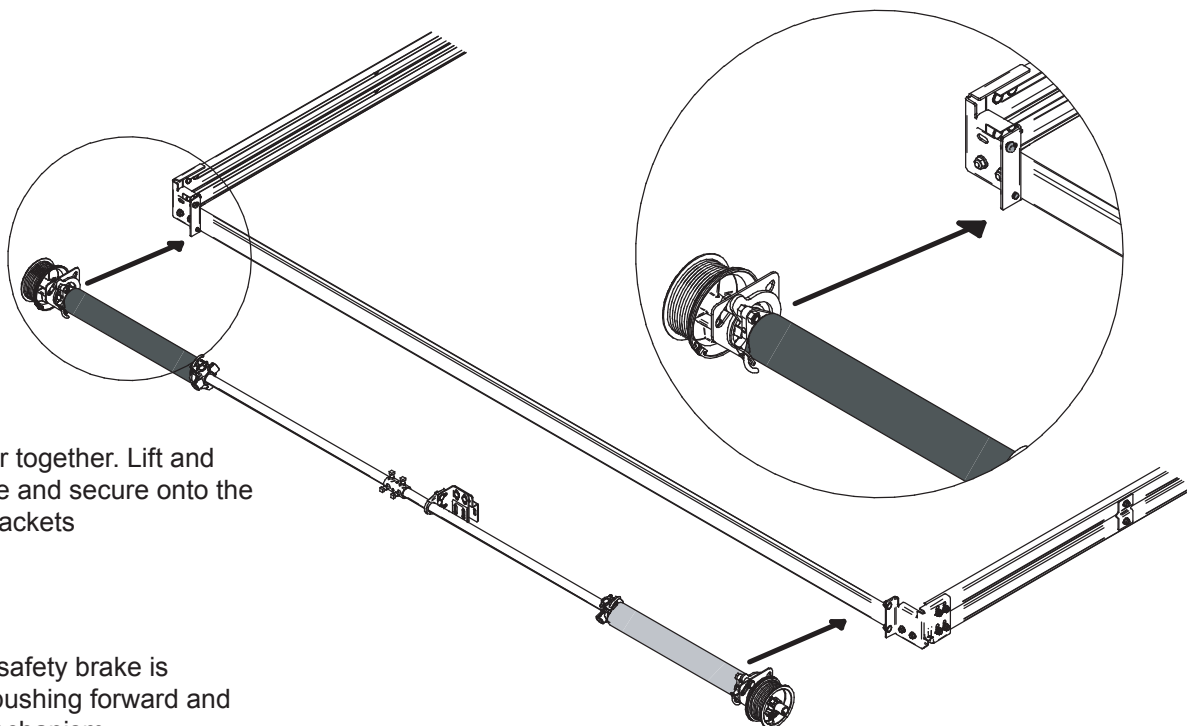

Secure spring assembly to back section using mounting parts shown

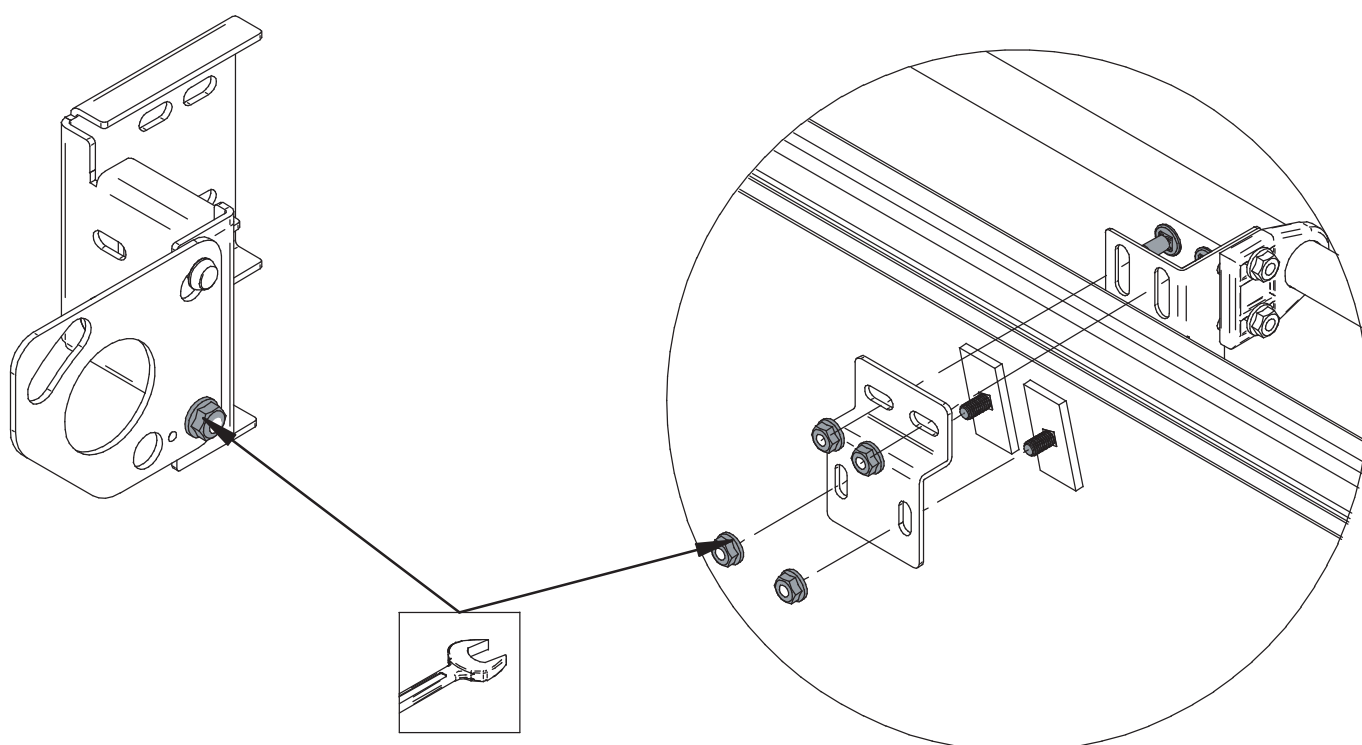

Fix bottom roller bracket

Connect the cables to the bottom roller bracket

Lift the bottom panel into the opening

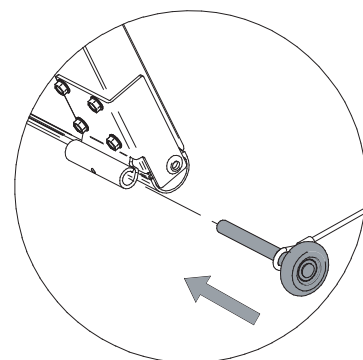
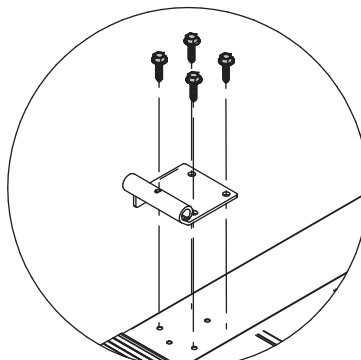

Fix the mid-roller to the top of the bottom panel

Prepare the sliding roller bracket with t-bolts and nuts

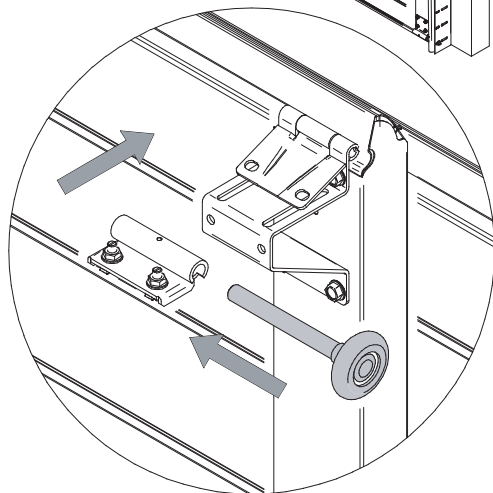
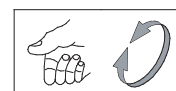
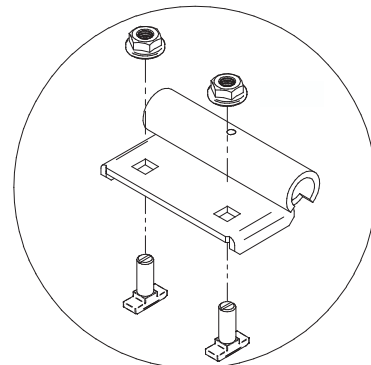
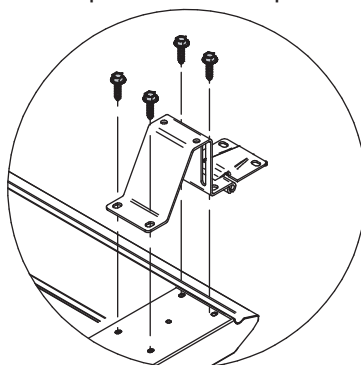

Insert the roller into the track and secure the sliding bracket

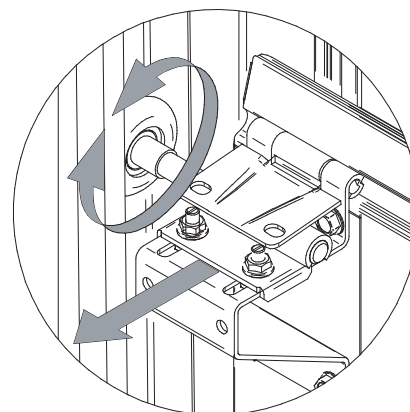

Ensure the panel is level before positioning second panel

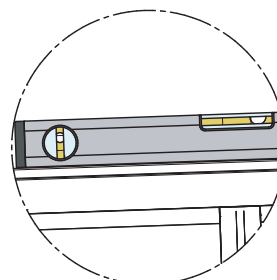
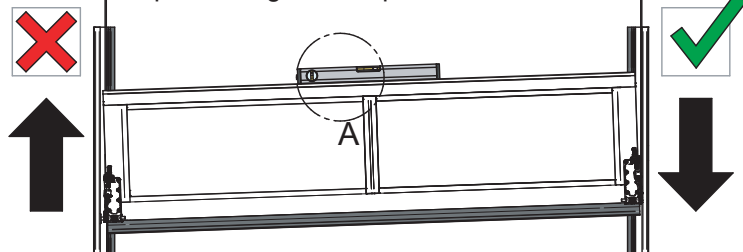

DETAIL A

Get ready to lift the second panel into the opening

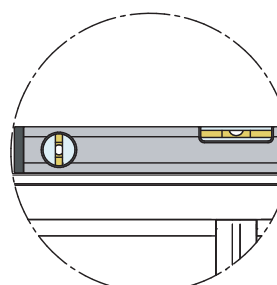
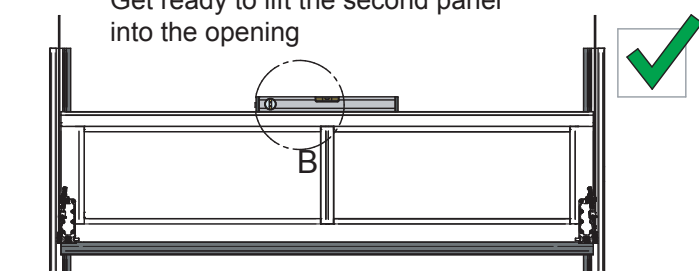

DETAIL B

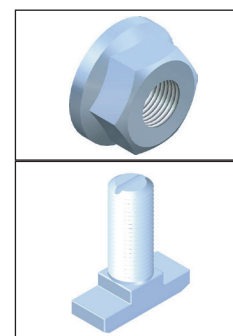

1

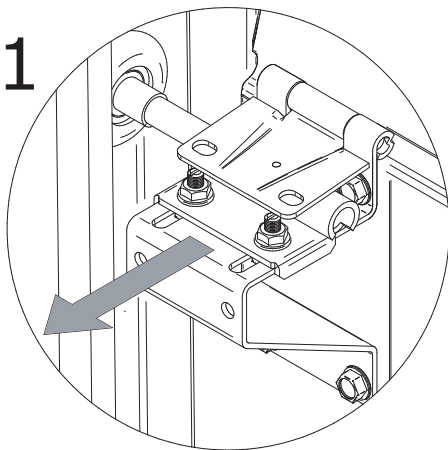

Lift the second panel into the opening and secure the brackets and roller as per panel one

2

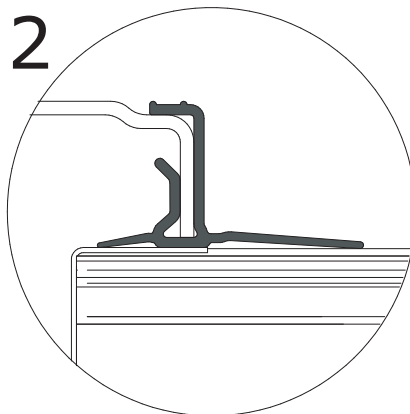

Check panels sit well with the weather seal on vertical tracks

3

Secure central hinges

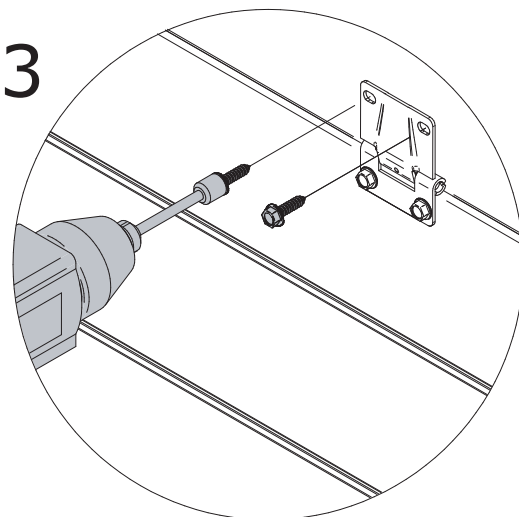

4

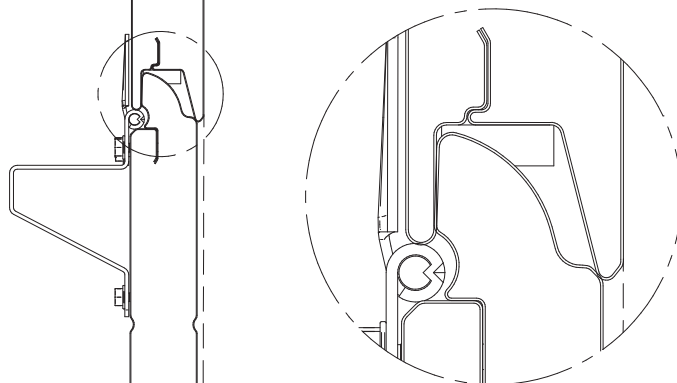
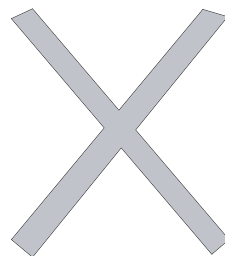
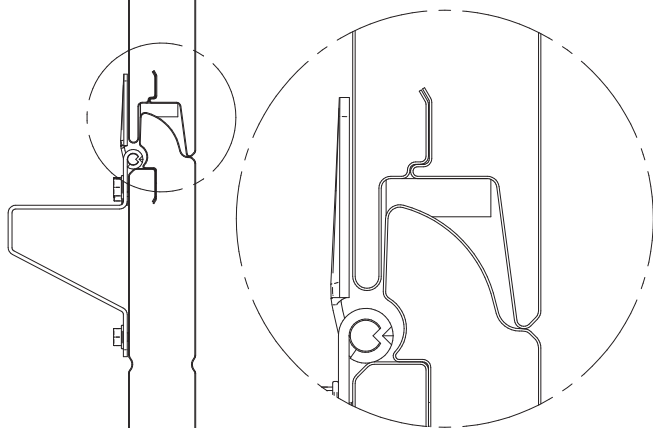
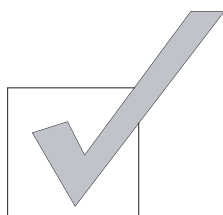

Add any remaining panels with the exception of the top panel

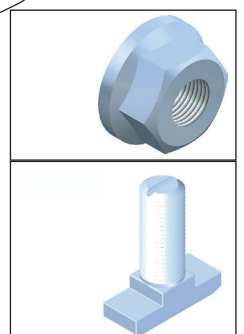
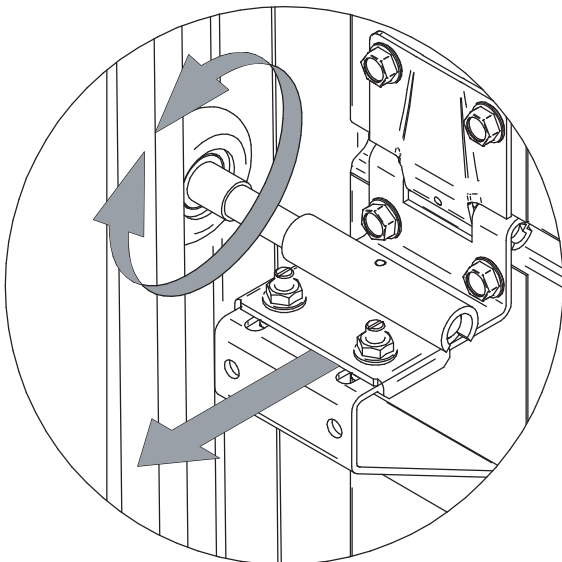
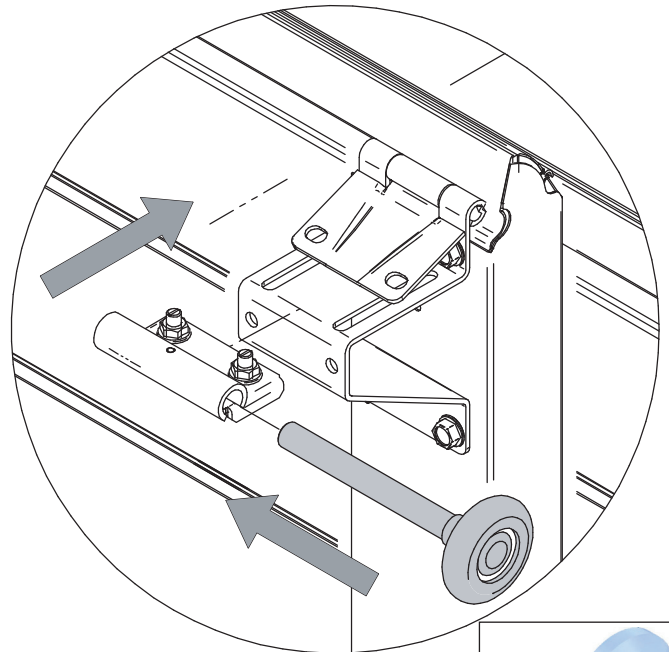
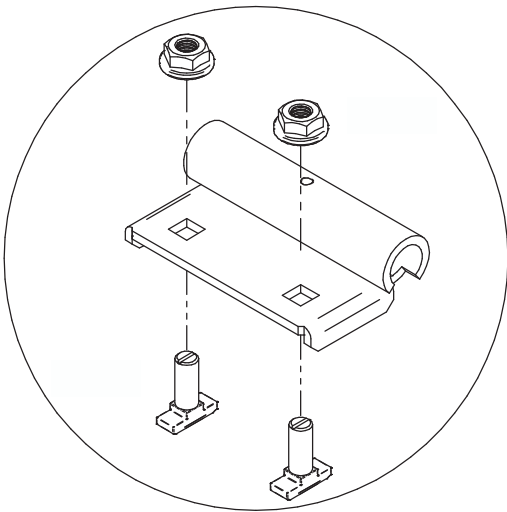
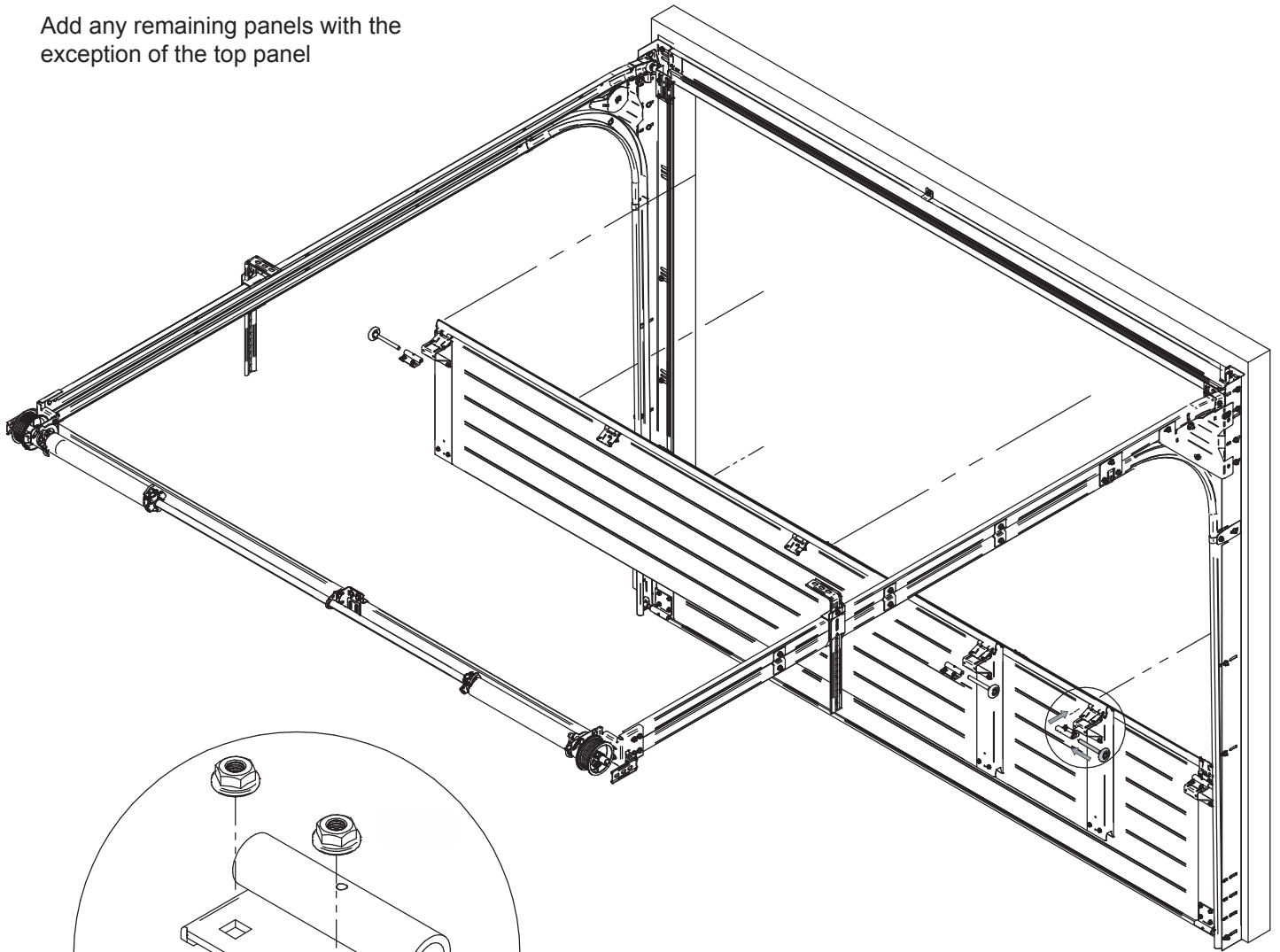

Lift top panel into opening

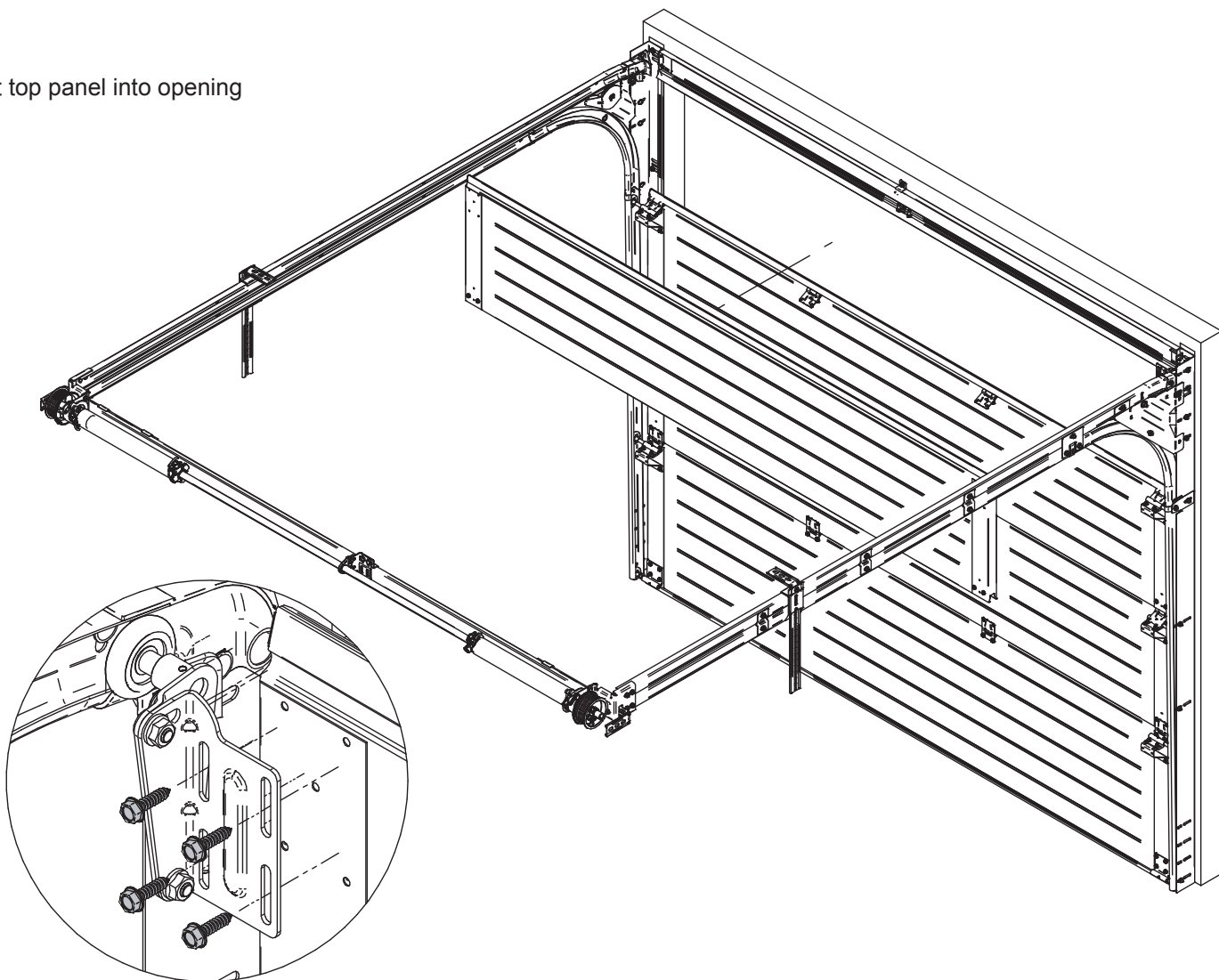

Secure the top roller brackets to the top panel

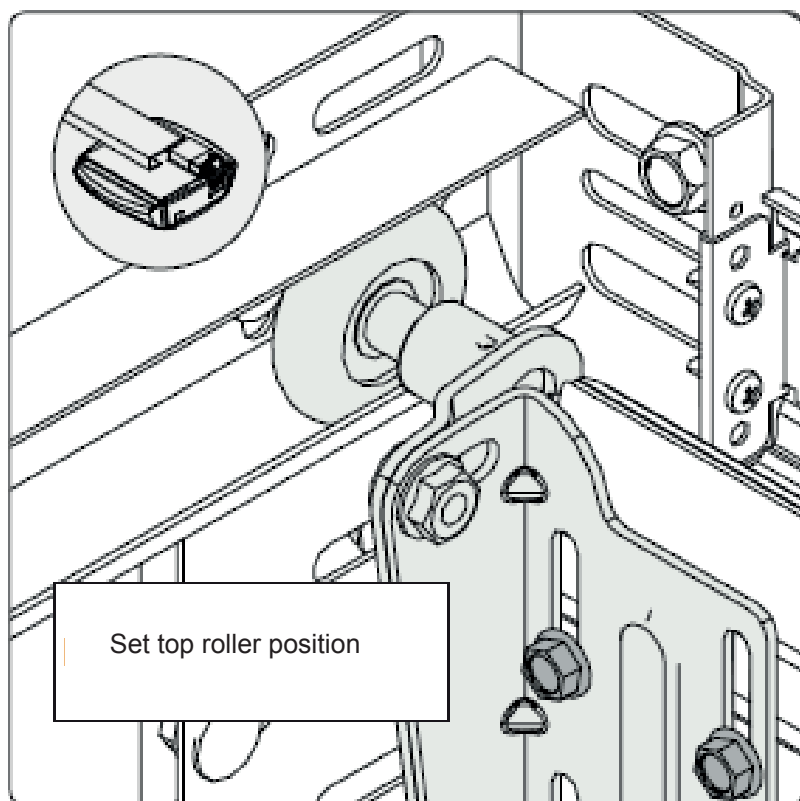

Ensure screws are tightened

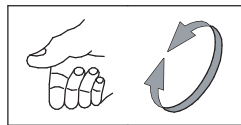
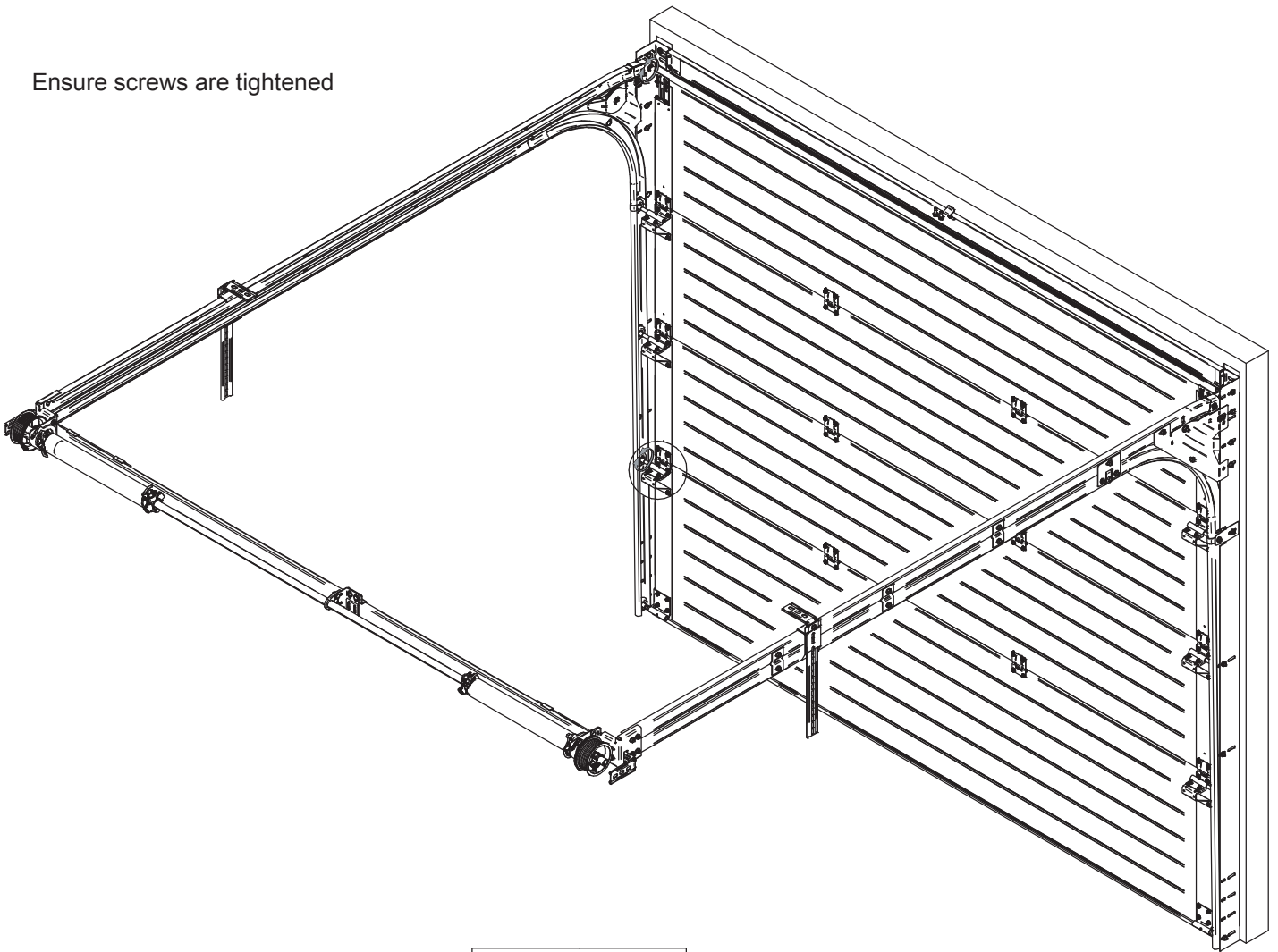

Ensure rollers are freely moving

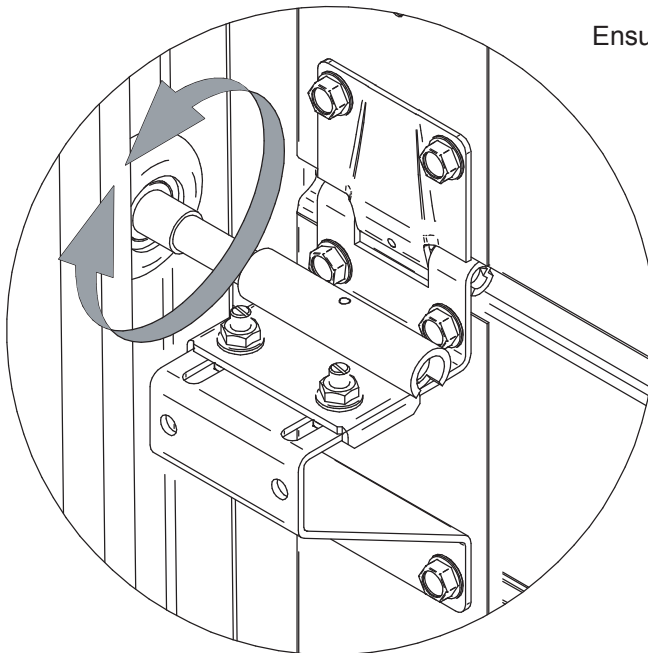

Before tensioning the door, clamp
the panels into the down position

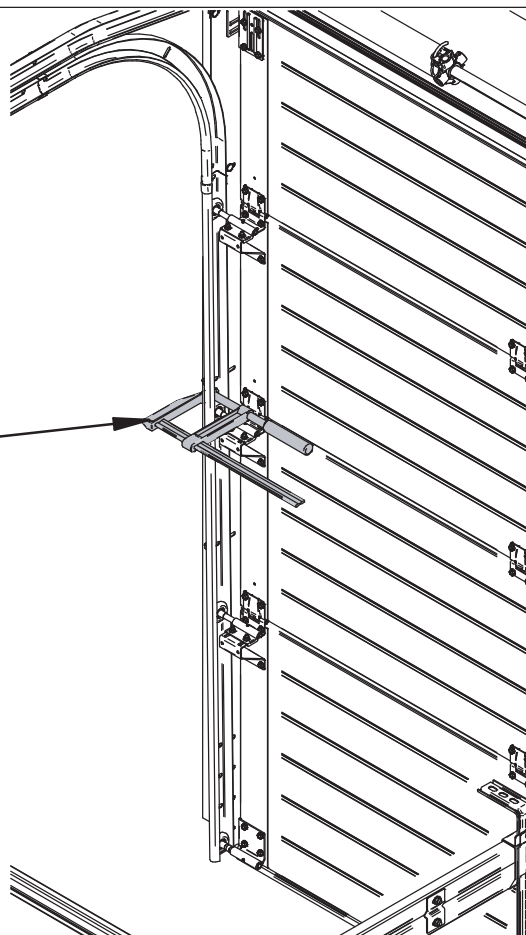
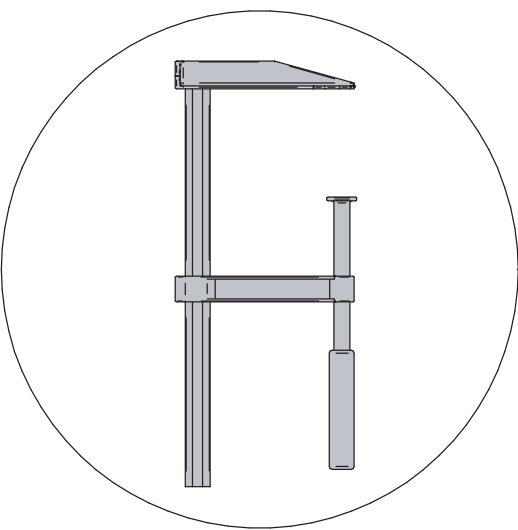

Ensure the cables are equally coiled around the drum

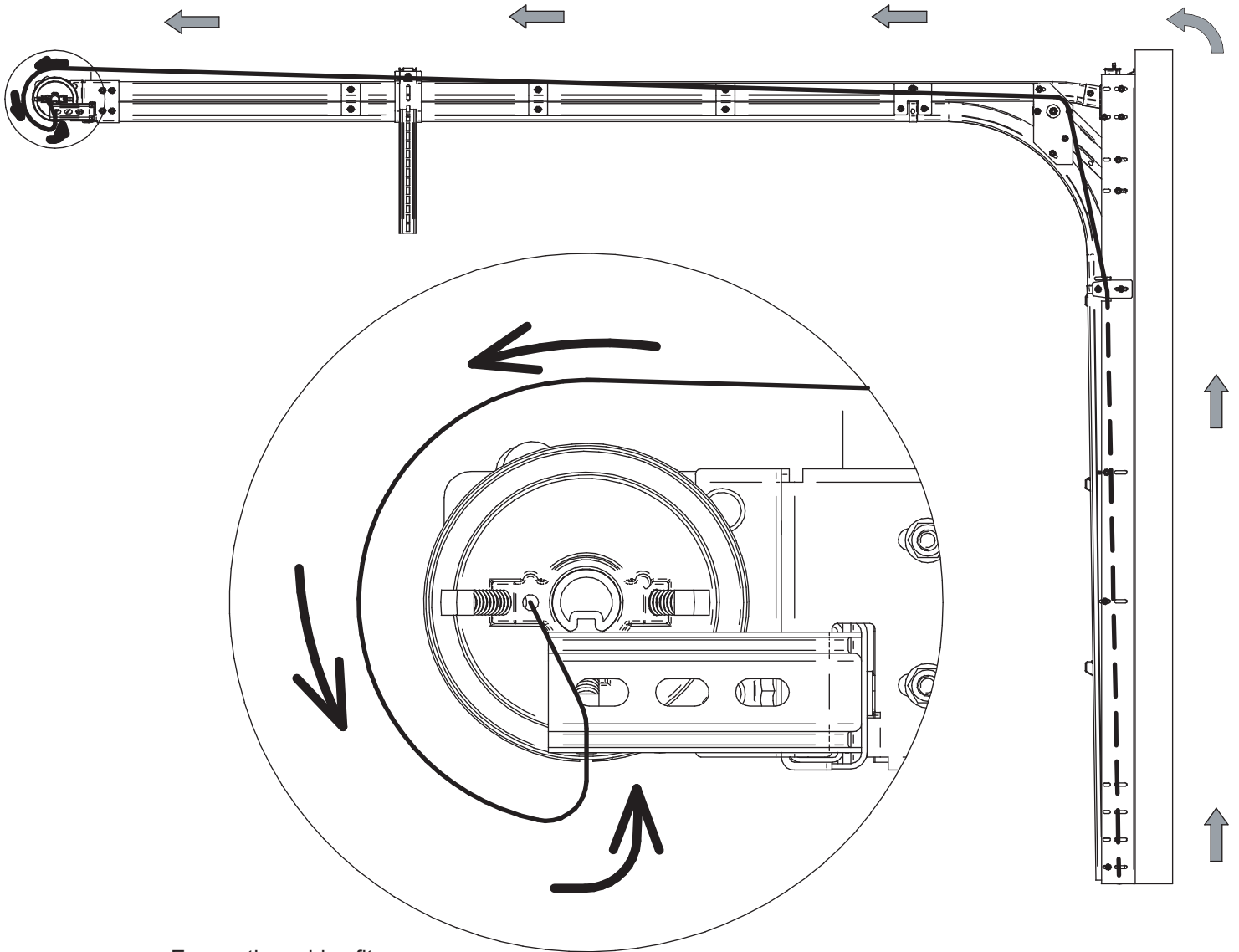

Ensure the cables fit neatly into the groove

When winding the cable onto the drum roller, please thread the cable from the rear of the drum and fasten off with the grub screw, allowing approx. 25mm of cable to protrude from the hole in the drum. Then wind the drum roller until the slack cable is around the drum, making sure you follow the grooves in the drum roller. Tensioning of the door can then begin as normal.

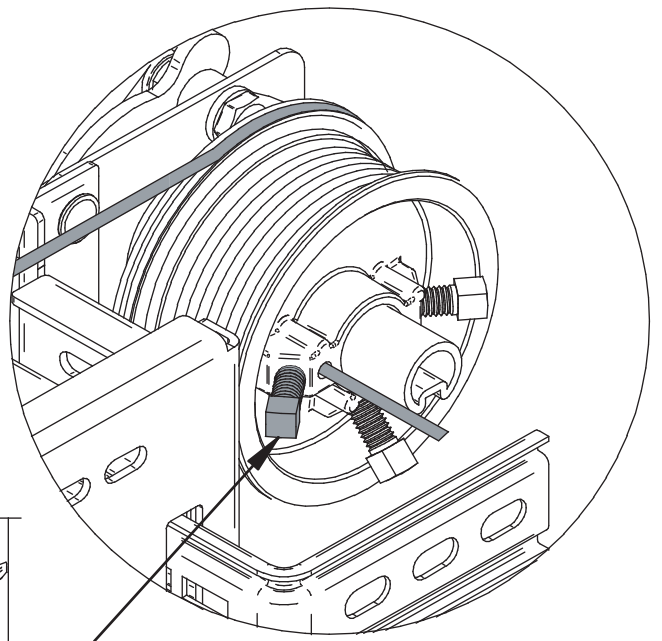
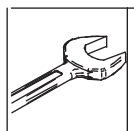
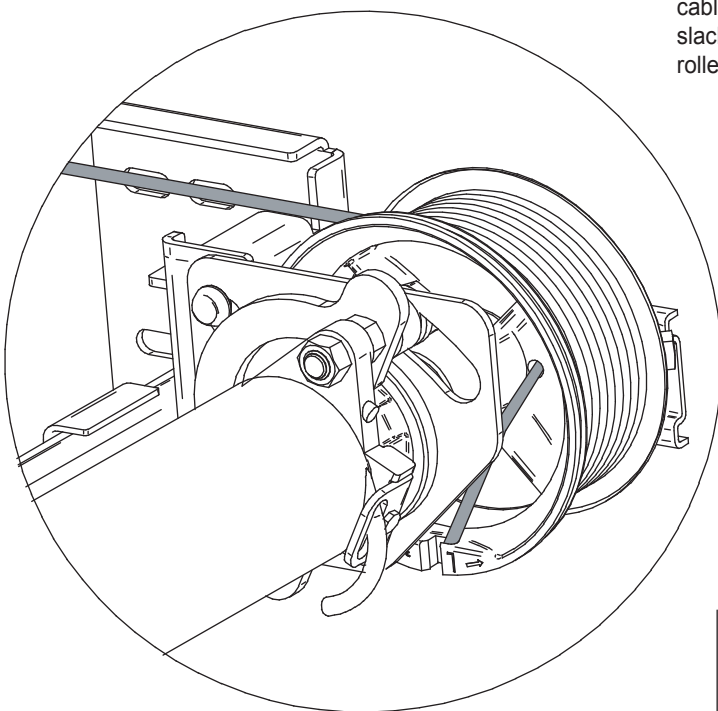

Check paperwork or spring tension label found on the spring for number of turns



SPRING < 152 mm



SPRING < 67 mm



STEEL 52

1

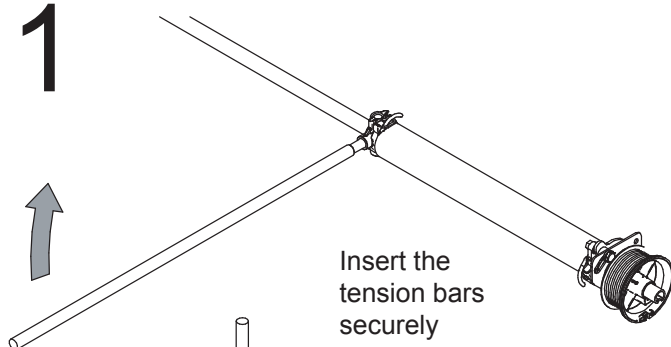

2

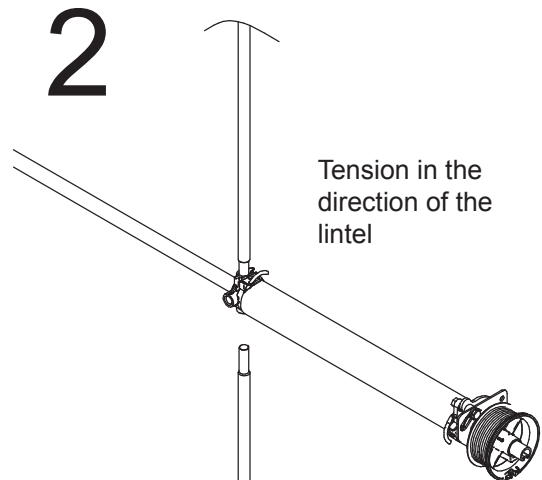

3

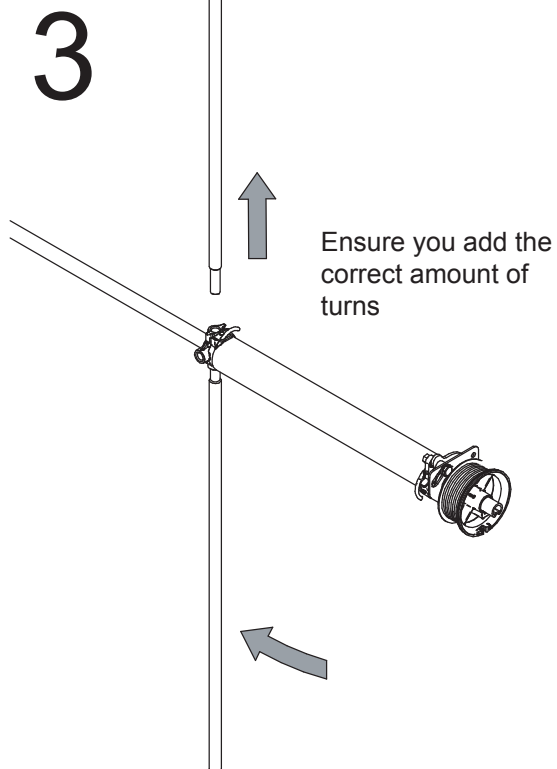

4

Once the tension is complete, ensure the spring is securely bolted

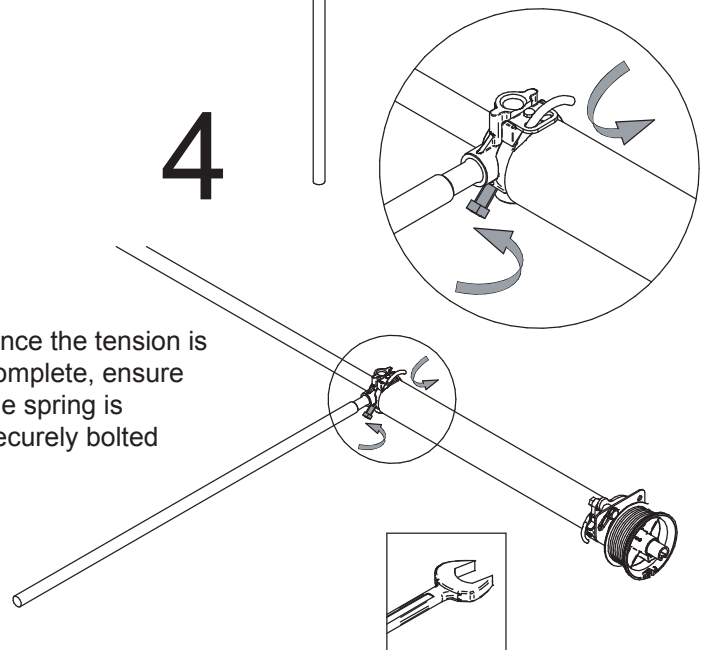

Correct fastening of winding plug

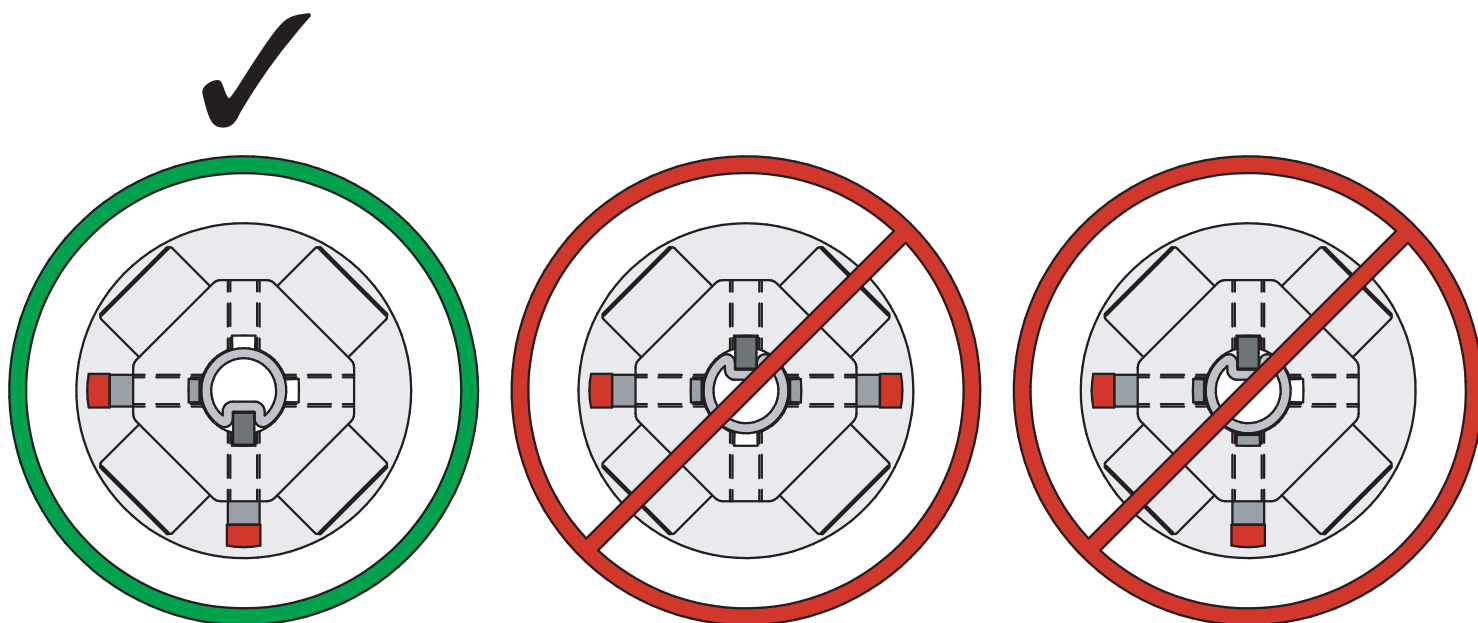

Ensure the locking bolts are pressing down on the key way

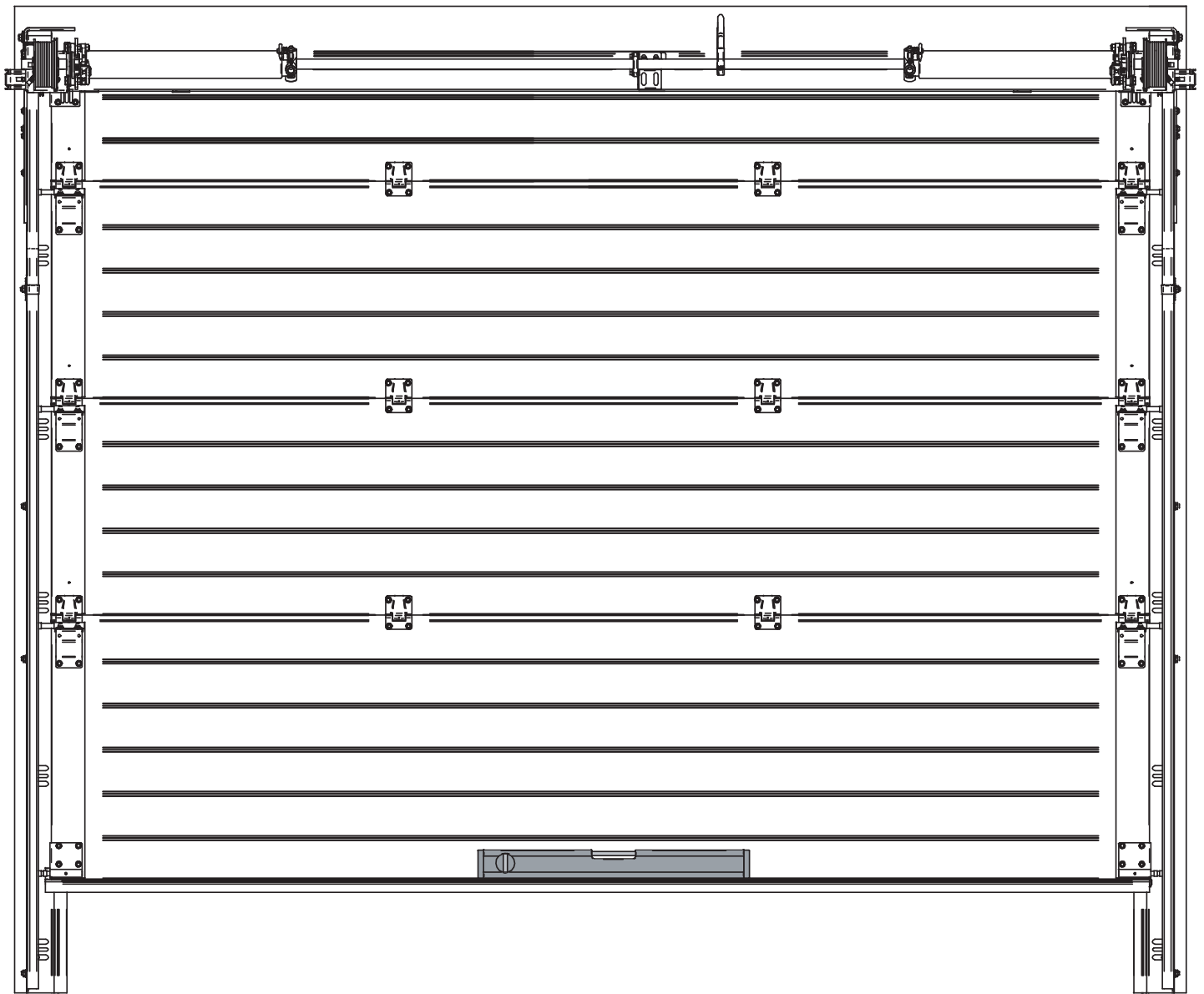

Once the tension is in place, check that the door is level. Check the balance and adjust if necessary

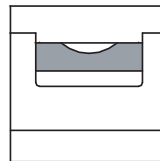

Reveal Options

Executive Framing Kit

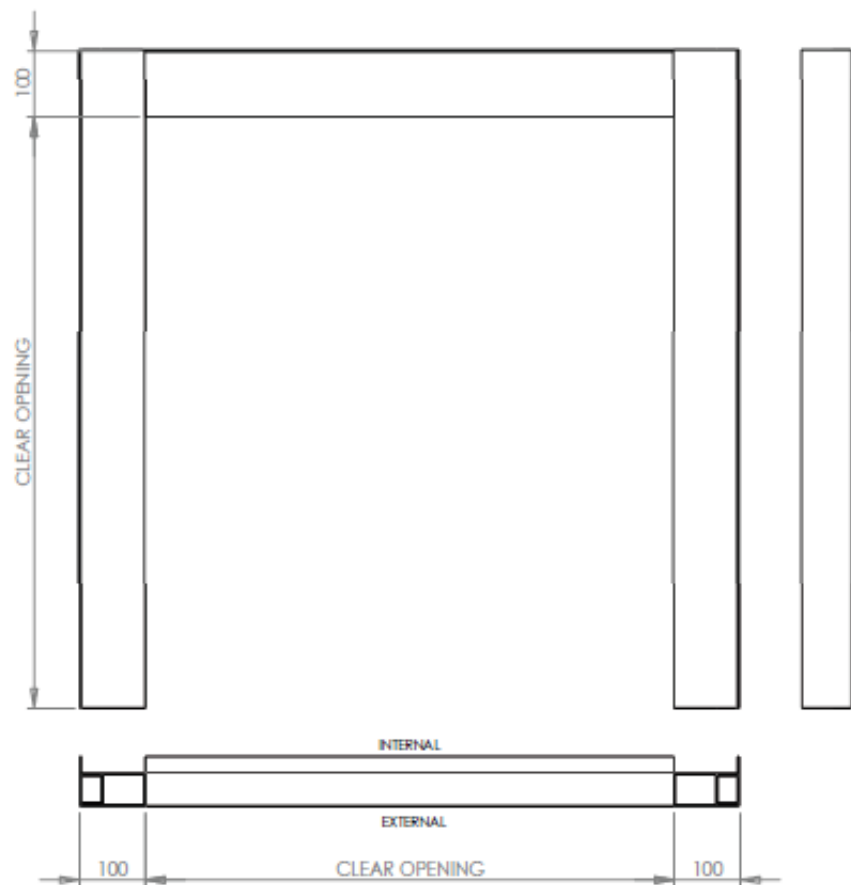
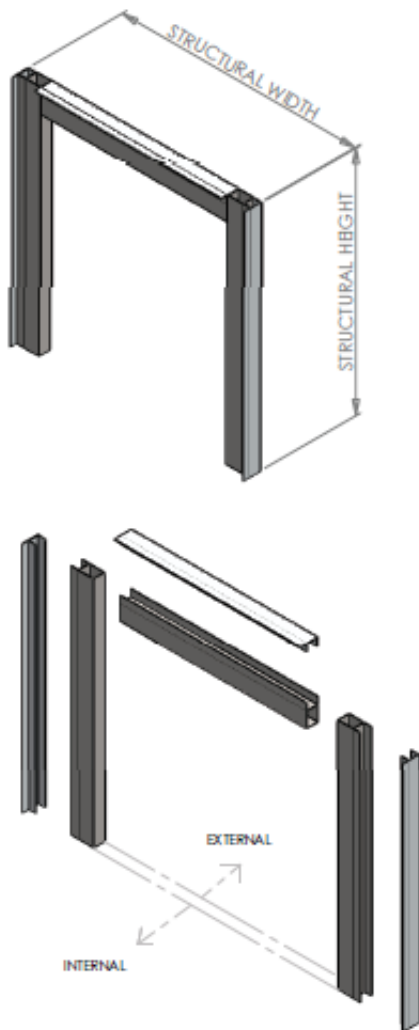

Reveal Brackets

Position 5 per side, secure each bracket with 2 M8 x 18 bolts and M8 serrated nuts

